

COOLCOX®

东莞市奇凌电子科技有限公司
COOLCOX LIMITED

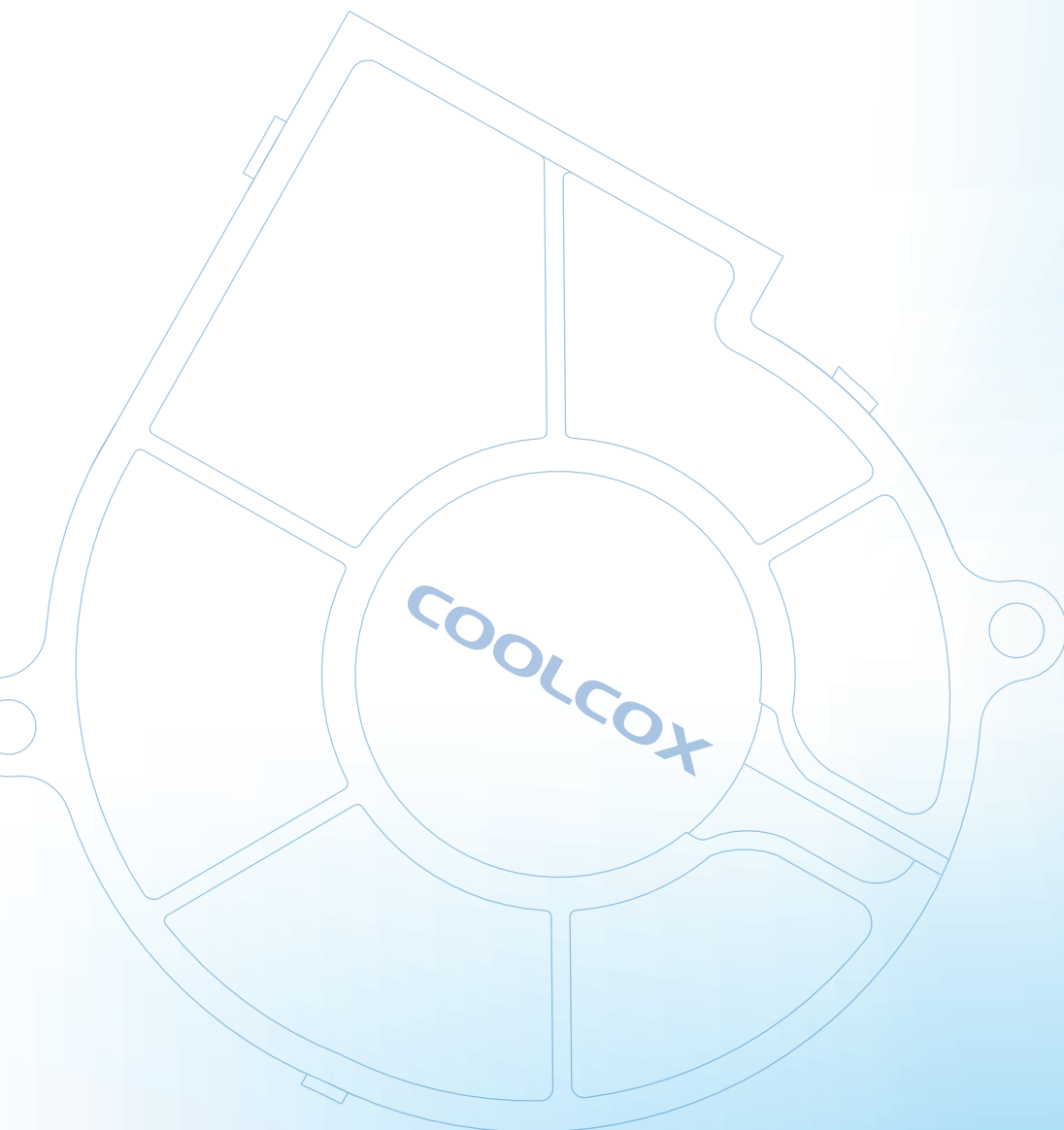

COMPANY PROFILE

CoolCox was founded in 2008 and dedicated to the research and production of cooling products. It is a high-tech enterprise with own brand and intellectual property rights.

The manufacturing factory was located in Dongguan city, with manufacturing area of 18,000 square meters and more than 700 employees. The company fully implements ISO9001, ISO14001, IATF16949, QC080000 management systems; and the products comply with safety regulations such as UL, TUV, CE, and CQC.

Our company has advanced automation equipment and first-class manufacturing capabilities, as well as a strict quality management system, continuously providing high-performance axial fans, blowers, coolers, motors and more to global customers, widely used in fields such as computers, network equipment, household appliances, medical equipment, security products, automation & control systems, 3D printers, projectors, new energy, etc.

We insist on technology & innovation and quality assurance, to achieve value growth for customers with comprehensive and efficient cooling products and solutions.



II Introductions (风扇介绍)

- All parts are in conformity with RoHS2.0 standard
风扇所有部件符合RoHS2.0标准
- Various bearings for option:Sleeve,Hydraulic,1-Ball & 1 Sleeve,2-Ball
含油，液压，单滚珠，双滚珠多种轴承可供选择
- Locked rotor protection and polarity protection is optional
可选择增加锁机保护和极性保护功能
- Frequency generator and rotation detector function are optional
可选择增加FG信号或RD信号功能 (FG信号输出风扇转速;RD信号可以监测风扇是否正常运转)

II Part Number Definition (产品型号命名规则)

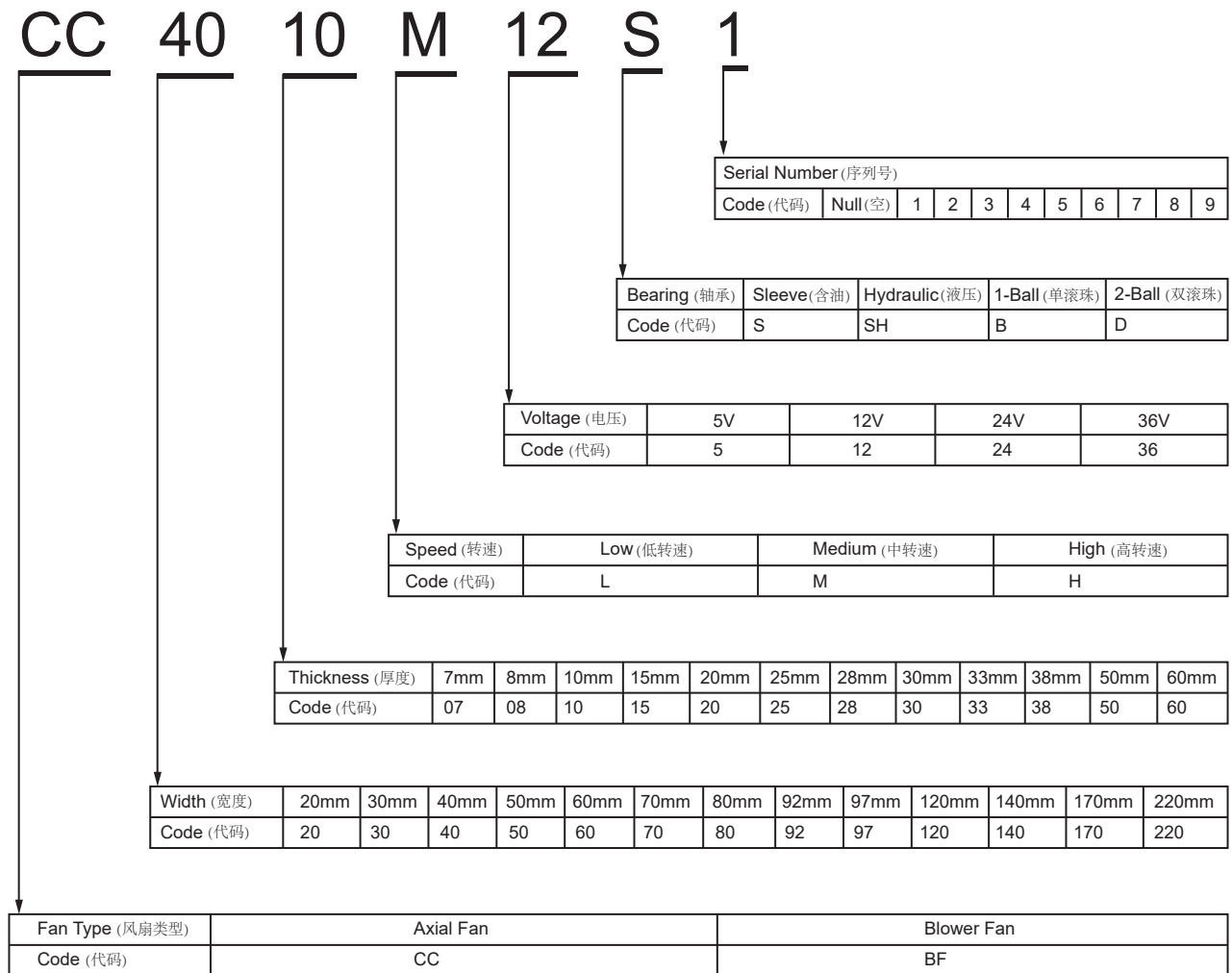

DC Blower Fan 20x20x8mm

■ 尺寸图 (DIMENSION DRAWING)

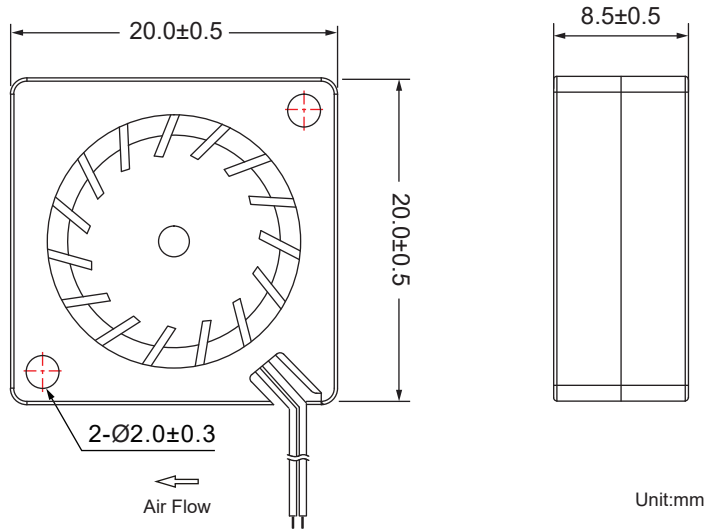

- * 轴承类型: 液压 (Bearing type: Hydraulic)
- * 材料 (Material):
扇叶 (Impeller): PBT
框 (Housing): PBT
- * 引线 (Lead wire):
UL1061 AWG #30 or equivalent
红色线正级 Red Wire Positive (+)
黑色线负级 Black Wire Negative (-)
- * 可选择增加风扇功能 (Functions are optional)
- * 重量 (Weight): 4g

■ 风压&风量曲线图 P and Q CURVE

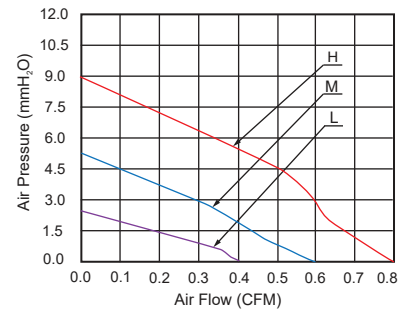

型号 Model	轴承类型 Bearing Type	电压 Rated Voltage	电压范围 Operation Voltage	电流 Current	功率 Input Power	转速 Speed	风量 Air Flow	风压 Static Pressure	噪音 Noise Level
		VDC	VDC	Amp	Watt	RPM	CFM	MM-H ₂ O	dBA
BF2008L03SH	Hydraulic	3.3V	3.0~3.6	0.04	0.132	9,000±15%	0.40	2.20	18.0
BF2008M03SH	Hydraulic	3.3V	3.0~3.6	0.09	0.297	13,000±15%	0.60	5.00	25.0
BF2008H03SH	Hydraulic	3.3V	3.0~3.6	0.18	0.594	18,000±15%	0.80	9.00	33.0
BF2008L05SH	Hydraulic	5V	4.5~5.5	0.03	0.15	9,000±15%	0.40	2.20	18.0
BF2008M05SH	Hydraulic	5V	4.5~5.5	0.07	0.35	13,000±15%	0.60	5.00	25.0
BF2008H05SH	Hydraulic	5V	4.5~5.5	0.12	0.60	18,000±15%	0.80	9.00	33.0

- * 以上为额定电压下的常规参数 (All readings are typical values at rated voltage)
- * 规格如有变动不另行通知 (Specifications are subjected to change without prior notice)

DC Blower Fan 25x25x12mm

■ 尺寸图 (DIMENSION DRAWING)

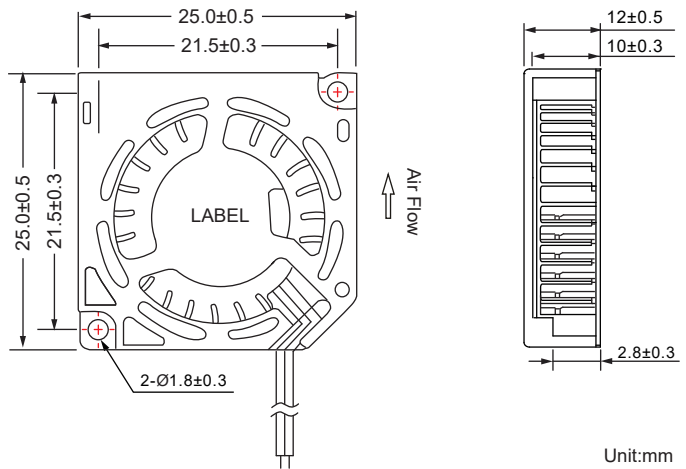

- * 轴承类型: 液压轴承 (Bearing type:Hydraulic)
- * 材料(Material): 框叶(Frame & Impeler):PBT
- * 引线(Lead wire): UL1061 AWG #30 or equivalent
红色线正级 Red Wire Positive (+)
黑色线负级 Black Wire Negative (-)
- * 可选择增加风扇功能(Functions are optional)
- * 重量(Weight):4.0g

■ 风压&风量曲线图 P and Q CURVE

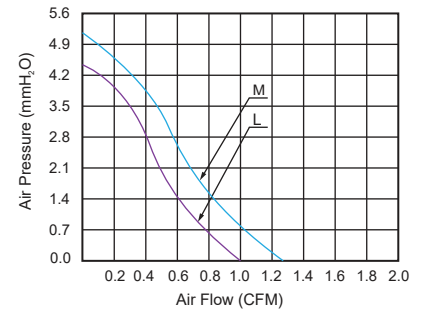

型号 Model	轴承类型 Bearing Type	电压 Rated Voltage	电压范围 Operation Voltage	电流 Current	功率 Input Power	转速 Speed	风量 Air Flow	风压 Static Pressure	噪音 Noise Level
		VDC	VDC	Amp	Watt	RPM	CFM	MM-H ₂ O	dBA
BF2512L05SH	Hydraulic	5V	4.5~5.5	0.05	0.25	8,000±15%	1.00	4.40	23.0
BF2512M05SH	Hydraulic	5V	4.5~5.5	0.10	0.50	10,000±15%	1.30	5.00	26.0

- * 以上为额定电压下的常规参数(All readings are typical values at rated voltage)
- * 规格如有变动不另行通知(Specifications are subjected to change without prior notice)

DC Blower Fan 30x30x07mm

■ 尺寸图 (DIMENSION DRAWING)

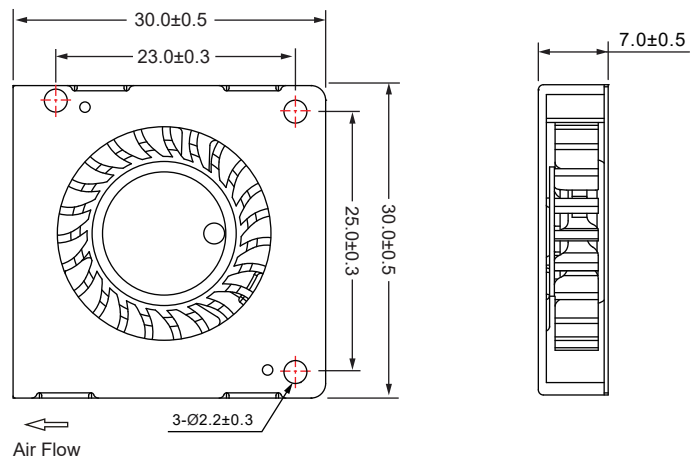

Unit:mm

■ 风压&风量曲线图 P and Q CURVE

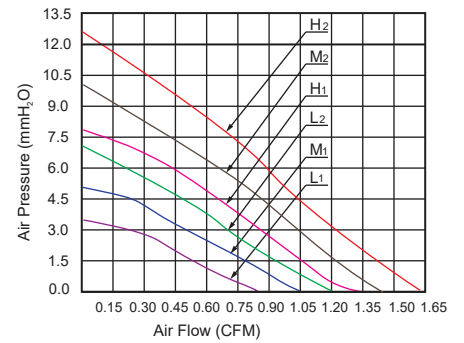

- * 轴承类型: 液压轴承
(Bearing type:Hydraulic)
- * 材料(Material):
扇叶(Impeller):PBT
框(Frame):PBT & Stainless Steel
- * 引线(Lead wire):
UL1061 AWG #28 or equivalent
红色线正级 Red Wire Positive (+)
黑色线负级 Black Wire Negative (-)
- * 可选择增加风扇功能(Functions are optional)
- * 重量(Weight):6.4g

型号 Model	轴承类型 Bearing Type	电压 Rated Voltage	电压范围 Operation Voltage	电流 Current	功率 Input Power	转速 Speed	风量 Air Flow	风压 Static Pressure	噪音 Noise Level
		VDC	VDC	Amp	Watt	RPM	CFM	MM-H ₂ O	dBA
BF3007L05SH	Hydraulic	5V	4.5~5.5	0.10	0.50	5,500±10%	0.80	3.30	18.0
BF3007M05SH	Hydraulic	5V	4.5~5.5	0.11	0.55	7,000±10%	1.05	5.30	22.7
BF3007H05SH	Hydraulic	5V	4.5~5.5	0.15	0.75	8,500±10%	1.30	7.70	27.7
BF3007L12SH	Hydraulic	12V	10.8~13.2	0.04	0.48	8,000±10%	1.20	7.00	26.3
BF3007M12SH	Hydraulic	12V	10.8~13.2	0.08	0.96	9,500±10%	1.50	9.80	30.7
BF3007H12SH	Hydraulic	12V	10.8~13.2	0.12	1.44	11,000±10%	1.60	12.50	33.7

- * 以上为额定电压下的常规参数(All readings are typical values at rated voltage)
- * 规格如有变动不另行通知(Specifications are subjected to change without prior notice)

DC Blower Fan 30x30x10mm

■ 尺寸图 (DIMENSION DRAWING)

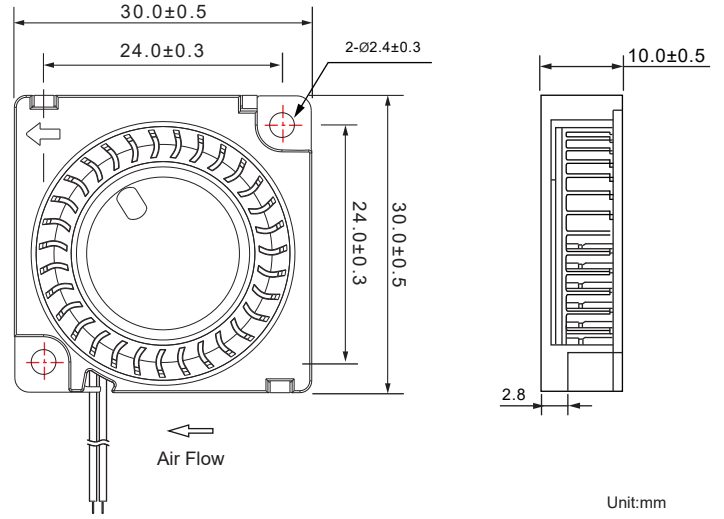

- * 轴承类型: 含油轴承, 双滚珠轴承 (Bearing type:Sleeve,2-Ball)
- * 材料(Material):
框叶(Frame & Impeller):PBT
- * 引线(Lead wire):
UL1571 AWG #28 or equivalent
红色线正级 Red Wire Positive (+)
黑色线负级 Black Wire Negative (-)
- * 可选择增加风扇功能(Functions are optional)
- * 重量(Weight):8.3g

■ 风压&风量曲线图 P and Q CURVE

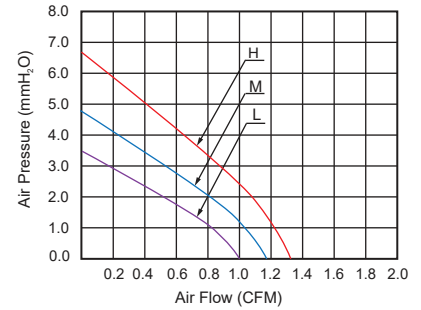

型号 Model	轴承类型 Bearing Type	版本 Version	电压 Rated Voltage	电流 Current	功率 Input Power	转速 Speed	风量 Air Flow	风压 Static Pressure	噪音 Noise Level
			VDC	Amp	Watt	RPM	CFM	MM-H ₂ O	dBA
BF3010L05S	Sleeve	-A	5V	0.06	0.30	6,500±10%	1.00	3.30	24.0
BF3010L05D	2-Ball								
BF3010M05S	Sleeve	-A	5V	0.11	0.55	7,500±10%	1.15	4.90	28.0
BF3010M05D	2-Ball								
BF3010H05S	Sleeve	-A	5V	0.15	0.75	8,500±10%	1.30	6.60	32.3
BF3010H05D	2-Ball								
BF3010L12S	Sleeve	-A	12V	0.03	0.36	6,500±10%	1.00	3.30	24.0
BF3010L12D	2-Ball								
BF3010M12S	Sleeve	-A	12V	0.06	0.72	7,500±10%	1.15	4.90	28.0
BF3010M12D	2-Ball								
BF3010H12S	Sleeve	-A	12V	0.08	0.96	8,500±10%	1.30	6.60	32.3
BF3010H12D	2-Ball								

- * 以上为额定电压下的常规参数(All readings are typical values at rated voltage)
- * 规格如有变动不另行通知(Specifications are subjected to change without prior notice)

DC Blower Fan 30x30x10mm

■ 尺寸图 (DIMENSION DRAWING)

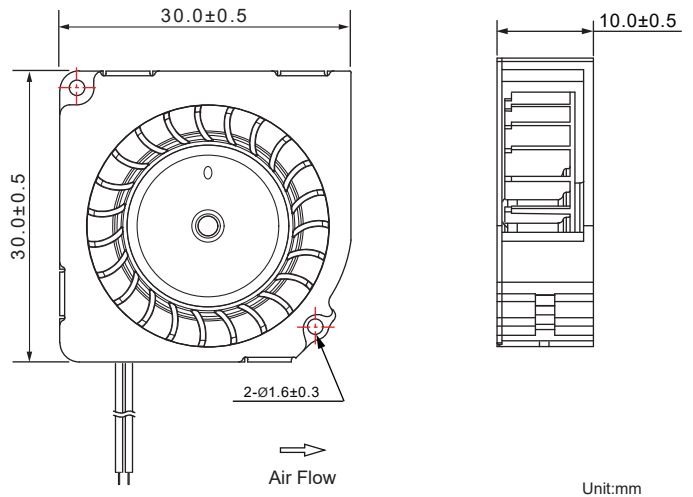

- * 轴承类型: 液压轴承 (Bearing type: Hydraulic)
- * 材料 (Material):
扇叶 (Impeller): PBT
框 (Frame): PBT & Stainless Steel
- * 引线 (Lead wire):
UL1571 AWG #28 or equivalent
红色线正级 Red Wire Positive (+)
黑色线负级 Black Wire Negative (-)
- * 可选择增加风扇功能 (Functions are optional)
- * 重量 (Weight): 9.4g

■ 风压&风量曲线图 P and Q CURVE

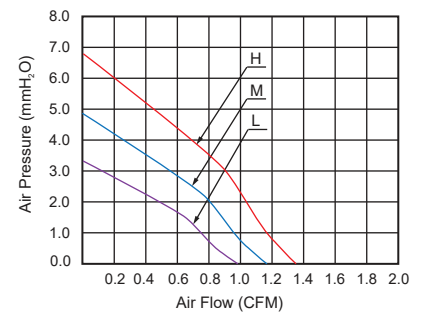

型号 Model	轴承类型 Bearing Type	版本 Version	电压 Rated Voltage	电流 Current	功率 Input Power	转速 Speed	风量 Air Flow	风压 Static Pressure	噪音 Noise Level
			VDC	Amp	Watt	RPM	CFM	MM-H ₂ O	dBA
BF3010L05SH	Hydraulic	-B	5V	0.06	0.30	6,500±10%	0.94	3.25	24.0
BF3010M05SH	Hydraulic	-B	5V	0.07	0.35	7,500±10%	1.18	4.90	28.0
BF3010H05SH	Hydraulic	-B	5V	0.08	0.40	8,500±10%	1.35	6.70	31.0
BF3010L12SH	Hydraulic	-B	12V	0.03	0.36	6,500±10%	0.94	3.25	24.0
BF3010M12SH	Hydraulic	-B	12V	0.05	0.60	7,500±10%	1.18	4.90	28.0
BF3010H12SH	Hydraulic	-B	12V	0.07	0.84	8,500±10%	1.35	6.70	31.0

- * 以上为额定电压下的常规参数 (All readings are typical values at rated voltage)
- * 规格如有变动不另行通知 (Specifications are subjected to change without prior notice)

DC Blower Fan 30x30x15mm

■ 尺寸图 (DIMENSION DRAWING)

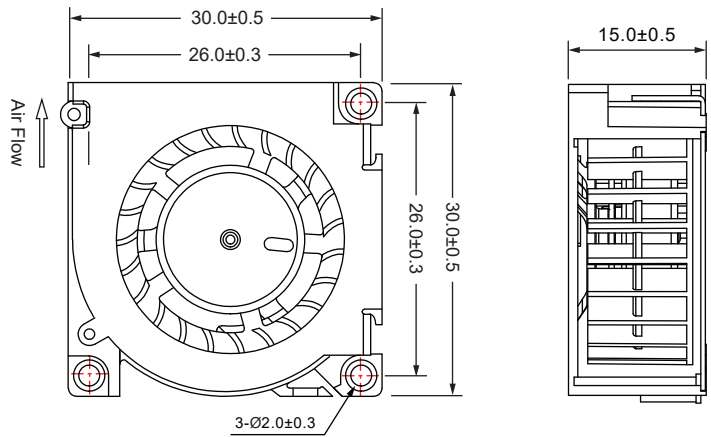

Unit:mm

- * 轴承类型: 液压轴承 (Bearing type: Hydraulic)
- * 材料 (Material):
扇叶 (Impeller): PBT
框 (Frame): PBT & Stainless Steel
- * 引线 (Lead wire):
UL1061 AWG #28 or equivalent
红色线正级 Red Wire Positive (+)
黑色线负级 Black Wire Negative (-)
- * 可选择增加风扇功能 (Functions are optional)
- * 重量 (Weight): 8.8g

■ 风压&风量曲线图 P and Q CURVE

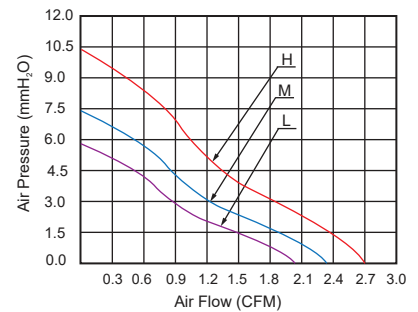

型号 Model	轴承类型 Bearing Type	电压 Rated Voltage	电压范围 Operation Voltage	电流 Current	功率 Input Power	转速 Speed	风量 Air Flow	风压 Static Pressure	噪音 Noise Level
		VDC	VDC	Amp	Watt	RPM	CFM	MM-H ₂ O	dBA
BF3015L05SH	Hydraulic	5V	4.5~5.5	0.06	0.30	5,500±10%	2.00	5.10	25.0
BF3015M05SH	Hydraulic	5V	4.5~5.5	0.08	0.40	6,500±10%	2.30	7.50	28.0
BF3015H05SH	Hydraulic	5V	4.5~5.5	0.21	1.05	7,500±10%	2.70	10.0	31.0
BF3015L12SH	Hydraulic	12V	10.8~13.2	0.05	0.60	5,500±10%	2.00	5.10	25.0
BF3015M12SH	Hydraulic	12V	10.8~13.2	0.08	0.96	6,500±10%	2.30	7.50	28.0
BF301512SH	Hydraulic	12V	10.8~13.2	0.09	1.08	7,500±10%	2.70	10.0	31.0

- * 以上为额定电压下的常规参数 (All readings are typical values at rated voltage)
- * 规格如有变动不另行通知 (Specifications are subjected to change without prior notice)

DC Blower Fan 35x35x10mm

■ 尺寸图 (DIMENSION DRAWING)

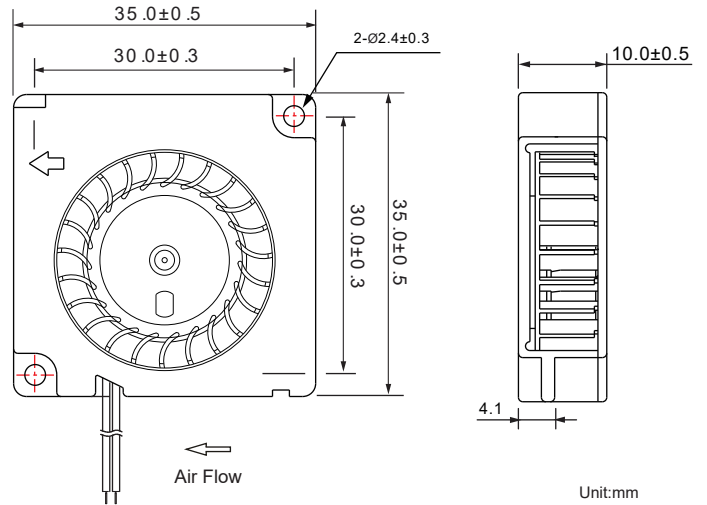

- * 轴承类型: 含油轴承, 双滚珠轴承 (Bearing type:Sleeve,2-Ball)
- * 材料(Material):
框叶(Frame & Impeler):PBT
- * 引线(Lead wire):
UL1571 AWG #28 or equivalent
红色线正级 Red Wire Positive (+)
黑色线负级 Black Wire Negative (-)
- * 可选择增加风扇功能(Functions are optional)
- * 重量(Weight):10g

■ 风压&风量曲线图 P and Q CURVE

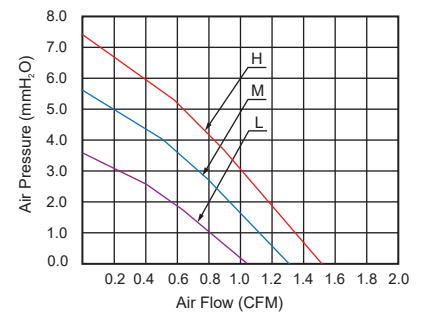

型号 Model	轴承类型 Bearing Type	电压 Rated Voltage	电压范围 Operation Voltage	电流 Current	功率 Input Power	转速 Speed	风量 Air Flow	风压 Static Pressure	噪音 Noise Level
		VDC	VDC	Amp	Watt	RPM	CFM	MM-H ₂ O	dBA
BF3510L05S	Sleeve	5V	4.5~5.5	0.08	0.40	6,500±10%	1.05	3.50	20.0
BF3510L05D	2-Ball								
BF3510M05S	Sleeve	5V	4.5~5.5	0.11	0.55	7,500±10%	1.30	5.30	24.0
BF3510M05D	2-Ball								
BF3510H05S	Sleeve	5V	4.5~5.5	0.15	0.75	8,500±10%	1.50	7.30	28.0
BF3510H05D	2-Ball								
BF3510L12S	Sleeve	12V	10.8~13.2	0.05	0.60	6,500±10%	1.05	3.50	20.0
BF3510L12D	2-Ball								
BF3510M12S	Sleeve	12V	10.8~13.2	0.06	0.72	7,500±10%	1.30	5.30	24.0
BF3510M12D	2-Ball								
BF3510H12S	Sleeve	12V	10.8~13.2	0.08	0.96	8,500±10%	1.50	7.30	28.0
BF3510H12D	2-Ball								

- * 以上为额定电压下的常规参数(All readings are typical values at rated voltage)
- * 规格如有变动不另行通知(Specifications are subjected to change without prior notice)

DC Blower Fan 40x40x7mm

■ 尺寸图 (DIMENSION DRAWING)

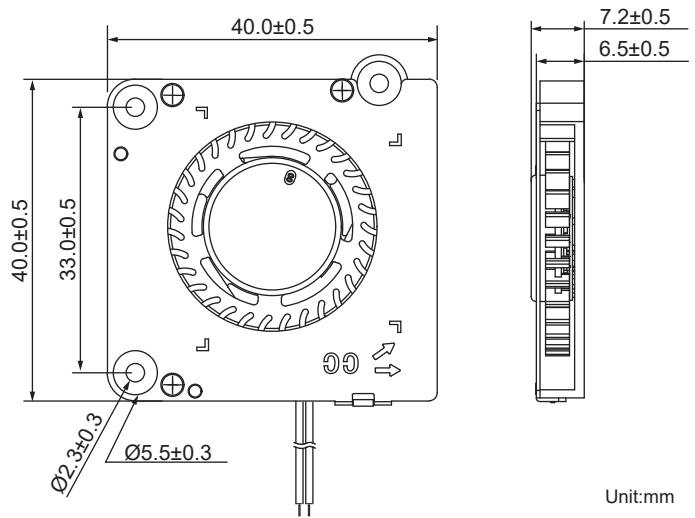

- * 轴承类型: 液压轴承, 流体动压 (Bearing type: Hydraulic, FDB)
- * 材料 (Material):
扇叶 (Impeller): PBT
框 (Frame): PBT & Stainless steel
- * 引线 (Lead wire):
UL1061 AWG #28 or equivalent
红色线正级 Red Wire Positive (+)
黑色线负级 Black Wire Negative (-)
- * 可选择增加风扇功能 (Functions are optional)
- * 重量 (Weight): 14g

■ 风压&风量曲线图 P and Q CURVE

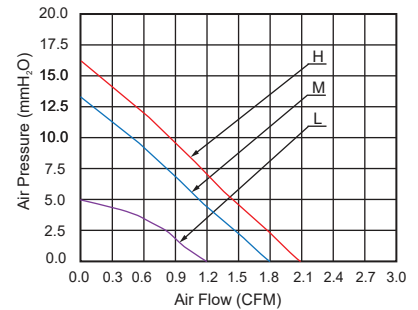

型号 Model	轴承类型 Bearing Type	版本 Version	电压 Rated Voltage	电流 Current	功率 Input Power	转速 Speed	风量 Air Flow	风压 Static Pressure	噪音 Noise Level
			VDC	Amp	Watt	RPM	CFM	MM-H ₂ O	dBA
BF4007L05SH	Hydraulic	-A	5V	0.12	0.60	5,000±10%	1.20	5.00	24.0
BF4007L05S3	FDB								
BF4007M05SH	Hydraulic	-A	5V	0.20	1.00	6,000±10%	1.70	13.2	29.5
BF4007M05S3	FDB								
BF4007H05SH	Hydraulic	-A	5V	0.35	1.75	7,000±10%	2.00	16.2	32.0
BF4007H05S3	FDB								
BF4007L12SH	Hydraulic	-A	12V	0.06	0.72	5,000±10%	1.20	5.00	21.1
BF4007L12S3	FDB								
BF4007M12SH	Hydraulic	-A	12V	0.10	1.20	6,000±10%	1.70	13.2	29.5
BF4007M12S3	FDB								
BF4007H12SH	Hydraulic	-A	12V	0.15	1.80	7,000±10%	2.00	16.2	32.0
BF4007H12S3	FDB								

- * 以上为额定电压下的常规参数 (All readings are typical values at rated voltage)
- * 规格如有变动不另行通知 (Specifications are subjected to change without prior notice)

DC Blower Fan 40x40x10mm

■ 尺寸图 (DIMENSION DRAWING)

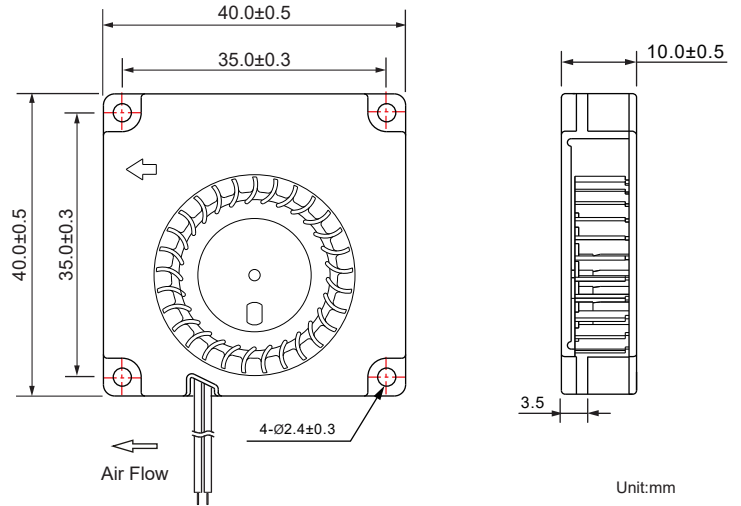

- * 轴承类型: 双滚珠, 液压, 流体动压 (Bearing type: 2-Ball, Hydraulic, FDB)
- * 材料(Material):
框叶(Frame & Impeller): PBT
- * 引线(Lead wire):
UL1571 AWG #28 or equivalent
红色线正级 Red Wire Positive (+)
黑色线负级 Black Wire Negative (-)
- * 可选择增加风扇功能(Functions are optional)
- * 重量(Weight): 11.5g

■ 风压&风量曲线图 P and Q CURVE

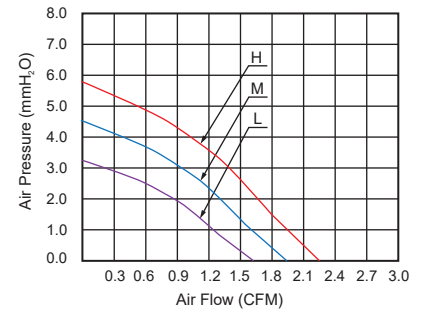

型号 Model	轴承类型 Bearing Type	版本 Version	电压 Rated Voltage	电流 Current	功率 Input Power	转速 Speed	风量 Air Flow	风压 Static Pressure	噪音 Noise Level
			VDC	Amp	Watt	RPM	CFM	MM-H ₂ O	dBA
BF4010L05D	2-Ball	-A	5V	0.07	0.35	5,500±10%	1.60	3.10	24.0
BF4010L05SH	Hydraulic								
BF4010L05S3	FDB								
BF4010M05D	2-Ball	-A	5V	0.10	0.50	6,500±10%	1.92	4.50	27.0
BF4010M05SH	Hydraulic								
BF4010M05S3	FDB								
BF4010H05D	2-Ball	-A	5V	0.14	0.70	7,500±10%	2.20	5.70	30.0
BF4010H5SH	Hydraulic								
BF4010H05S3	FDB								
BF4010L12D	2-Ball	-A	12V	0.03	0.36	5,500±10%	1.60	3.10	24.0
BF4010L12SH	Hydraulic								
BF4010L12S3	FDB								
BF4010M12D	2-Ball	-A	12V	0.05	0.60	6,500±10%	1.92	4.50	27.0
BF4010M12SH	Hydraulic								
BF4010M12S3	FDB								
BF4010H12D	2-Ball	-A	12V	0.06	0.72	7,500±10%	2.20	5.70	30.0
BF4010H12SH	Hydraulic								
BF4010H12S3	FDB								

- * 以上为额定电压下的常规参数(All readings are typical values at rated voltage)
- * 规格如有变动不另行通知(Specifications are subjected to change without prior notice)

DC Blower Fan 41x53x10.5mm

■ 尺寸图 (DIMENSION DRAWING)

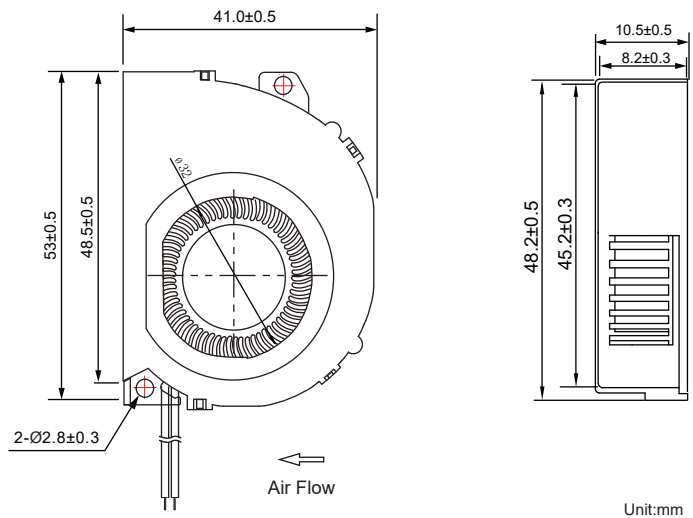

Unit:mm

■ 风压&风量曲线图 P and Q CURVE

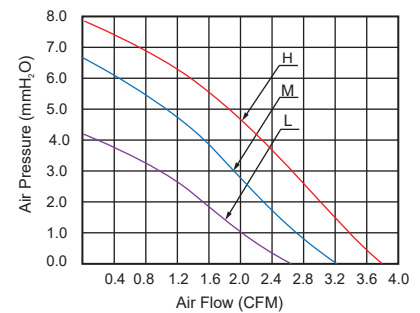

- * 轴承类型: 含油轴承, 双滚珠轴承 (Bearing type:Sleeve,2-Ball)
- * 材料(Material):
框叶(Frame & Impeler):PBT
- * 引线(Lead wire):
UL1571 AWG #28 or equivalent
红色线正级 Red Wire Positive (+)
黑色线负级 Black Wire Negative (-)
- * 可选择增加风扇功能(Functions are optional)
- * 重量(Weight):12g

型号 Model	轴承类型 Bearing Type	版本 Version	电压 Rated Voltage	电流 Current	功率 Input Power	转速 Speed	风量 Air Flow	风压 Static Pressure	噪音 Noise Level
			VDC	Amp	Watt	RPM	CFM	MM-H ₂ O	dBA
BF4010L05S	Sleeve	-B	5V	0.16	0.80	4,000±10%	2.60	4.10	25.8
BF4010L05D	2-Ball								
BF4010M05S	Sleeve	-B	5V	0.20	1.00	5,000±10%	3.20	6.50	30.2
BF4010M05D	2-Ball								
BF4010H05S	Sleeve	-B	5V	0.24	1.20	6,000±10%	3.80	7.90	33.0
BF4010H05D	2-Ball								
BF4010L12S	Sleeve	-B	12V	0.04	0.48	4,000±10%	2.60	4.10	25.8
BF4010L12D	2-Ball								
BF4010M12S	Sleeve	-B	12V	0.07	0.84	5,000±10%	3.20	6.50	30.2
BF4010M12D	2-Ball								
BF4010H12S	Sleeve	-B	12V	0.12	1.44	6,000±10%	3.80	7.90	33.0
BF4010H12D	2-Ball								

- * 以上为额定电压下的常规参数(All readings are typical values at rated voltage)
- * 规格如有变动不另行通知(Specifications are subjected to change without prior notice)

DC Blower Fan 40x40x15mm

■ 尺寸图 (DIMENSION DRAWING)

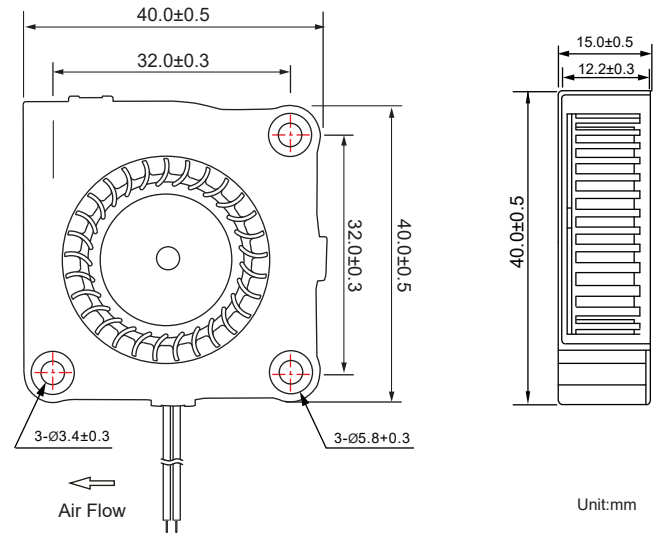
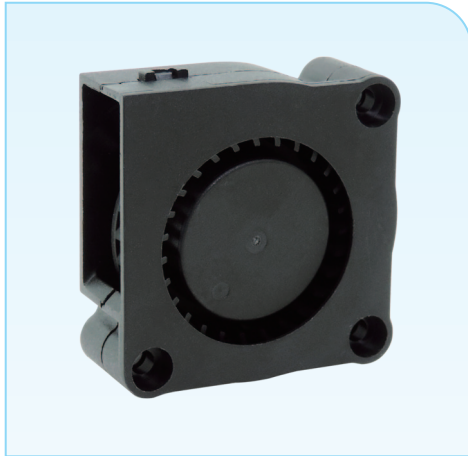

- * 轴承类型: 含油轴承, 双滚珠轴承 (Bearing type:Sleeve,2-Ball)
- * 材料(Material):
框叶(Frame & Impeler):PBT
- * 引线(Lead wire):
UL1571 AWG #28 or equivalent
红色线正级 Red Wire Positive (+)
黑色线负级 Black Wire Negative (-)
- * 可选择增加风扇功能(Functions are optional)
- * 重量(Weight):12g

■ 风压&风量曲线图 P and Q CURVE

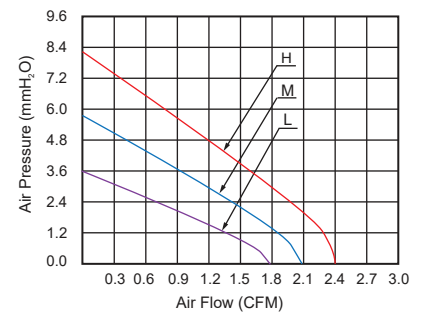

型号 Model	轴承类型 Bearing Type	电压 Rated Voltage	电压范围 Operation Voltage	电流 Current	功率 Input Power	转速 Speed	风量 Air Flow	风压 Static Pressure	噪音 Noise Level
		VDC	VDC	Amp	Watt	RPM	CFM	MM-H ₂ O	dBA
BF4015L05S	Sleeve	5V	4.5~5.5	0.08	0.40	5,000±10%	1.70	3.60	27.0
BF4015L05D	2-Ball								
BF4015M05S	Sleeve	5V	4.5~5.5	0.10	0.50	6,000±10%	2.00	5.80	30.0
BF4015M05D	2-Ball								
BF4015H05S	Sleeve	5V	4.5~5.5	0.12	0.60	7,000±10%	2.40	8.30	33.0
BF4015H05D	2-Ball								
BF4015L12S	Sleeve	12V	10.8~13.2	0.04	0.48	5,000±10%	1.70	3.60	27.0
BF4015L12D	2-Ball								
BF4015M12S	Sleeve	12V	10.8~13.2	0.05	0.60	6,000±10%	2.00	5.80	30.0
BF4015M12D	2-Ball								
BF4015H12S	Sleeve	12V	10.8~13.2	0.06	0.72	7,000±10%	2.40	8.30	33.0
BF4015H12D	2-Ball								

- * 以上为额定电压下的常规参数(All readings are typical values at rated voltage)
- * 规格如有变动不另行通知(Specifications are subjected to change without prior notice)

DC Blower Fan 45x45x10mm

■ 尺寸图 (DIMENSION DRAWING)

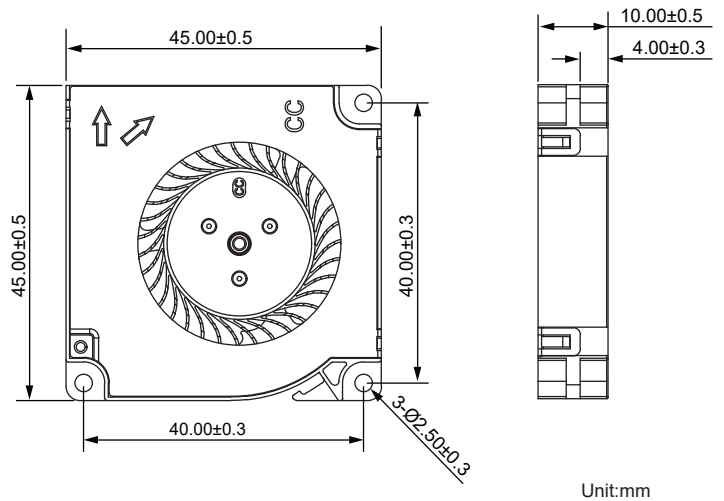

- * 轴承类型: 液压轴承 (Bearing type: Hydraulic)
- * 材料 (Material):
扇叶 (Impeller): PBT
框 (Frame): PBT & Stainless Steel
- * 引线 (Lead wire):
UL1061 AWG #28 or equivalent
红色线正级 Red Wire Positive (+)
黑色线负级 Black Wire Negative (-)
- * 可选择增加风扇功能 (Functions are optional)
- * 重量 (Weight): 18g

■ 风压&风量曲线图 P and Q CURVE

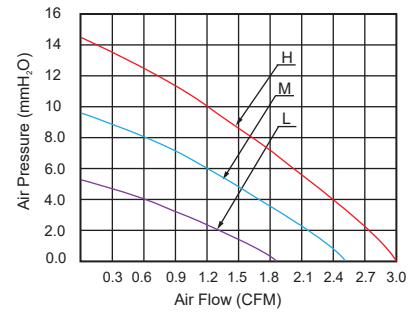

型号 Model	轴承类型 Bearing Type	版本 Version	电压 Rated Voltage	电流 Current	功率 Input Power	转速 Speed	风量 Air Flow	风压 Static Pressure	噪音 Noise Level
			VDC	Amp	Watt	RPM	CFM	MM-H ₂ O	dBA
BF4510L05SH	Hydraulic	-A	5V	0.08	0.40	4,000±10%	1.90	5.40	22.0
BF4510M05SH	Hydraulic	-A	5V	0.18	0.90	5,000±10%	2.50	9.90	31.0
BF4510H05SH	Hydraulic	-A	5V	0.25	1.25	6,000±10%	3.00	14.2	35.0
BF4510L12SH	Hydraulic	-A	12V	0.05	0.60	4,000±10%	1.90	5.40	22.0
BF4510M12SH	Hydraulic	-A	12V	0.08	0.96	5,000±10%	2.50	9.90	31.0
BF4510H12SH	Hydraulic	-A	12V	0.13	1.56	6,000±10%	3.00	14.2	35.0

- * 以上为额定电压下的常规参数 (All readings are typical values at rated voltage)
- * 规格如有变动不另行通知 (Specifications are subjected to change without prior notice)

DC Blower Fan 45x45x10mm

■ 尺寸图 (DIMENSION DRAWING)

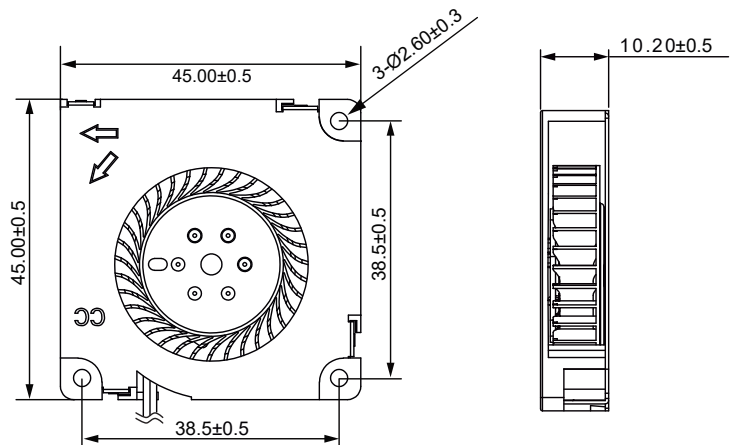

Unit:mm

- * 轴承类型: 液压轴承, FDB轴承 (Bearing type:Hydraulic,FDB)
- * 材料(Material):
扇叶(Impeller):PBT
框(Frame):PBT & SECC
- * 引线(Lead wire):
UL1061 AWG #28 or equivalent
红色线正级 Red Wire Positive (+)
黑色线负级 Black Wire Negative (-)
- * 可选择增加风扇功能(Functions are optional)
- * 重量(Weight):18g

■ 风压&风量曲线图 P and Q CURVE

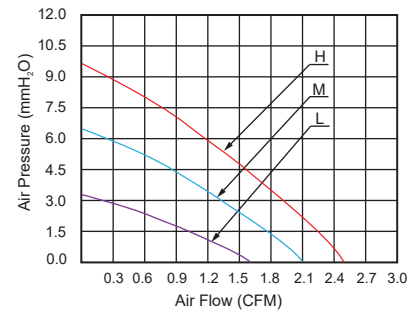

型号 Model	轴承类型 Bearing Type	版本 Version	电压 Rated Voltage	电流 Current	功率 Input Power	转速 Speed	风量 Air Flow	风压 Static Pressure	噪音 Noise Level
			VDC	Amp	Watt	RPM	CFM	MM-H ₂ O	dBA
BF4510L05SH	Hydraulic	-B	5V	0.15	0.75	4,000±10%	1.60	3.10	20.0
BF4510L05S3	FDB								
BF4510M05SH	Hydraulic	-B	5V	0.20	1.00	5,000±10%	2.10	6.30	25.0
BF4510M05S3	FDB								
BF4510H05SH	Hydraulic	-B	5V	0.30	1.50	6,000±10%	2.50	9.50	31.0
BF4510H05S3	FDB								
BF4510L12SH	Hydraulic	-B	12V	0.05	0.60	4,000±10%	1.60	3.10	20.0
BF4510L12S3	FDB								
BF4510M12SH	Hydraulic	-B	12V	0.10	1.20	5,000±10%	2.10	6.30	25.0
BF4510M12S3	FDB								
BF4510H12SH	Hydraulic	-B	12V	0.15	1.80	6,000±10%	2.50	9.50	31.0
BF4510H12S3	FDB								

- * 以上为额定电压下的常规参数(All readings are typical values at rated voltage)
- * 规格如有变动不另行通知(Specifications are subjected to change without prior notice)

DC Blower Fan 40x40x20mm

■ 尺寸图 (DIMENSION DRAWING)

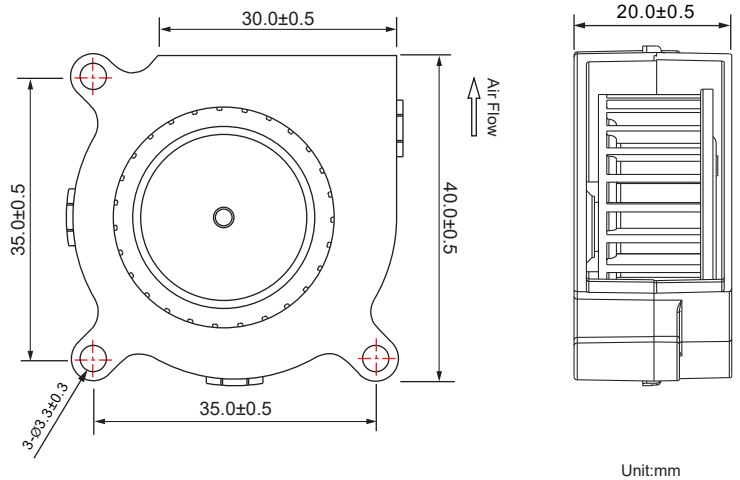

- * 轴承类型: 含油轴承, 双滚珠轴承 (Bearing type: Sleeve, 2-Ball)
- * 材料(Material):
框叶(Frame & Impeller): PBT
- * 引线(Lead wire):
UL2468 AWG #26 or equivalent
红色线正级 Red Wire Positive (+)
黑色线负级 Black Wire Negative (-)
- * 可选择增加风扇功能(Functions are optional)
- * 重量(Weight): 17g

■ 风压&风量曲线图 P and Q CURVE

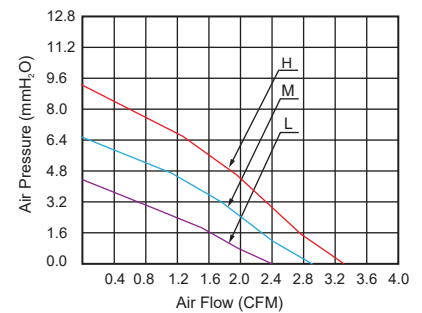

型号 Model	轴承类型 Bearing Type	电压 Rated Voltage	电压范围 Operation Voltage	电流 Current	功率 Input Power	转速 Speed	风量 Air Flow	风压 Static Pressure	噪音 Noise Level
		VDC	VDC	Amp	Watt	RPM	CFM	MM-H ₂ O	dBA
BF4020L05S	Sleeve	5V	4.5~5.5	0.11	0.55	5,000±10%	2.30	3.80	27.9
BF4020L05D	2-Ball								
BF4020M05S	Sleeve	5V	4.5~5.5	0.18	0.90	6,000±10%	2.90	6.50	33.7
BF4020M05D	2-Ball								
BF4020H05S	Sleeve	5V	4.5~5.5	0.24	1.20	7,000±10%	3.30	9.30	38.0
BF4020H05D	2-Ball								
BF4020L12S	Sleeve	12V	10.8~13.2	0.04	0.48	5,000±10%	2.30	3.80	27.9
BF4020L12D	2-Ball								
BF4020M12S	Sleeve	12V	10.8~13.2	0.06	0.72	6,000±10%	2.90	6.50	33.7
BF4020M12D	2-Ball								
BF4020H12S	Sleeve	12V	10.8~13.2	0.10	1.20	7,000±10%	3.30	9.30	38.0
BF4020H12D	2-Ball								

- * 以上为额定电压下的常规参数(All readings are typical values at rated voltage)
- * 规格如有变动不另行通知(Specifications are subjected to change without prior notice)

DC Blower Fan 45x45x7mm

■ 尺寸图 (DIMENSION DRAWING)

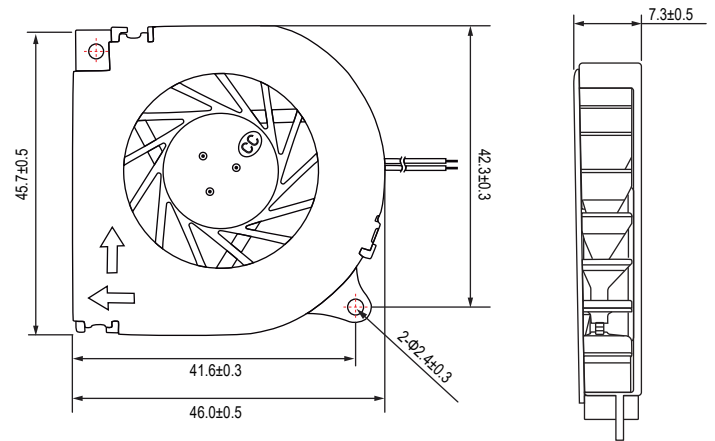

Unit:mm

- * 轴承类型: 液压轴承 (Bearing type: Hydraulic)
- * 材料 (Material):
扇叶 (Impeller): PBT
框 (Frame): PBT & Aluminium
- * 引线 (Lead wire):
UL1061 AWG #28 or equivalent
红色线正级 Red Wire Positive (+)
黑色线负级 Black Wire Negative (-)
- * 可选择增加风扇功能 (Functions are optional)
- * 重量 (Weight): 13g

■ 风压&风量曲线图 P and Q CURVE

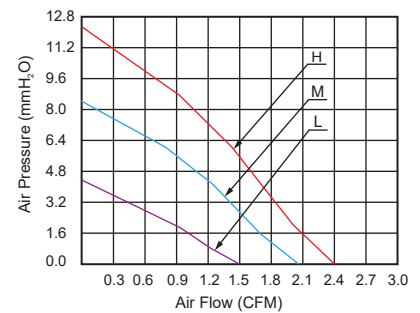

型号 Model	轴承类型 Bearing Type	电压 Rated Voltage	电压范围 Operation Voltage	电流 Current	功率 Input Power	转速 Speed	风量 Air Flow	风压 Static Pressure	噪音 Noise Level
		VDC	VDC	Amp	Watt	RPM	CFM	MM-H ₂ O	dBA
BF4507L05SH	Hydraulic	5V	4.5~5.5	0.12	0.60	4,000±10%	1.60	4.80	20.0
BF4507M05SH	Hydraulic	5V	4.5~5.5	0.18	0.90	5,000±10%	2.00	7.80	24.0
BF4507H05SH	Hydraulic	5V	4.5~5.5	0.24	1.20	6,000±10%	2.40	12.0	30.0
BF4507L12SH	Hydraulic	12V	7~13.2	0.06	0.72	4,000±10%	1.60	4.80	20.0
BF4507M12SH	Hydraulic	12V	7~13.2	0.10	1.20	5,000±10%	2.00	7.80	24.0
BF4507H12SH	Hydraulic	12V	7~13.2	0.14	1.68	6,000±10%	2.40	12.0	30.0
BF4507L24SH	Hydraulic	24V	14~26.4	0.04	0.96	4,000±10%	1.60	4.80	20.0
BF4507M24SH	Hydraulic	24V	14~26.4	0.06	1.44	5,000±10%	2.00	7.80	24.0
BF4507H24SH	Hydraulic	24V	14~26.4	0.08	1.92	6,000±10%	2.40	12.0	30.0

- * 以上为额定电压下的常规参数 (All readings are typical values at rated voltage)
- * 规格如有变动不另行通知 (Specifications are subjected to change without prior notice)

DC Blower Fan 45x45x10mm

■ 尺寸图 (DIMENSION DRAWING)

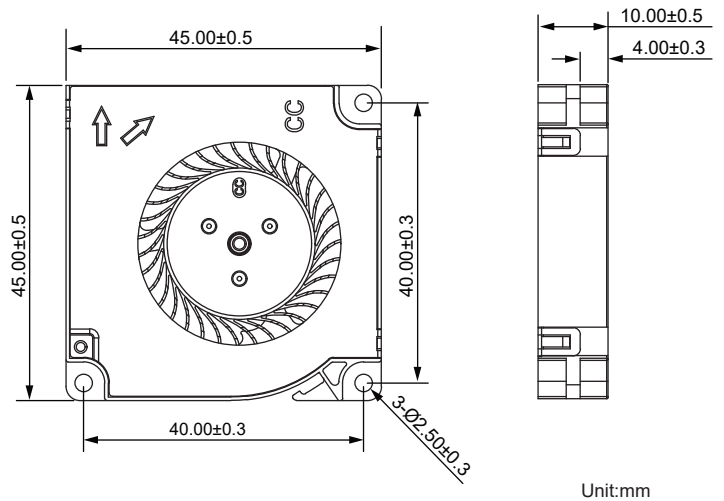

Unit:mm

- * 轴承类型:液压轴承, 流体动压 (Bearing type:Hydraulic,FDB)
- * 材料(Material):
扇叶(Impeller):PBT
框(Frame):PBT & SECC
- * 引线(Lead wire):
UL1061 AWG #28 or equivalent
红色线正级 Red Wire Positive (+)
黑色线负级 Black Wire Negative (-)
- * 可选择增加风扇功能(Functions are optional)
- * 重量(Weight):18g

■ 风压&风量曲线图 P and Q CURVE

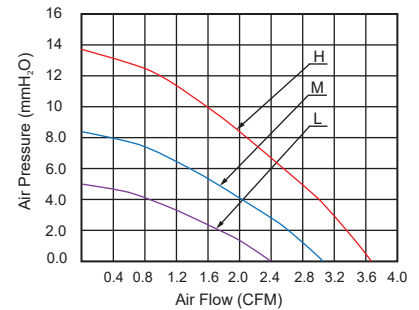

型号 Model	轴承类型 Bearing Type	版本 Version	电压 Rated Voltage	电流 Current	功率 Input Power	转速 Speed	风量 Air Flow	风压 Static Pressure	噪音 Noise Level
			VDC	Amp	Watt	RPM	CFM	MM-H ₂ O	dBA
BF4510L05SH	Hydraulic	-A	5V	0.15	0.75	4,000±10%	2.40	4.70	21.1
BF4510L05S3	FDB								
BF4510M05SH	Hydraulic	-A	5V	0.23	1.15	5,000±10%	3.00	8.20	27.5
BF4510M05S3	FDB								
BF4510H05SH	Hydraulic	-A	5V	0.35	1.75	6,000±10%	3.70	13.8	32.0
BF4510H05S3	FDB								
BF4510L12SH	Hydraulic	-A	12V	0.07	0.84	4,000±10%	2.40	4.70	21.1
BF4510L12S3	FDB								
BF4510M12SH	Hydraulic	-A	12V	0.10	1.20	5,000±10%	3.00	8.20	27.5
BF4510M12S3	FDB								
BF4510H12SH	Hydraulic	-A	12V	0.15	1.80	6,000±10%	3.70	13.8	32.0
BF4510H12S3	FDB								

- * 以上为额定电压下的常规参数(All readings are typical values at rated voltage)
- * 规格如有变动不另行通知(Specifications are subjected to change without prior notice)

DC Blower Fan 45x45x15mm

■ 尺寸图 (DIMENSION DRAWING)

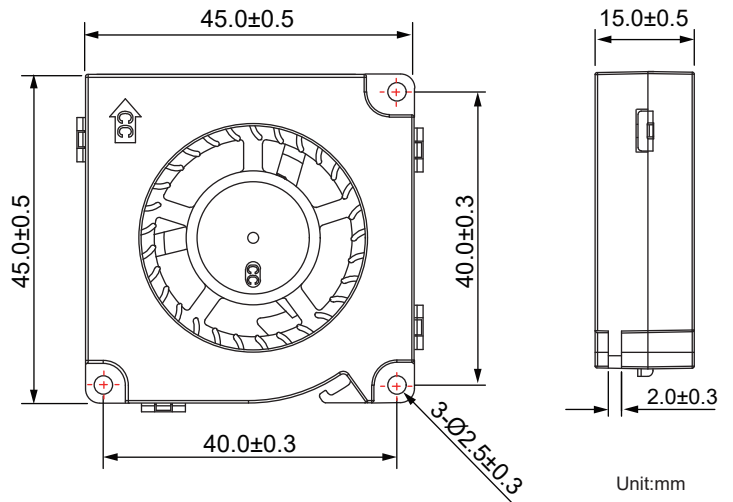

- * 轴承类型: 液压轴承 (Bearing type: Hydraulic)
- * 材料 (Material):
扇叶 (Impeller): PBT
框 (Frame): PBT & Stainless Steel
- * 引线 (Lead wire):
UL1061 AWG #28 or equivalent
红色线正级 Red Wire Positive (+)
黑色线负级 Black Wire Negative (-)
- * 可选择增加风扇功能 (Functions are optional)
- * 重量 (Weight): 19g

■ 风压&风量曲线图 P and Q CURVE

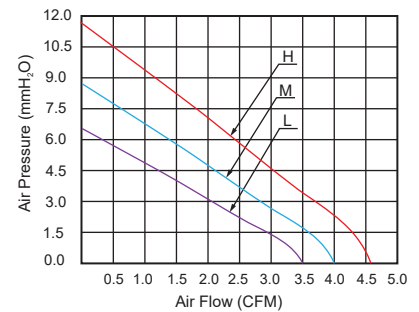

型号 Model	轴承类型 Bearing Type	电压 Rated Voltage	电压范围 Operation Voltage	电流 Current	功率 Input Power	转速 Speed	风量 Air Flow	风压 Static Pressure	噪音 Noise Level
		VDC	VDC	Amp	Watt	RPM	CFM	MM-H ₂ O	dBA
BF4515L05SH	Hydraulic	5V	4.5~5.5	0.09	0.45	4,000±10%	3.50	6.50	25.7
BF4515M05SH	Hydraulic	5V	4.5~5.5	0.18	0.90	4,500±10%	4.00	8.80	28.7
BF4515H05SH	Hydraulic	5V	4.5~5.5	0.27	1.35	5,000±10%	4.60	11.6	31.5
BF4515L12SH	Hydraulic	12V	10.8~13.2	0.06	0.72	4,000±10%	3.50	6.50	25.7
BF4515M12SH	Hydraulic	12V	10.8~13.2	0.10	1.20	4,500±10%	4.00	8.80	28.7
BF4515H12SH	Hydraulic	12V	10.8~13.2	0.15	1.80	5,000±10%	4.60	11.6	31.5

- * 以上为额定电压下的常规参数 (All readings are typical values at rated voltage)
- * 规格如有变动不另行通知 (Specifications are subjected to change without prior notice)

DC Blower Fan 50x50x8mm

■ 尺寸图 (DIMENSION DRAWING)

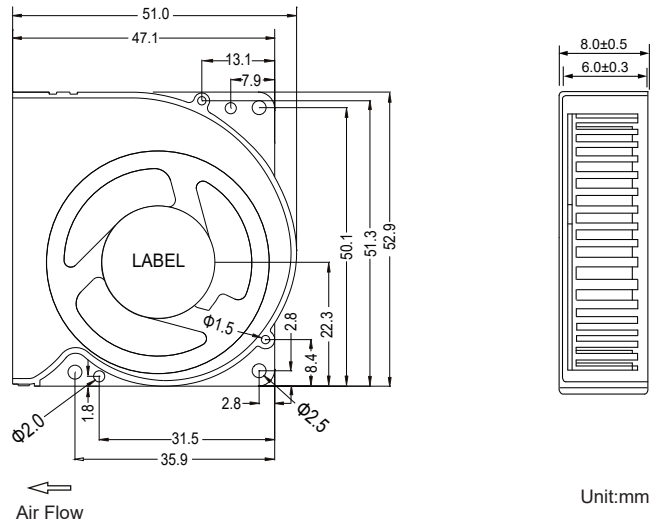
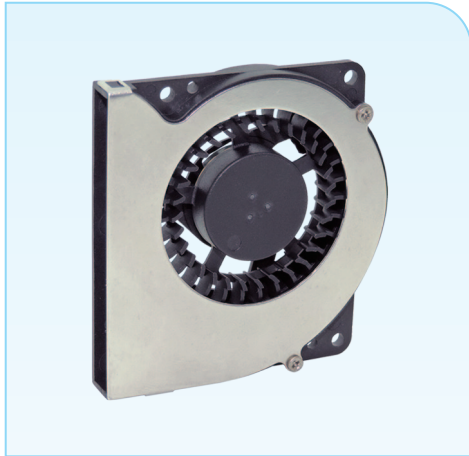

- * 轴承类型: 液压轴承 (Bearing type:Hydraulic)
- * 材料(Material):
扇叶(Impeller):PBT
框(Frame):PBT & Stainless Steel
- * 引线(Lead wire):
UL1061 AWG #28 or equivalent
红色线正级 Red Wire Positive (+)
黑色线负级 Black Wire Negative (-)
- * 可选择增加风扇功能(Functions are optional)
- * 重量(Weight):6.4g

■ 风压&风量曲线图 P and Q CURVE

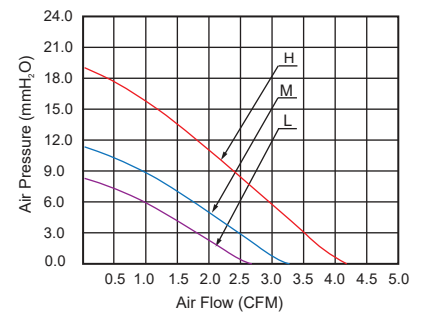

型号 Model	轴承类型 Bearing Type	电压 Rated Voltage	电压范围 Operation Voltage	电流 Current	功率 Input Power	转速 Speed	风量 Air Flow	风压 Static Pressure	噪音 Noise Level
		VDC	VDC	Amp	Watt	RPM	CFM	MM-H ₂ O	dBA
BF5008L05SH	Hydraulic	5V	4.5~5.5	0.10	0.50	4,000±10%	2.60	8.00	28.0
BF5008M05SH	Hydraulic	5V	4.5~5.5	0.19	0.95	5,000±10%	3.40	11.4	33.0
BF5008H05SH	Hydraulic	5V	4.5~5.5	0.36	1.80	6,000±10%	4.20	19.0	38.0
BF5008L12SH	Hydraulic	12V	10.8~13.2	0.05	0.60	4,000±10%	2.60	8.00	28.0
BF5008M12SH	Hydraulic	12V	10.8~13.2	0.15	1.80	5,000±10%	3.40	11.4	33.0
BF5008H12SH	Hydraulic	12V	10.8~13.2	0.23	2.76	6,000±10%	4.20	19.0	38.0

- * 以上为额定电压下的常规参数(All readings are typical values at rated voltage)
- * 规格如有变动不另行通知(Specifications are subjected to change without prior notice)

DC Blower Fan 50x50x11mm

■ 尺寸图 (DIMENSION DRAWING)

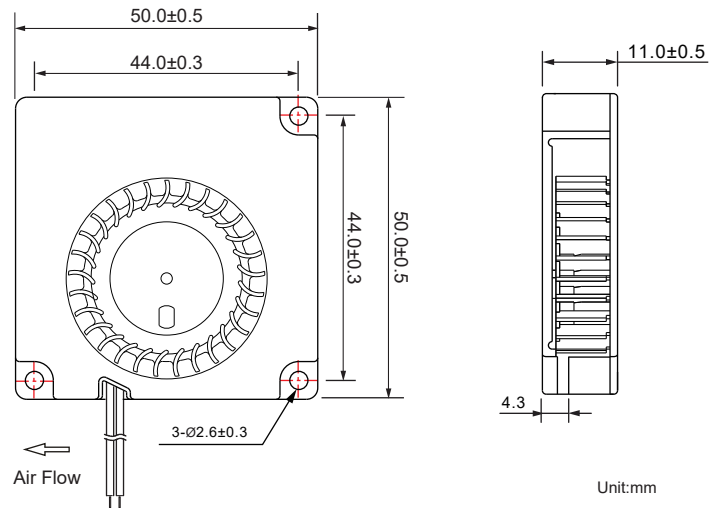

- * 轴承类型: 双滚珠轴承, 液压轴承 (Bearing type: 2-Ball, Hydraulic)
- * 材料 (Material):
框叶 (Frame & Impeller): PBT
- * 引线 (Lead wire):
UL1571 AWG #26 or equivalent
红色线正级 Red Wire Positive (+)
黑色线负级 Black Wire Negative (-)
- * 可选择增加风扇功能 (Functions are optional)
- * 重量 (Weight): 21g

■ 风压&风量曲线图 P and Q CURVE

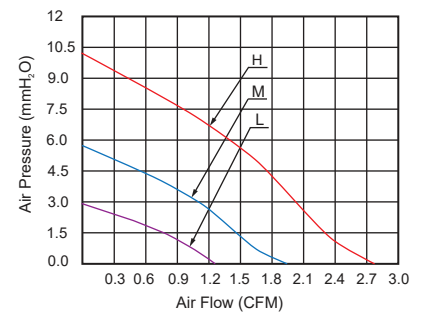

型号 Model	轴承类型 Bearing Type	电压 Rated Voltage	电压范围 Operation Voltage	电流 Current	功率 Input Power	转速 Speed	风量 Air Flow	风压 Static Pressure	噪音 Noise Level
		VDC	VDC	Amp	Watt	RPM	CFM	MM-H ₂ O	dBA
BF5010L05D	2-Ball	5V	4.5~5.5	0.04	0.20	3,000±10%	1.28	2.85	18.2
BF5010L05SH	Hydraulic								
BF5010M05D	2-Ball	5V	4.5~5.5	0.09	0.45	4,000±10%	1.90	5.80	23.0
BF5010M05SH	Hydraulic								
BF5010H05D	2-Ball	5V	4.5~5.5	0.20	1.00	5,000±10%	2.80	9.85	29.6
BF5010H05SH	Hydraulic								
BF5010L12D	2-Ball	12V	10.8~13.2	0.02	0.24	3,000±10%	1.28	2.85	18.2
BF5010L12SH	Hydraulic								
BF5010M12D	2-Ball	12V	10.8~13.2	0.04	0.48	4,000±10%	1.90	5.80	23.0
BF5010M12SH	Hydraulic								
BF5010H12D	2-Ball	12V	10.8~13.2	0.08	0.96	5,000±10%	2.80	9.85	29.6
BF5010H12SH	Hydraulic								

- * 以上为额定电压下的常规参数 (All readings are typical values at rated voltage)
- * 规格如有变动不另行通知 (Specifications are subjected to change without prior notice)

DC Blower Fan 51x51x15mm

■ 尺寸图 (DIMENSION DRAWING)

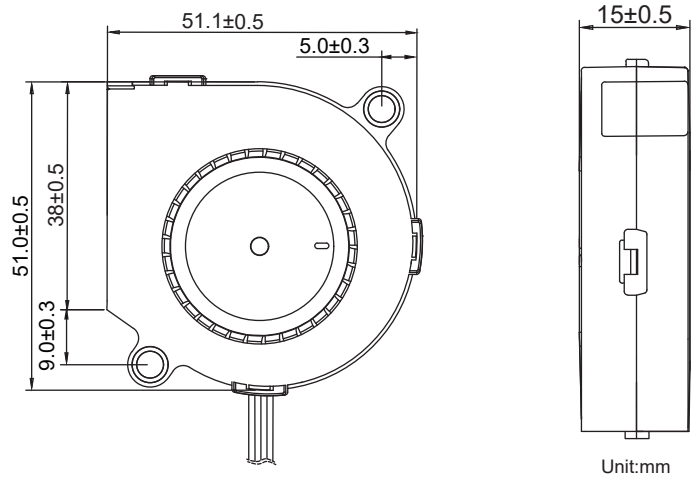

- * 轴承类型: 液压轴承, FDB轴承 (Bearing type: Hydraulic, 2-Ball)
- * 材料(Material):
扇叶(Impeller): PBT
框(Frame): PBT
- * 引线(Lead wire):
UL1061 AWG #26 or equivalent
红色线正级 Red Wire Positive (+)
黑色线负级 Black Wire Negative (-)
- * 可选择增加风扇功能(Functions are optional)
- * 重量(Weight): 27g

■ 风压&风量曲线图 P and Q CURVE

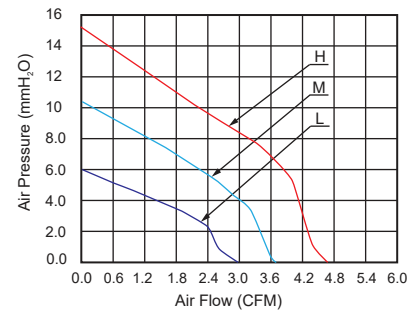

型号 Model	轴承类型 Bearing Type	版本 Version	电压 Rated Voltage	电流 Current	功率 Input Power	转速 Speed	风量 Air Flow	风压 Static Pressure	噪音 Noise Level
			VDC	Amp	Watt	RPM	CFM	MM-H ₂ O	dBA
BF5015L05SH	Hydraulic	-B	5V	0.08	0.40	4,000±10%	2.90	6.00	31.0
BF5015L05D	2-Ball								
BF5015M05SH	Hydraulic	-B	5V	0.14	0.70	5,000±10%	3.70	10.3	37.0
BF5015M05D	2-Ball								
BF5015H05SH	Hydraulic	-B	5V	0.30	1.50	6,000±10%	4.50	15.5	43.0
BF5015H05D	2-Ball								
BF5015L12SH	Hydraulic	-B	12V	0.05	0.60	4,000±10%	2.90	6.00	31.0
BF5015L12D	2-Ball								
BF5015M12SH	Hydraulic	-B	12V	0.08	1.00	5,000±10%	3.70	10.3	37.0
BF5015M12D	2-Ball								
BF5015H12SH	Hydraulic	-B	12V	0.15	1.80	6,000±10%	4.50	15.5	43.0
BF5015H12D	2-Ball								

- * 以上为额定电压下的常规参数(All readings are typical values at rated voltage)
- * 规格如有变动不另行通知(Specifications are subjected to change without prior notice)

DC Blower Fan 50x50x20mm

■ 尺寸图 (DIMENSION DRAWING)

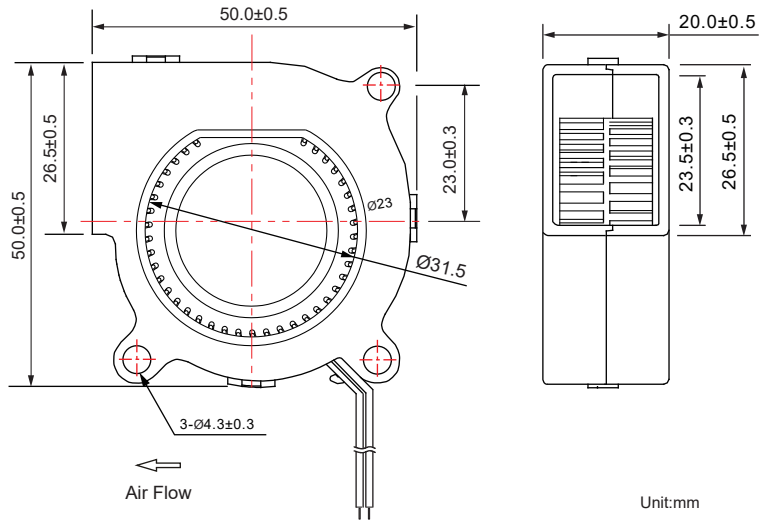
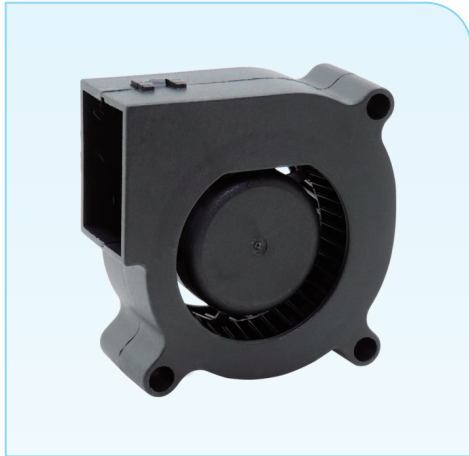

- * 轴承类型: 含油轴承, 双滚珠轴承 (Bearing type:Sleeve,2-Ball)
- * 材料(Material):
框叶(Frame & Impeller):PBT
- * 引线(Lead wire):
UL2468 AWG #28 or equivalent
红色线正级 Red Wire Positive (+)
黑色线负级 Black Wire Negative (-)
- * 可选择增加风扇功能(Functions are optional)
- * 重量(Weight):30g

■ 风压&风量曲线图 P and Q CURVE

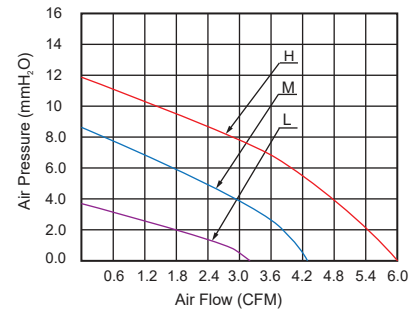

型号 Model	轴承类型 Bearing Type	版本 Version	电压 Rated Voltage	电流 Current	功率 Input Power	转速 Speed	风量 Air Flow	风压 Static Pressure	噪音 Noise Level
			VDC	Amp	Watt	RPM	CFM	MM-H ₂ O	dBA
BF5020L12S	Sleeve	-A	12V	0.05	0.60	3,000±10%	3.30	3.80	20.0
BF5020L12D	2-Ball								
BF5020M12S	Sleeve	-A	12V	0.07	0.84	4,000±10%	4.30	8.30	27.0
BF5020M12D	2-Ball								
BF5020H12S	Sleeve	-A	12V	0.12	1.44	5,000±10%	6.00	12.0	34.0
BF5020H12D	2-Ball								
BF5020L24S	Sleeve	-A	24V	0.03	0.72	3,000±10%	3.30	3.80	20.0
BF5020L24D	2-Ball								
BF5020M24S	Sleeve	-A	24V	0.06	1.44	4,000±10%	4.30	8.30	27.0
BF5020M24D	2-Ball								
BF5020H24S	Sleeve	-A	24V	0.08	1.92	5,000±10%	6.00	12.0	34.0
BF5020H24D	2-Ball								

- * 以上为额定电压下的常规参数(All readings are typical values at rated voltage)
- * 规格如有变动不另行通知(Specifications are subjected to change without prior notice)

DC Blower Fan 50x50x20mm

■ 尺寸图 (DIMENSION DRAWING)

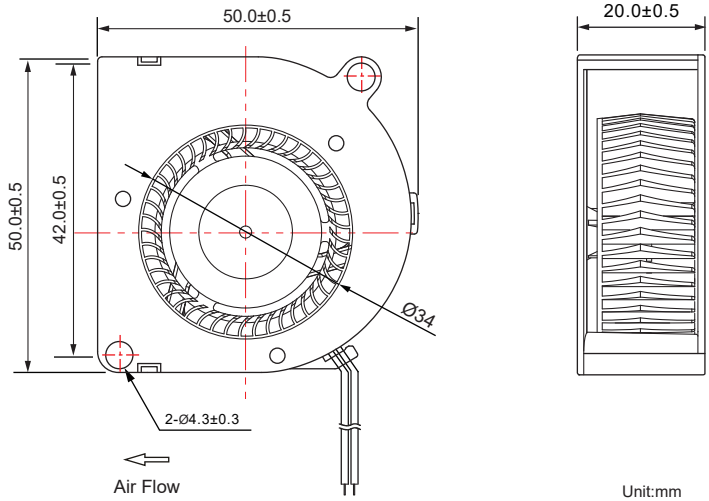

Unit:mm

- * 轴承类型: 含油轴承, 双滚珠轴承 (Bearing type:Sleeve,2-Ball)
- * 材料(Material):
框叶(Frame & Impeller):PBT
- * 引线(Lead wire):
UL2468 AWG #28 or equivalent
红色线正级 Red Wire Positive (+)
黑色线负级 Black Wire Negative (-)
- * 可选择增加风扇功能(Functions are optional)
- * 重量(Weight):28g

■ 风压&风量曲线图 P and Q CURVE

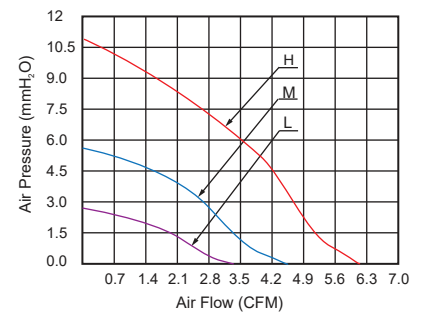

型号 Model	轴承类型 Bearing Type	版本 Version	电压 Rated Voltage	电流 Current	功率 Input Power	转速 Speed	风量 Air Flow	风压 Static Pressure	噪音 Noise Level
			VDC	Amp	Watt	RPM	CFM	MM-H ₂ O	dBA
BF5020L05S	Sleeve	-B	5V	0.08	0.40	3,000±10%	3.10	2.60	21.0
BF5020L05D	2-Ball								
BF5020M05S	Sleeve	-B	5V	0.11	0.55	4,000±10%	4.40	5.20	27.0
BF5020M05D	2-Ball								
BF5020H05S	Sleeve	-B	5V	0.30	1.50	5,000±10%	6.10	10.9	33.0
BF5020H05D	2-Ball								
BF5020L12S	Sleeve	-B	12V	0.04	0.48	3,000±10%	3.10	2.60	21.0
BF5020L12D	2-Ball								
BF5020M12S	Sleeve	-B	12V	0.07	0.84	4,000±10%	4.40	5.20	27.0
BF5020M12D	2-Ball								
BF5020H12S	Sleeve	-B	12V	0.12	1.44	5,000±10%	6.10	10.9	33.0
BF5020H12D	2-Ball								

- * 以上为额定电压下的常规参数(All readings are typical values at rated voltage)
- * 规格如有变动不另行通知(Specifications are subjected to change without prior notice)

DC Blower Fan 50x50x20mm

■ 尺寸图 (DIMENSION DRAWING)

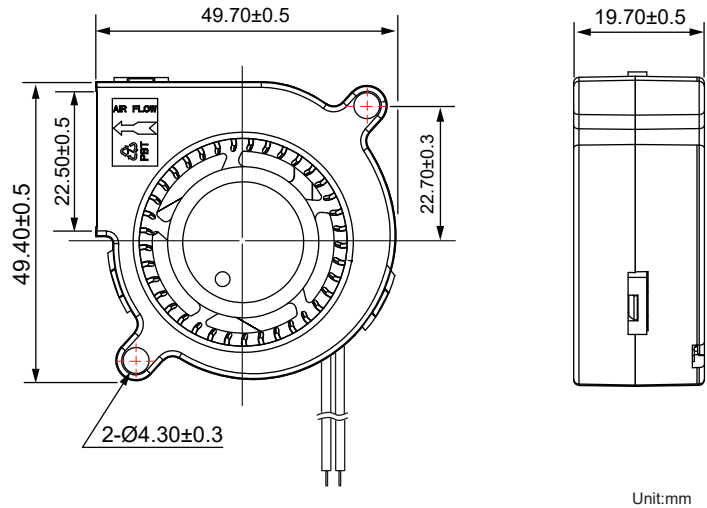

Unit:mm

- * 轴承类型: 双滚珠轴承 (Bearing type:2-Ball)
- * 材料(Material): 框叶(Frame & Impeller):PBT
- * 引线(Lead wire): UL2468 AWG #28 or equivalent
红色线正级 Red Wire Positive (+)
黑色线负级 Black Wire Negative (-)
- * 可选择增加风扇功能(Functions are optional)
- * 重量(Weight):30g

■ 风压&风量曲线图 P and Q CURVE

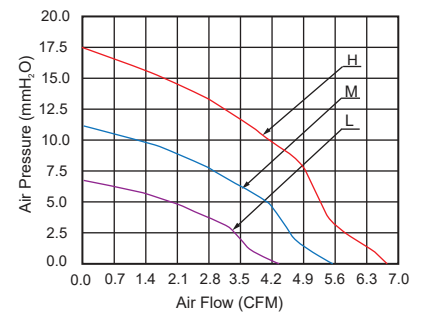

型号 Model	轴承类型 Bearing Type	版本 Version	电压 Rated Voltage	电流 Current	功率 Input Power	转速 Speed	风量 Air Flow	风压 Static Pressure	噪音 Noise Level
			VDC	Amp	Watt	RPM	CFM	MM-H ₂ O	dBA
BF5020L12D	2-Ball	-D	12V	0.07	0.84	4,000±10%	4.30	6.20	24.0
BF5020M12D	2-Ball	-D	12V	0.14	1.68	5,000±10%	5.50	11.0	32.0
BF5020H12D	2-Ball	-D	12V	0.20	2.40	6,000±10%	6.60	17.5	36.0
BF5020L24D	2-Ball	-D	24V	0.04	0.96	4,000±10%	4.30	6.20	24.0
BF5020M24D	2-Ball	-D	24V	0.08	1.92	5,000±10%	5.50	11.0	32.0
BF5020H24D	2-Ball	-D	24V	0.12	2.88	6,000±10%	6.60	17.5	36.0

- * 以上为额定电压下的常规参数(All readings are typical values at rated voltage)
- * 规格如有变动不另行通知(Specifications are subjected to change without prior notice)

DC Blower Fan 51x51x25mm

■ 尺寸图 (DIMENSION DRAWING)

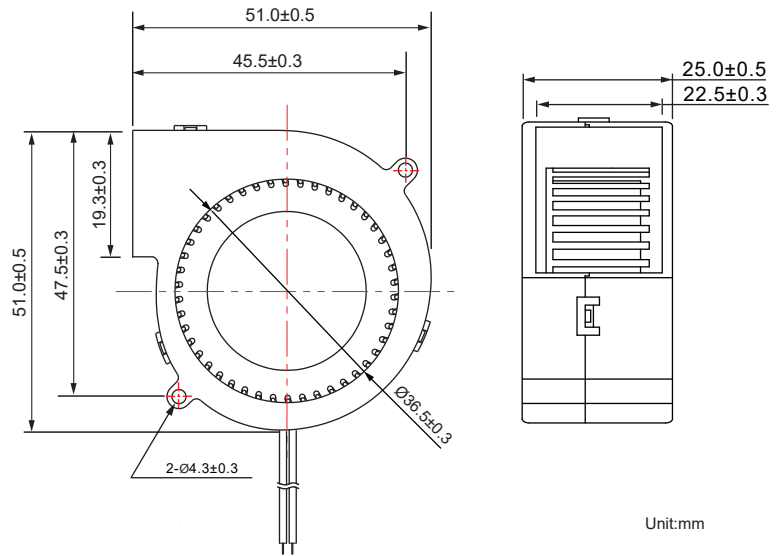
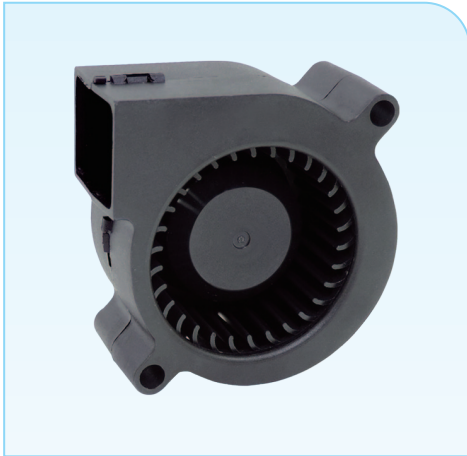

Unit:mm

- * 轴承类型: 含油轴承, 双滚珠轴承 (Bearing type:Sleeve,2-Ball)
- * 材料(Material):
框叶(Frame & Impeler):PBT
- * 引线(Lead wire):
UL2468 AWG #26 or equivalent
红色线正级 Red Wire Positive (+)
黑色线负级 Black Wire Negative (-)
- * 可选择增加风扇功能(Functions are optional)
- * 重量(Weight):24g

■ 风压&风量曲线图 P and Q CURVE

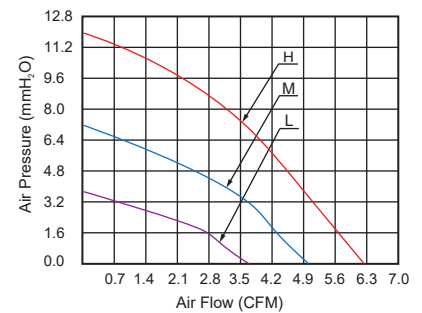

型号 Model	轴承类型 Bearing Type	电压 Rated Voltage	电压范围 Operation Voltage	电流 Current	功率 Input Power	转速 Speed	风量 Air Flow	风压 Static Pressure	噪音 Noise Level
		VDC	VDC	Amp	Watt	RPM	CFM	MM-H ₂ O	dBA
BF5025L05S	Sleeve	5V	4.5~5.5	0.06	0.30	3,000±10%	3.80	5.10	23.5
BF5025L05D	2-Ball								
BF5025M05S	Sleeve	5V	4.5~5.5	0.24	1.20	4,000±10%	5.10	6.80	30.3
BF5025M05D	2-Ball								
BF5025H05S	Sleeve	5V	4.5~5.5	0.48	2.40	5,000±10%	6.10	12.1	39.3
BF5025H05D	2-Ball								
BF5025L12S	Sleeve	12V	10.8~13.2	0.06	0.72	3,000±10%	3.80	5.10	23.0
BF5025L12D	2-Ball								
BF5025M12S	Sleeve	12V	10.8~13.2	0.08	0.96	4,000±10%	5.10	6.80	30.3
BF5025M12D	2-Ball								
BF5025H12S	Sleeve	12V	10.8~13.2	0.15	1.80	5,000±10%	6.10	12.1	39.3
BF5025H12D	2-Ball								

- * 以上为额定电压下的常规参数(All readings are typical values at rated voltage)
- * 规格如有变动不另行通知(Specifications are subjected to change without prior notice)

DC Blower Fan 55x55x12mm

■ 尺寸图 (DIMENSION DRAWING)

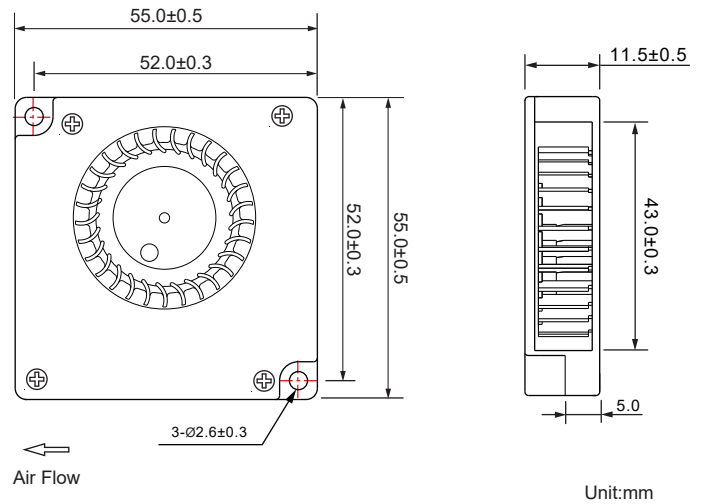

- * 轴承类型: 双滚珠轴承 (Bearing type: 2-Ball)
- * 材料(Material): 框叶(Frame & Impeller): PBT
- * 引线(Lead wire): UL1571 AWG #26 or equivalent
红色线正级 Red Wire Positive (+)
黑色线负级 Black Wire Negative (-)
- * 可选择增加风扇功能(Functions are optional)
- * 重量(Weight): 21g

■ 风压&风量曲线图 P and Q CURVE

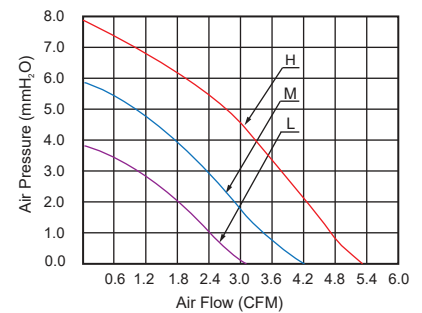

型号 Model	轴承类型 Bearing Type	电压 Rated Voltage	电压范围 Operation Voltage	电流 Current	功率 Input Power	转速 Speed	风量 Air Flow	风压 Static Pressure	噪音 Noise Level
		VDC	VDC	Amp	Watt	RPM	CFM	MM-H ₂ O	dBA
BF5512L05D	2-Ball	5V	4.5~5.5	0.10	0.50	3,000±10%	3.10	3.80	23.0
BF5512M05D	2-Ball	5V	4.5~5.5	0.25	1.25	4,000±10%	4.20	5.90	28.0
BF5512H05D	2-Ball	5V	4.5~5.5	0.46	2.30	5,000±10%	5.20	7.80	31.0
BF5512L12D	2-Ball	12V	10.8~13.2	0.07	0.84	3,000±10%	3.10	3.80	23.0
BF5512M12D	2-Ball	12V	10.8~13.2	0.12	1.44	4,000±10%	4.20	5.90	28.0
BF5512H12D	2-Ball	12V	10.8~13.2	0.23	2.76	5,000±10%	5.20	7.80	31.0

- * 以上为额定电压下的常规参数(All readings are typical values at rated voltage)
- * 规格如有变动不另行通知(Specifications are subjected to change without prior notice)

DC Blower Fan 60x55x8.8mm

■ 尺寸图 (DIMENSION DRAWING)

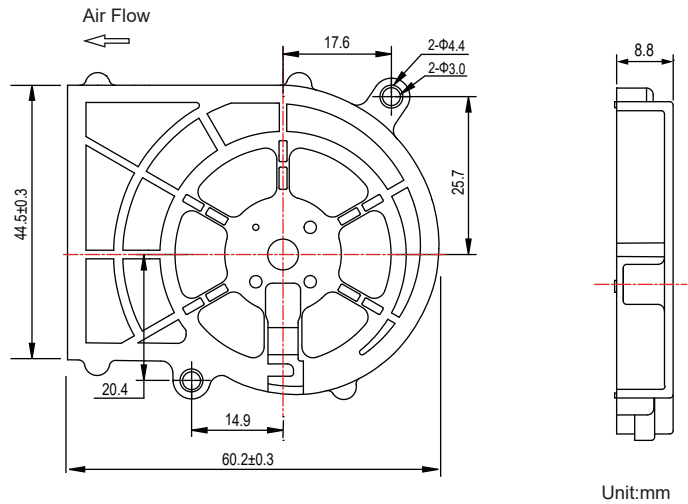

- * 轴承类型: 液压轴承 (Bearing type:Hydraulic)
- * 材料(Material):
扇叶(Impeller):PBT
框(Frame):PBT & Stainless Steel
- * 引线(Lead wire):
UL1571 AWG #26 or equivalent
红色线正级 Red Wire Positive (+)
黑色线负级 Black Wire Negative (-)
- * 可选择增加风扇功能(Functions are optional)
- * 重量(Weight):17g

■ 风压&风量曲线图 P and Q CURVE

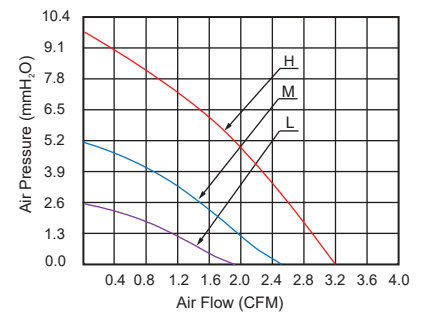

型号 Model	轴承类型 Bearing Type	电压 Rated Voltage	电压范围 Operation Voltage	电流 Current	功率 Input Power	转速 Speed	风量 Air Flow	风压 Static Pressure	噪音 Noise Level
		VDC	VDC	Amp	Watt	RPM	CFM	MM-H ₂ O	dBA
BF6008L05SH	Hydraulic	5V	4.5~5.5	0.12	0.60	3,000±10%	1.84	2.43	19.0
BF6008M05SH	Hydraulic	5V	4.5~5.5	0.16	0.80	4,000±10%	2.50	5.16	25.4
BF6008H05SH	Hydraulic	5V	4.5~5.5	0.30	1.50	5,000±10%	3.20	9.60	31.2
BF6008L12SH	Hydraulic	12V	10.8~13.2	0.02	0.24	3,000±10%	1.84	2.43	19.0
BF6008M12SH	Hydraulic	12V	10.8~13.2	0.07	0.84	4,000±10%	2.50	5.16	25.4
BF6008H12SH	Hydraulic	12V	10.8~13.2	0.23	2.76	5,000±10%	3.20	9.60	31.2

- * 以上为额定电压下的常规参数(All readings are typical values at rated voltage)
- * 规格如有变动不另行通知(Specifications are subjected to change without prior notice)

DC Blower Fan 60x60x10mm

■ 尺寸图 (DIMENSION DRAWING)

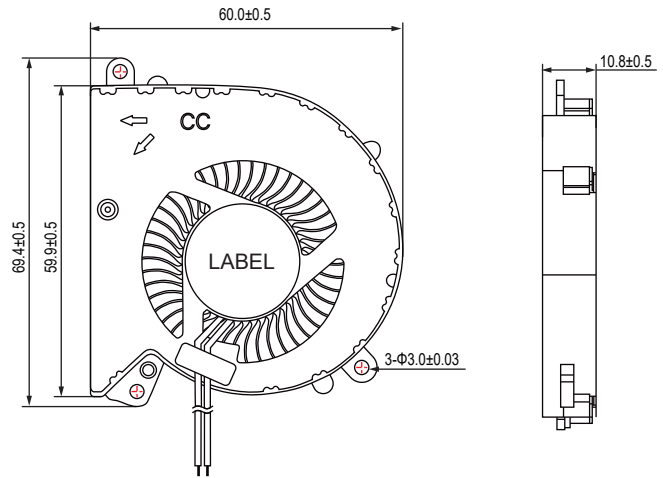

Unit:mm

- * 轴承类型: 流体动压 (Bearing type:FDB)
- * 材料(Material):
扇叶 (Impeller):PBT
框 (Frame):PBT&SPCC
- * 引线(Lead wire):
UL1061 AWG #28 or equivalent
红色线正级 Red Wire Positive (+)
黑色线负级 Black Wire Negative (-)
- * 可选择增加风扇功能(Functions are optional)
- * 重量(Weight):34g

■ 风压&风量曲线图 P and Q CURVE

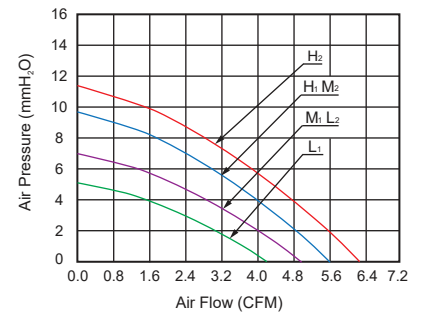

型号 Model	轴承类型 Bearing Type	电压 Rated Voltage	电压范围 Operation Voltage	电流 Current	功率 Input Power	转速 Speed	风量 Air Flow	风压 Static Pressure	噪音 Noise Level
		VDC	VDC	Amp	Watt	RPM	CFM	MM-H ₂ O	dBA
BF6010L05S3	FDB	5V	4.5~5.5	0.15	0.75	3,000±10%	4.15	5.00	20.4
BF6010M05S3	FDB	5V	4.5~5.5	0.25	1.25	3,500±10%	4.85	6.90	24.0
BF6010H05S3	FDB	5V	4.5~5.5	0.30	1.50	4,000±10%	5.50	9.40	27.6
BF6010L12S3	FDB	12V	10.8~13.2	0.12	1.44	3,500±10%	4.85	6.90	24.0
BF6010M12S3	FDB	12V	10.8~13.2	0.17	2.04	4,000±10%	5.50	9.40	27.6
BF6010H12S3	FDB	12V	10.8~13.2	0.22	2.64	4,500±10%	6.00	11.5	31.0

- * 以上为额定电压下的常规参数(All readings are typical values at rated voltage)
- * 规格如有变动不另行通知(Specifications are subjected to change without prior notice)

DC Blower Fan 60x60x12mm

■ 尺寸图 (DIMENSION DRAWING)

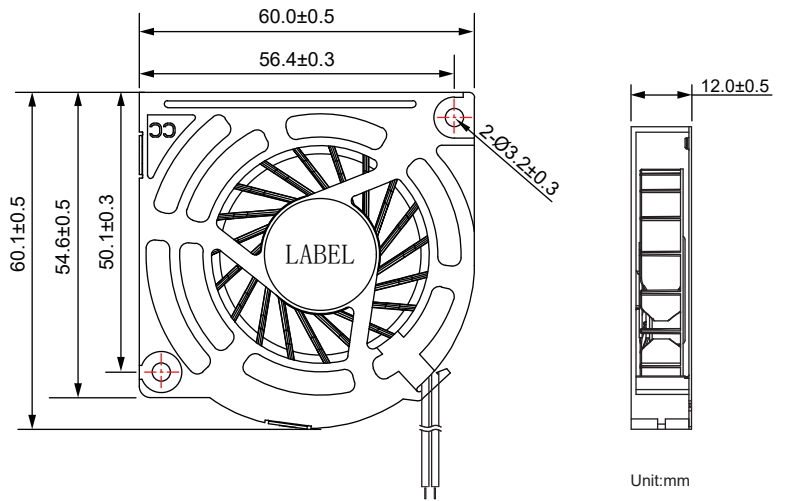

- * 轴承类型: 含油轴承, 双滚珠轴承, 液压轴承 (Bearing type: Sleeve, 2-Ball, Hydraulic)
- * 材料(Material):
扇叶(Impeller): PBT
框(Frame): PBT & SECC
- * 引线(Lead wire):
UL1061 AWG #26 or equivalent
红色线正级 Red Wire Positive (+)
黑色线负级 Black Wire Negative (-)
- * 可选择增加风扇功能(Functions are optional)
- * 重量(Weight): 28g

■ 风压&风量曲线图 P and Q CURVE

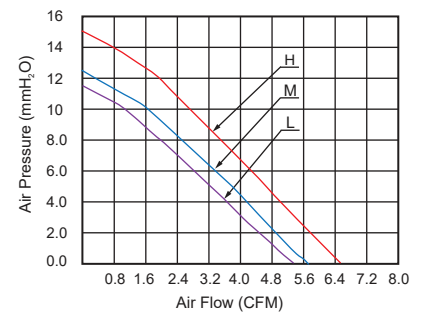

型号 Model	轴承类型 Bearing Type	电压 Rated Voltage	电压范围 Operation Voltage	电流 Current	功率 Input Power	转速 Speed	风量 Air Flow	风压 Static Pressure	噪音 Noise Level
		VDC	VDC	Amp	Watt	RPM	CFM	MM-H ₂ O	dBA
BF6012L05S	Sleeve	5V	4.5~5.5	0.21	1.05	3,500±10%	5.20	11.80	27.0
BF6012L05D	2-Ball								
BF6012L05SH	Hydraulic								
BF6012M05S	Sleeve	5V	4.5~5.5	0.34	1.70	4,000±10%	5.80	12.50	30.8
BF6012M05D	2-Ball								
BF6012M05SH	Hydraulic								
BF6012H05S	Sleeve	5V	4.5~5.5	0.43	2.15	4,500±10%	6.50	14.80	32.4
BF6012H05D	2-Ball								
BF6012H05SH	Hydraulic								
BF6012L12S	Sleeve	12V	10.8~13.2	0.10	1.20	3,500±10%	5.20	11.80	27.0
BF6012L12D	2-Ball								
BF6012L12SH	Hydraulic								
BF6012M12S	Sleeve	12V	10.8~13.2	0.15	1.80	4,000±10%	5.80	12.40	30.8
BF6012M12D	2-Ball								
BF6012M12SH	Hydraulic								
BF6012H12S	Sleeve	12V	10.8~13.2	0.20	2.40	4,500±10%	6.50	14.80	34.7
BF6012H12D	2-Ball								
BF6012H12SH	Hydraulic								

- * 以上为额定电压下的常规参数(All readings are typical values at rated voltage)
- * 规格如有变动不另行通知(Specifications are subjected to change without prior notice)

DC Blower Fan 60x60x15mm

■ 尺寸图 (DIMENSION DRAWING)

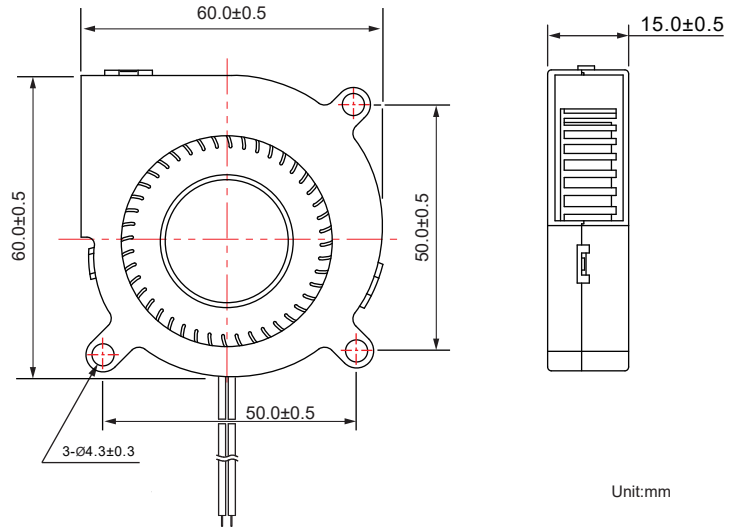

- * 轴承类型: 含油轴承, 双滚珠轴承, 液压轴承 (Bearing type: Sleeve, 2-Ball, Hydraulic)
- * 材料(Material):
框叶(Frame & Impeller): PBT
- * 引线(Lead wire):
UL2468 AWG #26 or equivalent
红色线正级 Red Wire Positive (+)
黑色线负级 Black Wire Negative (-)
- * 可选择增加风扇功能(Functions are optional)
- * 重量(Weight): 35g

■ 风压&风量曲线图 P and Q CURVE

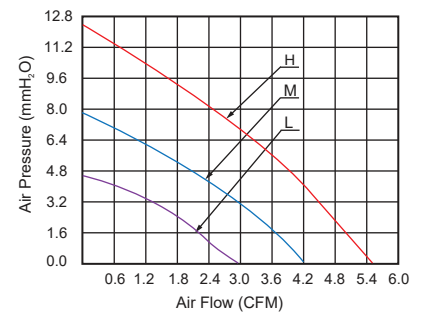

型号 Model	轴承类型 Bearing Type	电压 Rated Voltage	电压范围 Operation Voltage	电流 Current	功率 Input Power	转速 Speed	风量 Air Flow	风压 Static Pressure	噪音 Noise Level
		VDC	VDC	Amp	Watt	RPM	CFM	MM-H ₂ O	dBA
BF6015L12S	Sleeve	12V	10.8~13.2	0.09	1.08	3,000±10%	2.80	4.50	31.0
BF6015L12D	2-Ball								
BF6015L12SH	Hydraulic								
BF6015M12S	Sleeve	12V	10.8~13.2	0.10	1.20	4,000±10%	4.20	7.80	37.0
BF6015M12D	2-Ball								
BF6015M12SH	Hydraulic								
BF6015H12S	Sleeve	12V	10.8~13.2	0.17	2.04	5,000±10%	5.50	12.2	44.0
BF6015H12D	2-Ball								
BF6015H12SH	Hydraulic								
BF6015L24S	Sleeve	24V	21.6~26.4	0.03	0.72	3,000±10%	2.80	4.50	31.0
BF6015L24D	2-Ball								
BF6015L24SH	Hydraulic								
BF6015M24S	Sleeve	24V	21.6~26.4	0.04	0.96	4,000±10%	4.20	7.80	37.0
BF6015M24D	2-Ball								
BF6015M24SH	Hydraulic								
BF6015H24S	Sleeve	24V	21.6~26.4	0.10	2.40	5,000±10%	5.50	12.2	44.0
BF6015H24D	2-Ball								
BF6015H24SH	Hydraulic								

- * 以上为额定电压下的常规参数(All readings are typical values at rated voltage)
- * 规格如有变动不另行通知(Specifications are subjected to change without prior notice)

DC Blower Fan 60x60x25mm

■ 尺寸图 (DIMENSION DRAWING)

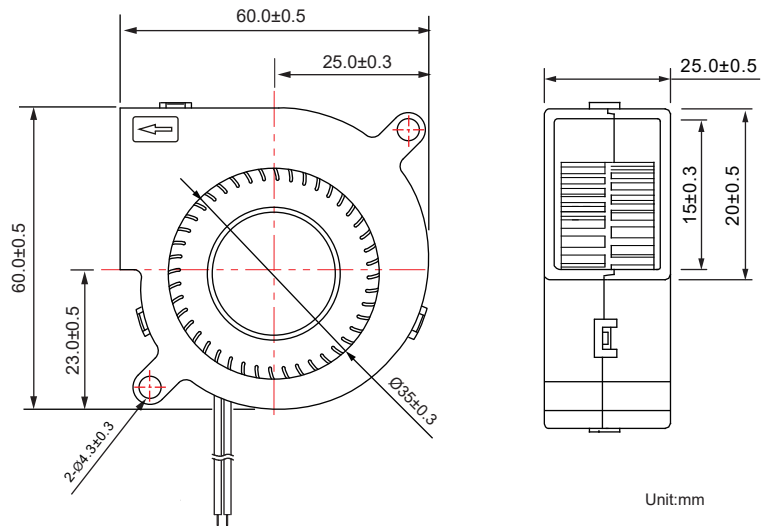

- * 轴承类型: 含油轴承, 双滚珠轴承, 液压轴承
(Bearing type: Sleeve, 2-Ball, Hydraulic)
- * 材料(Material):
框叶(Frame & Impeller): PBT
- * 引线(Lead wire):
UL2468 AWG #26 or equivalent
红色线正级 Red Wire Positive (+)
黑色线负级 Black Wire Negative (-)
- * 可选择增加风扇功能(Functions are optional)
- * 重量(Weight): 54g

■ 风压&风量曲线图 P and Q CURVE

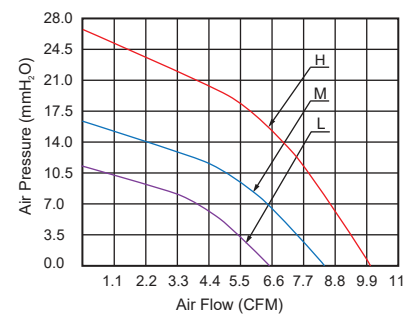

型号 Model	轴承类型 Bearing Type	电压 Rated Voltage	电压范围 Operation Voltage	电流 Current	功率 Input Power	转速 Speed	风量 Air Flow	风压 Static Pressure	噪音 Noise Level
		VDC	VDC	Amp	Watt	RPM	CFM	MM-H ₂ O	dBA
BF6025L12S	Sleeve	12V	10.8~13.2	0.12	1.44	3,500±10%	6.50	10.9	31.0
BF6025L12D	2-Ball								
BF6025L12SH	Hydraulic								
BF6025M12S	Sleeve	12V	10.8~13.2	0.18	2.16	4,500±10%	8.10	16.0	41.0
BF6025M12D	2-Ball								
BF6025M12SH	Hydraulic								
BF6025H12S	Sleeve	12V	10.8~13.2	0.40	4.80	5,500±10%	10.0	26.3	49.3
BF6025H12D	2-Ball								
BF6025H12SH	Hydraulic								
BF6025L24S	Sleeve	24V	21.6~26.4	0.11	2.64	3,500±10%	6.50	10.9	31.0
BF6025L24D	2-Ball								
BF6025L24SH	Hydraulic								
BF6025M24S	Sleeve	24V	21.6~26.4	0.15	3.60	4,500±10%	8.10	16.0	41.0
BF6025M24D	2-Ball								
BF6025M24SH	Hydraulic								
BF6025H24S	Sleeve	24V	21.6~26.4	0.26	6.24	5,500±10%	10.0	26.3	49.3
BF6025H24D	2-Ball								
BF6025H24SH	Hydraulic								

- * 以上为额定电压下的常规参数(All readings are typical values at rated voltage)
- * 规格如有变动不另行通知(Specifications are subjected to change without prior notice)

DC Blower Fan 56x57.5x28mm

■ 尺寸图 (DIMENSION DRAWING)

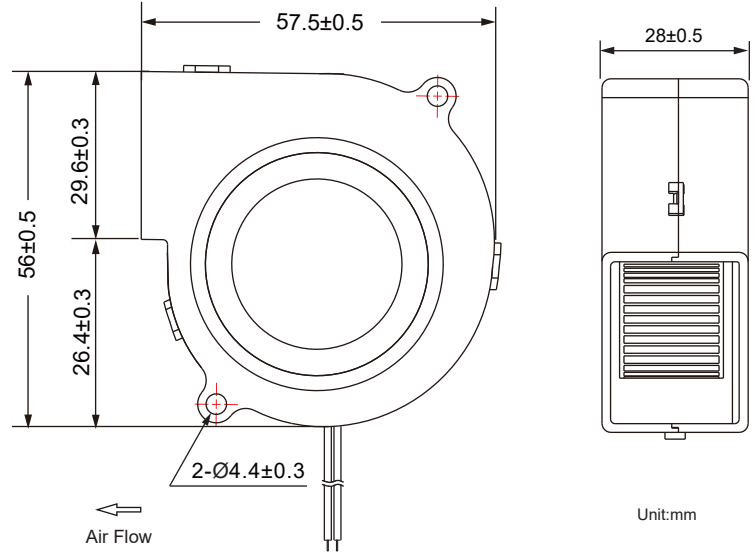
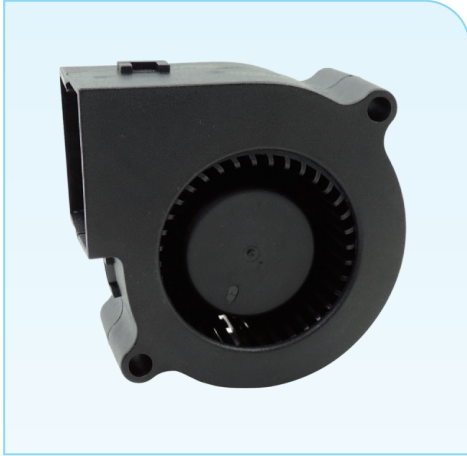

■ 风压&风量曲线图 P and Q CURVE

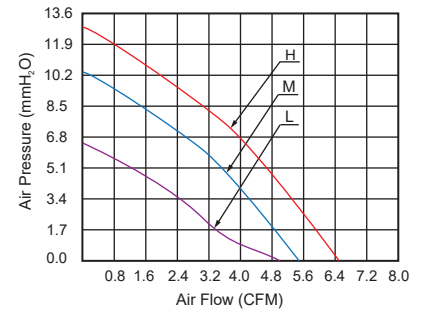

- * 轴承类型: 含油轴承, 双滚珠轴承 (Bearing type:Sleeve,2-Ball)
- * 材料(Material):
框叶(Frame & Impeler):PBT
- * 引线(Lead wire):
UL2468 AWG #26 or equivalent
红色线正级 Red Wire Positive (+)
黑色线负级 Black Wire Negative (-)
- * 可选择增加风扇功能(Functions are optional)
- * 重量(Weight):55g

型号 Model	轴承类型 Bearing Type	版本 Version	电压 Rated Voltage	电流 Current	功率 Input Power	转速 Speed	风量 Air Flow	风压 Static Pressure	噪音 Noise Level
			VDC	Amp	Watt	RPM	CFM	MM-H ₂ O	dBA
BF6028L12S	Sleeve	-A	12V	0.09	1.08	3,000±10%	4.90	6.00	30.7
BF6028L12D	2-Ball								
BF6028M12S	Sleeve	-A	12V	0.12	1.44	4,000±10%	5.30	10.3	35.6
BF6028M12D	2-Ball								
BF6028H12S	Sleeve	-A	12V	0.15	1.80	5,000±10%	6.50	12.4	39.5
BF6028H12D	2-Ball								
BF6028L24S	Sleeve	-A	24V	0.02	0.48	3,000±10%	4.90	6.00	30.7
BF6028L24D	2-Ball								
BF6028M24S	Sleeve	-A	24V	0.04	0.96	4,000±10%	5.30	10.3	35.6
BF6028M24D	2-Ball								
BF6028H24S	Sleeve	-A	24V	0.12	2.88	5,000±10%	6.50	12.4	39.5
BF6028H24D	2-Ball								

- * 以上为额定电压下的常规参数(All readings are typical values at rated voltage)
- * 规格如有变动不另行通知(Specifications are subjected to change without prior notice)

DC Blower Fan 60x60x28mm

■ 尺寸图 (DIMENSION DRAWING)

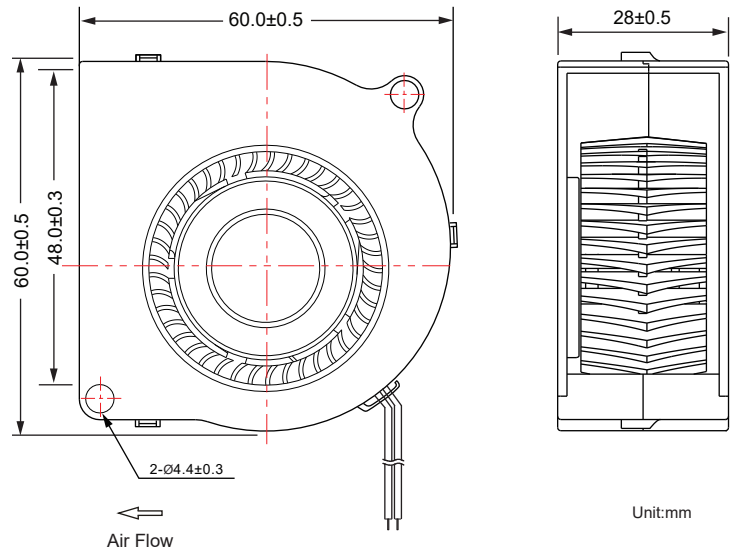
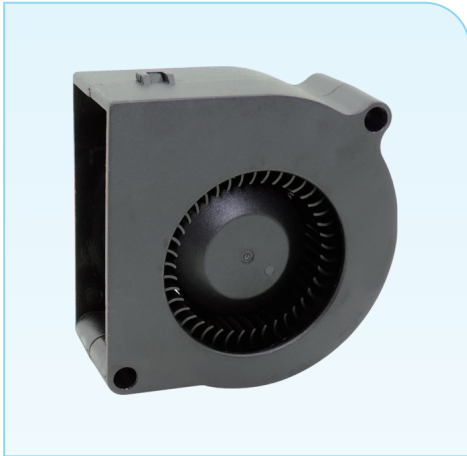

■ 风压&风量曲线图 P and Q CURVE

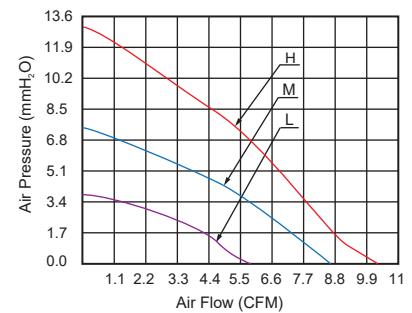

- * 轴承类型: 含油轴承, 双滚珠轴承 (Bearing type:Sleeve,2-Ball)
- * 材料(Material):
框叶(Frame & Impeler):PBT
- * 引线(Lead wire):
UL2468 AWG #26 or equivalent
红色线正级 Red Wire Positive (+)
黑色线负级 Black Wire Negative (-)
- * 可选择增加风扇功能(Functions are optional)
- * 重量(Weight):55g

型号 Model	轴承类型 Bearing Type	版本 Version	电压 Rated Voltage	电流 Current	功率 Input Power	转速 Speed	风量 Air Flow	风压 Static Pressure	噪音 Noise Level
			VDC	Amp	Watt	RPM	CFM	MM-H ₂ O	dBA
BF6028L12S	Sleeve	-B	12V	0.08	0.96	3,000±10%	5.90	3.60	30.5
BF6028L12D	2-Ball								
BF6028M12S	Sleeve	-B	12V	0.12	1.44	4,000±10%	8.10	7.30	40.0
BF6028M12D	2-Ball								
BF6028H12S	Sleeve	-B	12V	0.26	3.12	5,000±10%	10.1	12.8	46.0
BF6028H12D	2-Ball								
BF6028L24S	Sleeve	-B	24V	0.06	1.44	3,000±10%	5.90	3.60	30.5
BF6028L24D	2-Ball								
BF6028M24S	Sleeve	-B	24V	0.07	1.68	4,000±10%	8.10	7.30	40.0
BF6028M24D	2-Ball								
BF6028H24S	Sleeve	-B	24V	0.19	4.56	5,000±10%	10.1	12.8	46.0
BF6028H24D	2-Ball								

- * 以上为额定电压下的常规参数(All readings are typical values at rated voltage)
- * 规格如有变动不另行通知(Specifications are subjected to change without prior notice)

DC Blower Fan 70x64x8mm

■ 尺寸图 (DIMENSION DRAWING)

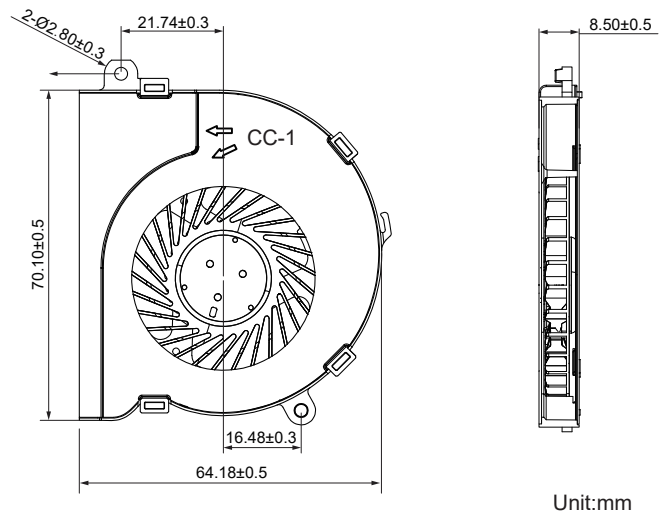

Unit:mm

- * 轴承类型: 液压, 流体动压
(Bearing type: Hydraulic, FDB)
- * 材料 (Material):
扇叶 (Impeller): PBT
框 (Frame): PBT & SGCC & SPCC
- * 引线 (Lead wire):
UL3302 AWG #34 or equivalent
红色线正级 Red Wire Positive (+)
黑色线负级 Black Wire Negative (-)
- * 可选择增加风扇功能 (Functions are optional)
- * 重量 (Weight): 31g

■ 风压&风量曲线图 P and Q CURVE

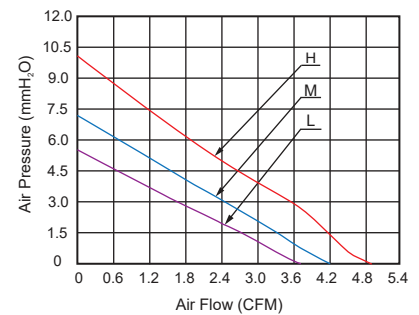

型号 Model	轴承类型 Bearing Type	电压 Rated Voltage	电压范围 Operation Voltage	电流 Current	功率 Input Power	转速 Speed	风量 Air Flow	风压 Static Pressure	噪音 Noise Level
		VDC	VDC	Amp	Watt	RPM	CFM	MM-H ₂ O	dBA
BF7008L05S	Hydraulic	5V	4.5~5.5	0.08	0.40	3,000±10%	3.7	5.40	20
BF7008L05S3	FDB								
BF7008M05S	Hydraulic	5V	4.5~5.5	0.12	0.60	3,500±10%	4.2	7.10	24
BF7008M05S3	FDB								
BF7008H05S	Hydraulic	5V	4.5~5.5	0.20	1.00	4,000±10%	4.9	10.0	28
BF7008H05S3	FDB								
BF7008L12S	Hydraulic	12V	10.8~13.2	0.04	0.48	3,000±10%	3.7	5.40	20
BF7008L12S3	FDB								
BF7008M12S	Hydraulic	12V	10.8~13.2	0.06	0.72	3,500±10%	4.2	7.10	24
BF7008M12S3	FDB								
BF7008H12S	Hydraulic	12V	10.8~13.2	0.08	0.96	4,000±10%	4.9	10.0	28
BF7008H12S3	FDB								

- * 以上为额定电压下的常规参数 (All readings are typical values at rated voltage)
- * 规格如有变动不另行通知 (Specifications are subjected to change without prior notice)

DC Blower Fan 75x75x5mm

■ 尺寸图 (DIMENSION DRAWING)

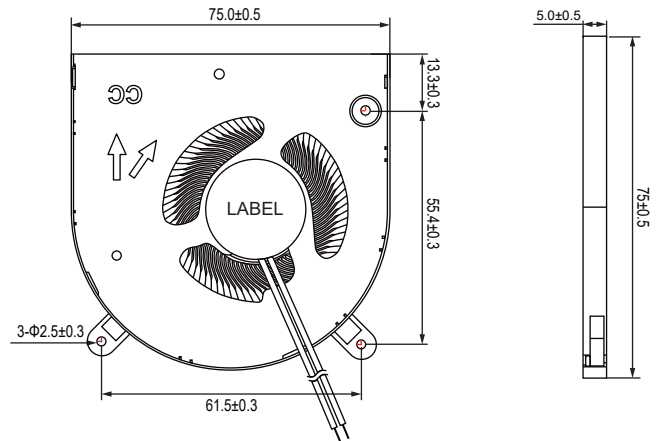
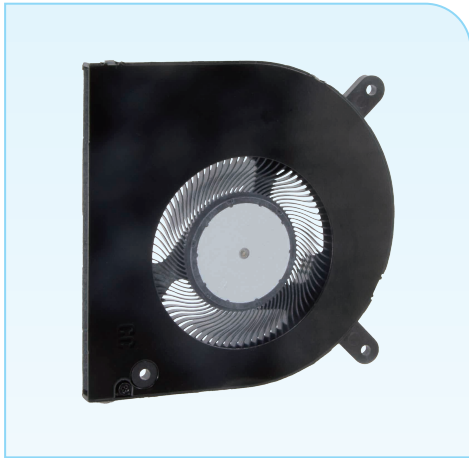

Unit:mm

- * 轴承类型: 液压, 流体动压 (Bearing type: Hydraulic, FDB)
- * 材料 (Material):
扇叶 (Impeller): LCP
框 (Frame): SECC
- * 引线 (Lead wire):
UL1571 AWG #28 or equivalent
红色线正级 Red Wire Positive (+)
黑色线负级 Black Wire Negative (-)
- * 可选择增加风扇功能 (Functions are optional)
- * 重量 (Weight): 34g

■ 风压&风量曲线图 P and Q CURVE

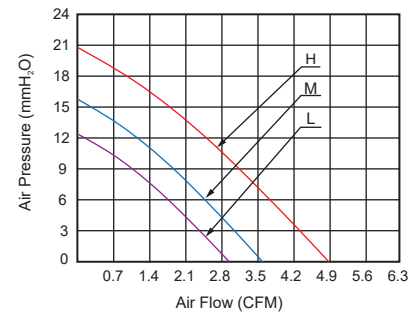

型号 Model	轴承类型 Bearing Type	电压 Rated Voltage	电压范围 Operation Voltage	电流 Current	功率 Input Power	转速 Speed	风量 Air Flow	风压 Static Pressure	噪音 Noise Level
		VDC	VDC	Amp	Watt	RPM	CFM	MM-H ₂ O	dBA
BF7505L05S	Hydraulic	5V	4.5~5.5	0.20	1.00	2,500±10%	3.00	12.5	18.0
BF7505L05S3	FDB								
BF7505M05S	Hydraulic	5V	4.5~5.5	0.30	1.50	3,500±10%	3.60	16.0	23.0
BF7505M05S3	FDB								
BF7505H05S	Hydraulic	5V	4.5~5.5	0.40	2.00	4,500±10%	4.80	20.5	32.0
BF7505H05S3	FDB								
BF7505L12S	Hydraulic	12V	10.8~13.2	0.12	1.44	2,500±10%	3.00	12.5	18.0
BF7505L12S3	FDB								
BF7505M12S	Hydraulic	12V	10.8~13.2	0.15	1.80	3,500±10%	3.60	16.0	23.0
BF7505M12S3	FDB								
BF7505H12S	Hydraulic	12V	10.8~13.2	0.20	2.40	4,500±10%	4.80	20.5	32.0
BF7505H12S3	FDB								

- * 以上为额定电压下的常规参数 (All readings are typical values at rated voltage)
- * 规格如有变动不另行通知 (Specifications are subjected to change without prior notice)

DC Blower Fan 75.5x75.5x9mm

■ 尺寸图 (DIMENSION DRAWING)

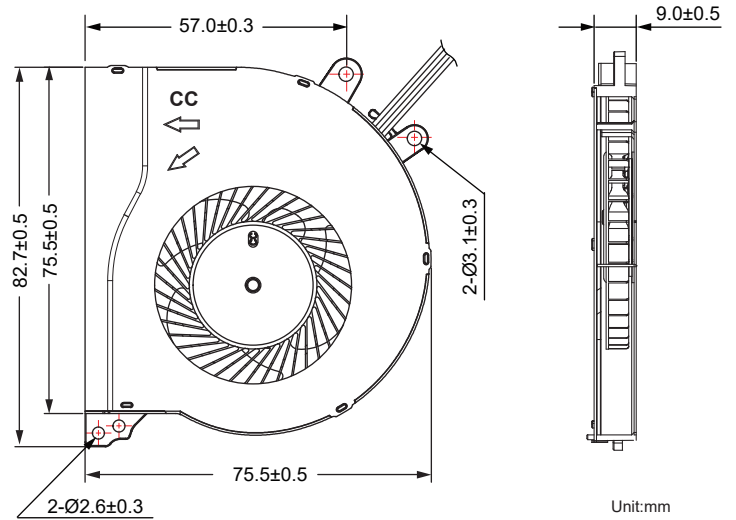

- * 轴承类型: 液压轴承 (Bearing type: Hydraulic)
- * 材料(Material):
扇叶(Impeller): PBT
框(Frame): SECC
- * 引线(Lead wire):
UL1571 AWG #26 or equivalent
红色线正级 Red Wire Positive (+)
黑色线负级 Black Wire Negative (-)
- * 可选择增加风扇功能 (Functions are optional)
- * 重量(Weight): 47g

■ 风压&风量曲线图 P and Q CURVE

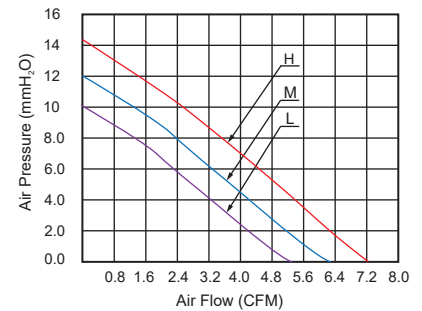

型号 Model	轴承类型 Bearing Type	电压 Rated Voltage	电压范围 Operation Voltage	电流 Current	功率 Input Power	转速 Speed	风量 Air Flow	风压 Static Pressure	噪音 Noise Level
		VDC	VDC	Amp	Watt	RPM	CFM	MM-H ₂ O	dBA
BF7508L05SH	Hydraulic	5V	4.5~5.5	0.20	1.00	2,500±10%	5.20	10.0	24.0
BF7508M05SH	Hydraulic	5V	4.5~5.5	0.27	1.35	3,000±10%	6.20	12.0	29.0
BF7508H05SH	Hydraulic	5V	4.5~5.5	0.41	2.05	3,600±10%	7.20	14.7	35.4

- * 以上为额定电压下的常规参数 (All readings are typical values at rated voltage)
- * 规格如有变动不另行通知 (Specifications are subjected to change without prior notice)

DC Blower Fan 75x75x12mm

■ 尺寸图 (DIMENSION DRAWING)

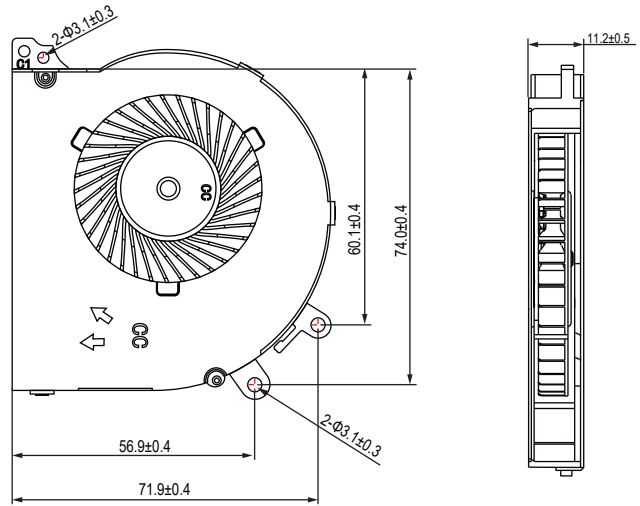
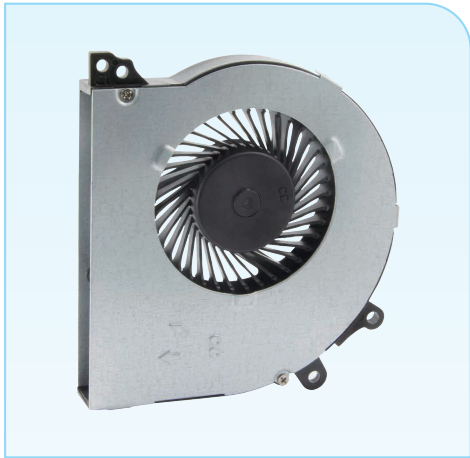

Unit:mm

- * 轴承类型: 流体动压轴承, 双滚珠轴承 (Bearing type:FDB,2-Ball)
- * 材料(Material):
扇叶(Impeller):PBT
框(Frame):PBT & Aluminium
- * 引线(Lead wire):
UL1571 AWG #26 or equivalent
红色线正级 Red Wire Positive (+)
黑色线负级 Black Wire Negative (-)
- * 可选择增加风扇功能(Functions are optional)
- * 重量(Weight):48g

■ 风压&风量曲线图 P and Q CURVE

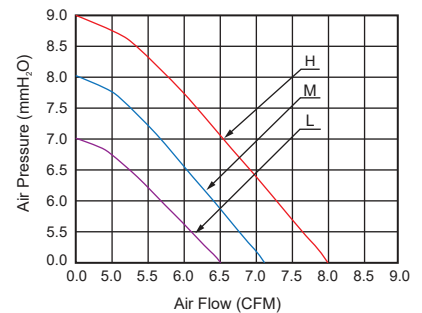

型号 Model	轴承类型 Bearing Type	电压 Rated Voltage	电压范围 Operation Voltage	电流 Current	功率 Input Power	转速 Speed	风量 Air Flow	风压 Static Pressure	噪音 Noise Level
		VDC	VDC	Amp	Watt	RPM	CFM	MM-H ₂ O	dBA
BF7512L05S3	FDB	5V	4.5~5.5	0.30	1.50	2,200±10%	6.50	7.00	24.0
BF7512L05D	2-Ball								
BF7512M05S3	FDB	5V	4.5~5.5	0.38	1.90	2,600±10%	7.10	8.00	28.0
BF7512M05D	2-Ball								
BF7512H05S3	FDB	5V	4.5~5.5	0.43	2.15	3,100±10%	8.00	9.00	31.0
BF7512H05D	2-Ball								
BF7512L12S3	FDB	12V	7~13.2	0.13	1.56	2,200±10%	6.50	7.00	24.0
BF7512L12D	2-Ball								
BF7512M12S3	FDB	12V	7~13.2	0.16	1.92	2,600±10%	7.10	8.00	28.0
BF7512M12D	2-Ball								
BF7512H12S3	FDB	12V	7~13.2	0.19	2.28	3,100±10%	8.00	9.00	32.0
BF7512H12D	2-Ball								

- * 以上为额定电压下的常规参数(All readings are typical values at rated voltage)
- * 规格如有变动不另行通知(Specifications are subjected to change without prior notice)

DC Blower Fan 75x77x16mm

■ 尺寸图 (DIMENSION DRAWING)

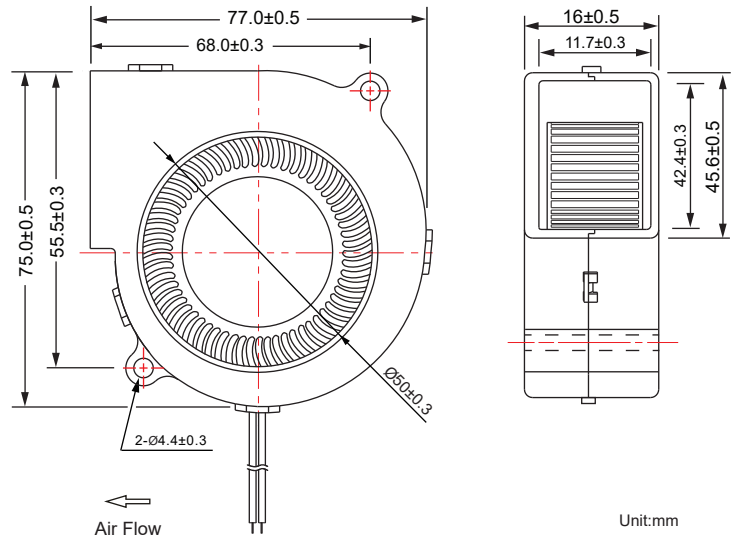

- * 轴承类型: 含油轴承, 双滚珠轴承 (Bearing type:Sleeve,2-Ball)
- * 材料(Material):
框叶(Frame & Impeller):PBT
- * 引线(Lead wire):
UL2468 AWG #26 or equivalent
红色线正级 Red Wire Positive (+)
黑色线负级 Black Wire Negative (-)
- * 可选择增加风扇功能(Functions are optional)
- * 重量(Weight):52g

■ 风压&风量曲线图 P and Q CURVE

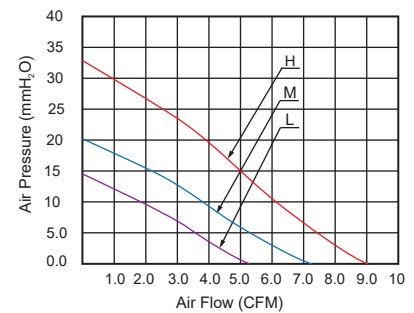

型号 Model	轴承类型 Bearing Type	版本 Version	电压 Rated Voltage	电流 Current	功率 Input Power	转速 Speed	风量 Air Flow	风压 Static Pressure	噪音 Noise Level
			VDC	Amp	Watt	RPM	CFM	MM-H ₂ O	dBA
BF7515L12S	Sleeve	-A	12V	0.14	1.68	2,500±10%	5.10	14.0	30.0
BF7515L12D	2-Ball								
BF7515M12S	Sleeve	-A	12V	0.20	2.40	3,500±10%	7.20	20.0	35.0
BF7515M12D	2-Ball								
BF7515H12S	Sleeve	-A	12V	0.37	4.44	4,500±10%	9.00	32.3	40.0
BF7515H12D	2-Ball								

- * 以上为额定电压下的常规参数(All readings are typical values at rated voltage)
- * 规格如有变动不另行通知(Specifications are subjected to change without prior notice)

DC Blower Fan 75x70x15mm

■ 尺寸图 (DIMENSION DRAWING)

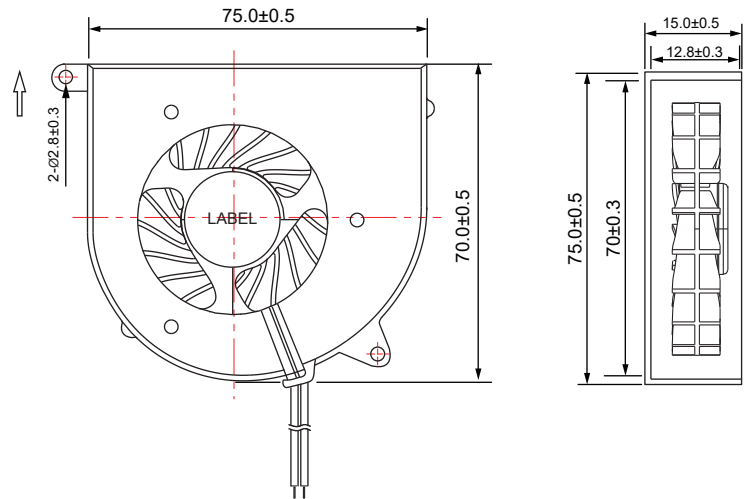

Unit:mm

- * 轴承类型: 含油轴承, 双滚珠轴承, 液压轴承
(Bearing type:Sleeve,2-Ball,Hydraulic)
- * 材料(Material):
扇叶(Impeller):PBT
框(Frame):PBT & SECC
- * 引线(Lead wire):
UL1571 AWG #28 or equivalent
红色线正级 Red Wire Positive (+)
黑色线负级 Black Wire Negative (-)
- * 可选择增加风扇功能(Functions are optional)
- * 重量(Weight):45g

■ 风压&风量曲线图 P and Q CURVE

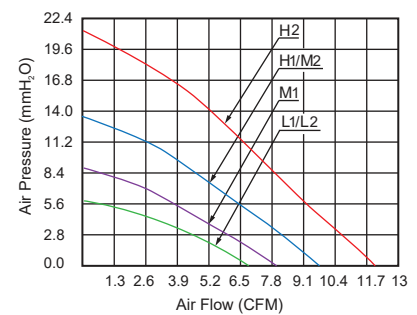

型号 Model	轴承类型 Bearing Type	版本 Version	电压 Rated Voltage	电流 Current	功率 Input Power	转速 Speed	风量 Air Flow	风压 Static Pressure	噪音 Noise Level
			VDC	Amp	Watt	RPM	CFM	MM-H ₂ O	dBA
BF7515L05S	Sleeve	-B	5V	0.10	0.50	2,500±10%	6.80	5.70	26.0
BF7515L05D	2-Ball								
BF7515L05SH	Hydraulic								
BF7515M05S	Sleeve	-B	5V	0.25	1.25	3,000±10%	7.90	8.90	31.0
BF7515M05D	2-Ball								
BF7515M05SH	Hydraulic								
BF7515H05S	Sleeve	-B	5V	0.43	2.15	3,500±10%	9.70	13.1	36.0
BF7515H05D	2-Ball								
BF7515H05SH	Hydraulic								
BF7515L12S	Sleeve	-B	12V	0.10	1.20	2,500±10%	6.80	5.70	26.0
BF7515L12D	2-Ball								
BF7515L12SH	Hydraulic								
BF7515M12S	Sleeve	-B	12V	0.17	2.04	3,500±10%	9.70	13.1	36.0
BF7515M12D	2-Ball								
BF7515M12SH	Hydraulic								
BF7515H12S	Sleeve	-B	12V	0.32	3.84	4,300±10%	12.0	21.0	42.0
BF7515H12D	2-Ball								
BF7515H12SH	Hydraulic								

- * 以上为额定电压下的常规参数(All readings are typical values at rated voltage)
- * 规格如有变动不另行通知(Specifications are subjected to change without prior notice)

DC Blower Fan 82x74x25mm

■ 尺寸图 (DIMENSION DRAWING)

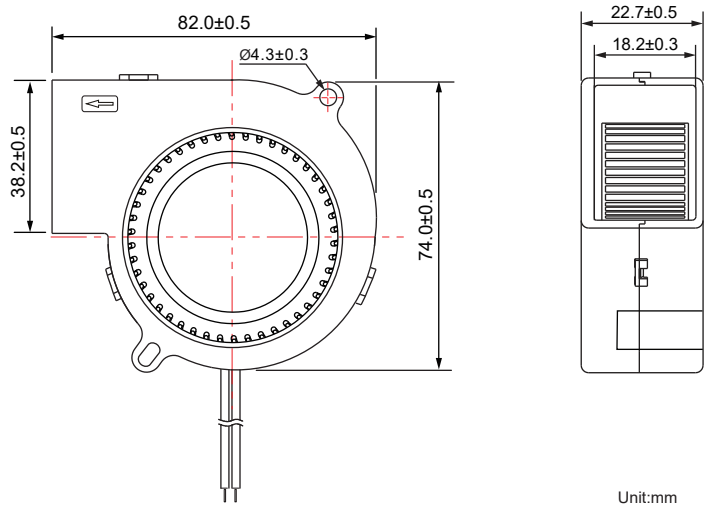
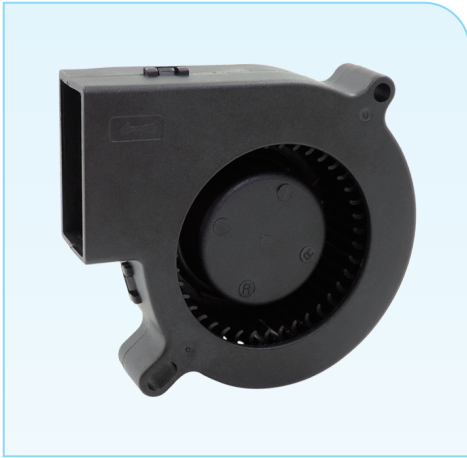

- * 轴承类型: 含油轴承, 双滚珠轴承 (Bearing type:Sleeve,2-Ball)
- * 材料(Material):
框叶(Frame & Impeler):PBT
- * 引线(Lead wire):
UL2468 AWG #26 or equivalent
红色线正级 Red Wire Positive (+)
黑色线负级 Black Wire Negative (-)
- * 可选择增加风扇功能(Functions are optional)
- * 重量(Weight):65g

■ 风压&风量曲线图 P and Q CURVE

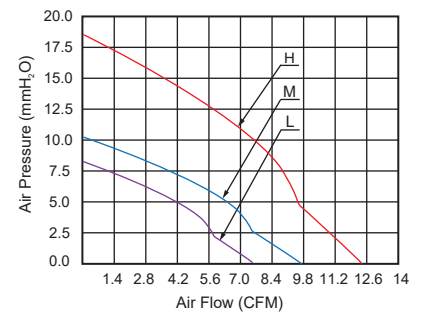

型号 Model	轴承类型 Bearing Type	电压 Rated Voltage	电压范围 Operation Voltage	电流 Current	功率 Input Power	转速 Speed	风量 Air Flow	风压 Static Pressure	噪音 Noise Level
		VDC	VDC	Amp	Watt	RPM	CFM	MM-H ₂ O	dBA
BF7525L12S	Sleeve	12V	10.8~13.2	0.13	1.56	2,800±10%	7.50	8.10	33.0
BF7525L12D	2-Ball								
BF7525M12S	Sleeve	12V	10.8~13.2	0.22	2.64	3,500±10%	9.30	10.1	41.0
BF7525M12D	2-Ball								
BF7525H12S	Sleeve	12V	10.8~13.2	0.35	4.20	4,400±10%	12.2	18.8	47.6
BF7525H12D	2-Ball								

- * 以上为额定电压下的常规参数(All readings are typical values at rated voltage)
- * 规格如有变动不另行通知(Specifications are subjected to change without prior notice)

DC Blower Fan 75x75x30mm

■ 尺寸图 (DIMENSION DRAWING)

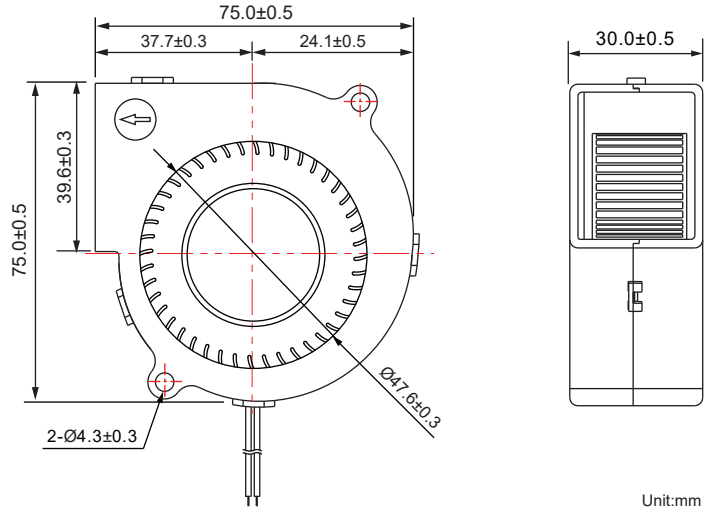
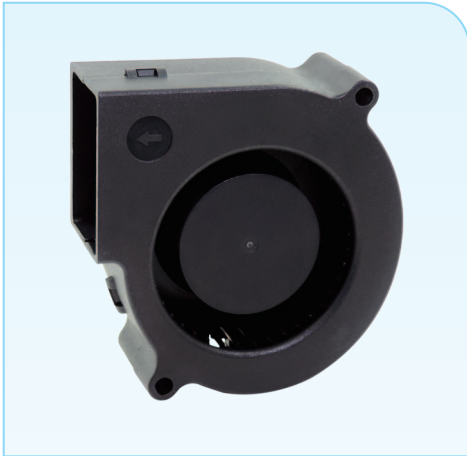

Unit:mm

- * 轴承类型: 含油轴承, 双滚珠轴承, 液压轴承
(Bearing type:Sleeve,2-Ball,Hydraulic)
- * 材料(Material):
框叶(Frame & Impeler):PBT
- * 引线(Lead wire):
UL2468 AWG #26 or equivalent
红色线正级 Red Wire Positive (+)
黑色线负级 Black Wire Negative (-)
- * 可选择增加风扇功能(Functions are optional)
- * 重量(Weight):77g

■ 风压&风量曲线图 P and Q CURVE

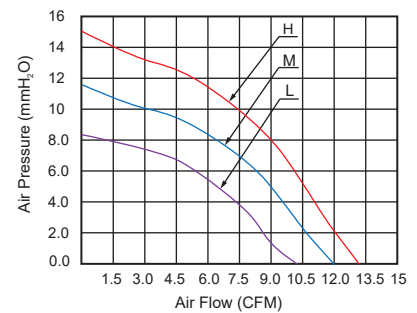

型号 Model	轴承类型 Bearing Type	版本 Version	电压 Rated Voltage	电流 Current	功率 Input Power	转速 Speed	风量 Air Flow	风压 Static Pressure	噪音 Noise Level
			VDC	Amp	Watt	RPM	CFM	MM-H ₂ O	dBA
BF7530L12S	Sleeve	-A	12V	0.08	0.96	2,800±10%	10.0	8.20	35.4
BF7530L12D	2-Ball								
BF7530L12SH	Hydraulic								
BF7530M12S	Sleeve	-A	12V	0.23	2.76	3,300±10%	12.0	11.5	41.6
BF7530M12D	2-Ball								
BF7530M12SH	Hydraulic								
BF7530H12S	Sleeve	-A	12V	0.42	5.04	3,800±10%	13.0	15.0	45.7
BF7530H12D	2-Ball								
BF7530H12SH	Hydraulic								
BF7530L24S	Sleeve	-A	24V	0.05	1.20	2,800±10%	10.0	8.20	35.4
BF7530L24D	2-Ball								
BF7530L24SH	Hydraulic								
BF7530M24S	Sleeve	-A	24V	0.12	2.88	3,000±10%	12.0	11.5	41.6
BF7530M24D	2-Ball								
BF7530M24SH	Hydraulic								
BF7530H24S	Sleeve	-A	24V	0.20	4.80	3,800±10%	13.0	15.0	45.7
BF7530H24D	2-Ball								
BF7530H24SH	Hydraulic								

- * 以上为额定电压下的常规参数(All readings are typical values at rated voltage)
- * 规格如有变动不另行通知(Specifications are subjected to change without prior notice)

DC Blower Fan 75x75.7x30mm

■ 尺寸图 (DIMENSION DRAWING)

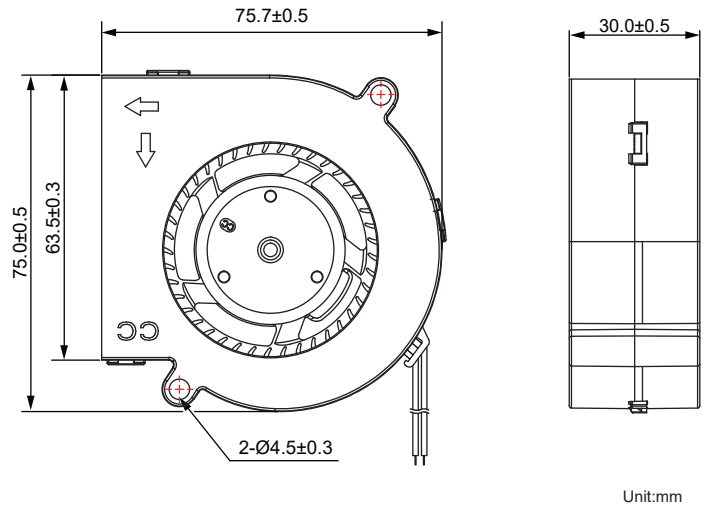

Unit:mm

- * 轴承类型: 液压轴承 (Bearing type:Hydraulic)
- * 材料(Material):
框叶(Frame & Impeler):PBT
- * 引线(Lead wire):
UL2468 AWG #26 or equivalent
红色线正级 Red Wire Positive (+)
黑色线负级 Black Wire Negative (-)
- * 可选择增加风扇功能(Functions are optional)
- * 重量(Weight):75g

■ 风压&风量曲线图 P and Q CURVE

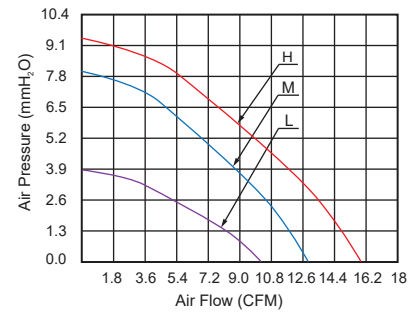

型号 Model	轴承类型 Bearing Type	版本 Version	电压 Rated Voltage	电流 Current	功率 Input Power	转速 Speed	风量 Air Flow	风压 Static Pressure	噪音 Noise Level
			VDC	Amp	Watt	RPM	CFM	MM-H ₂ O	dBA
BF7530L12SH	Hydraulic	-B	12V	0.12	1.44	2,000±10%	9.80	3.90	29.5
BF7515M12SH	Hydraulic	-B	12V	0.18	2.16	2,500±10%	13.0	7.90	37.0
BF7515H12SH	Hydraulic	-B	12V	0.25	3.00	3,000±10%	15.6	9.50	44.5

- * 以上为额定电压下的常规参数(All readings are typical values at rated voltage)
- * 规格如有变动不另行通知(Specifications are subjected to change without prior notice)

DC Blower Fan 75x75x30mm

■ 尺寸图 (DIMENSION DRAWING)

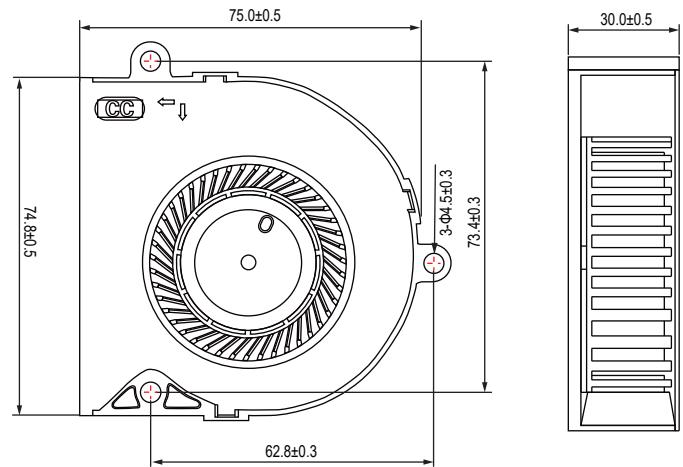

Unit:mm

- * 轴承类型: 含油轴承, 双滚珠轴承 (Bearing type:Sleeve,2-Ball)
- * 材料(Material):
扇叶(Impeller):PBT
框(Frame):PBT & Aluminium
- * 引线(Lead wire):
UL2468 AWG #28 or equivalent
红色线正级 Red Wire Positive (+)
黑色线负级 Black Wire Negative (-)
- * 可选择增加风扇功能(Functions are optional)
- * 重量(Weight):87g

■ 风压&风量曲线图 P and Q CURVE

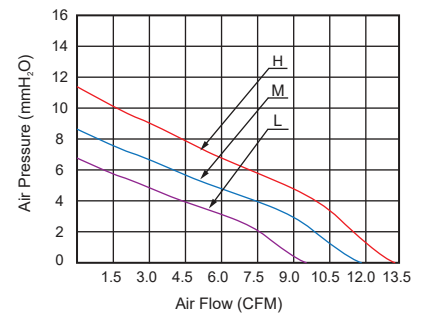

型号 Model	轴承类型 Bearing Type	版本 Version	电压 Rated Voltage	电流 Current	功率 Input Power	转速 Speed	风量 Air Flow	风压 Static Pressure	噪音 Noise Level
			VDC	Amp	Watt	RPM	CFM	MM-H ₂ O	dBA
BF7530L05S	Sleeve	-C	5V	0.45	2.25	2,000±10%	9.40	6.80	25.0
BF7530L05D	2-Ball								
BF7530M05S	Sleeve	-C	5V	0.50	2.50	2,500±10%	11.50	8.50	33.0
BF7530M05D	2-Ball								
BF7530H05S	Sleeve	-C	5V	0.60	3.00	3,400±10%	13.40	11.00	37.0
BF7530H05D	2-Ball								
BF7530L12S	Sleeve	-C	12V	0.18	2.16	2,000±10%	9.40	6.80	25.0
BF7530L12D	2-Ball								
BF7530M12S	Sleeve	-C	12V	0.25	3.00	2,500±10%	11.50	8.50	33.0
BF7530M12D	2-Ball								
BF7530H12S	Sleeve	-C	12V	0.33	3.96	3,400±10%	13.40	11.00	37.0
BF7530H12D	2-Ball								

- * 以上为额定电压下的常规参数(All readings are typical values at rated voltage)
- * 规格如有变动不另行通知(Specifications are subjected to change without prior notice)

DC Blower Fan 80x75x10mm

■ 尺寸图 (DIMENSION DRAWING)

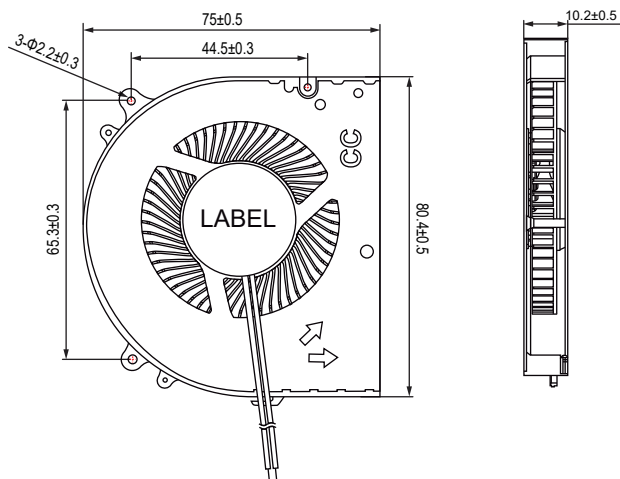

- * 轴承类型: 双滚珠, 流体动压, 液压
(Bearing type: 2-Ball, FDB, Hydraulic)
- * 材料(Material):
扇叶(Impeller): LCP
框(Frame): SECC
- * 引线(Lead wire):
UL1571 AWG #28 or equivalent
红色线正级 Red Wire Positive (+)
黑色线负级 Black Wire Negative (-)
- * 可选择增加风扇功能(Functions are optional)
- * 重量(Weight): 50g

■ 风压&风量曲线图 P and Q CURVE

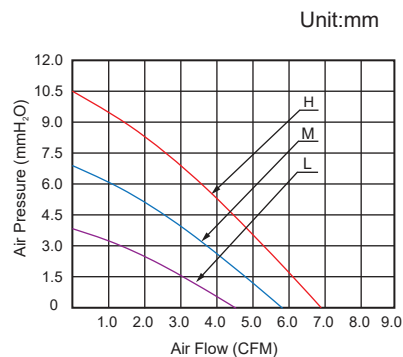

型号 Model	轴承类型 Bearing Type	电压 Rated Voltage	电压范围 Operation Voltage	电流 Current	功率 Input Power	转速 Speed	风量 Air Flow	风压 Static Pressure	噪音 Noise Level
		VDC	VDC	Amp	Watt	RPM	CFM	MM-H ₂ O	dBA
BF8010L05D	2-Ball	5V	4.5~5.5	0.09	0.45	2,000±10%	4.40	4.00	19.0
BF8010L05S3	FDB								
BF8010L05SH	Hydraulic								
BF8010M05D	2-Ball	5V	4.5~5.5	0.16	0.80	2,500±10%	5.60	6.80	23.5
BF8010M05S3	FDB								
BF8010M05SH	Hydraulic								
BF8010H05D	2-Ball	5V	4.5~5.5	0.29	1.45	3,000±10%	6.80	10.5	30.0
BF8010H05S3	FDB								
BF8010H05SH	Hydraulic								
BF8010L12D	2-Ball	12V	10.8~13.2	0.04	0.48	2,000±10%	4.40	4.00	19.0
BF8010L12S3	FDB								
BF8010L12SH	Hydraulic								
BF8010M12D	2-Ball	12V	10.8~13.2	0.07	0.84	2,500±10%	5.60	6.80	23.5
BF8010M12S3	FDB								
BF8010M12SH	Hydraulic								
BF8010H12D	2-Ball	12V	10.8~13.2	0.15	1.80	3,000±10%	6.80	10.5	30.0
BF8010H12S3	FDB								
BF8010H12SH	Hydraulic								

* 以上为额定电压下的常规参数(All readings are typical values at rated voltage)
* 规格如有变动不另行通知(Specifications are subjected to change without prior notice)

DC Axial Fan 80x80x17.5mm

■ 尺寸图 (DIMENSION DRAWING)

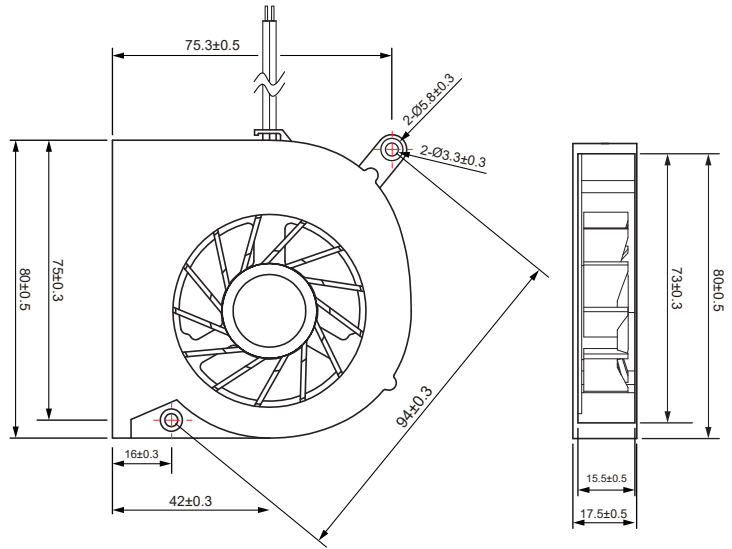

- * 轴承类型: 含油轴承, 双滚珠轴承 (Bearing type:Sleeve,2-Ball)
- * 材料(Material):
扇叶(Impeller):PBT
框(Frame):PBT & SECC
- * 引线(Lead wire):
UL1061 AWG #28 or equivalent
红色线正级 Red Wire Positive (+)
黑色线负级 Black Wire Negative (-)
- * 可选择增加风扇功能(Functions are optional)
- * 重量(Weight):55g

■ 风压&风量曲线图 P and Q CURVE

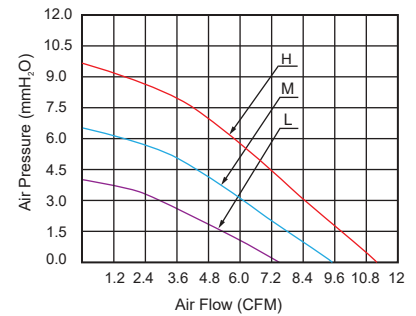

型号 Model	轴承类型 Bearing Type	电压 Rated Voltage	电压范围 Operation Voltage	电流 Current	功率 Input Power	转速 Speed	风量 Air Flow	风压 Static Pressure	噪音 Noise Level
		VDC	VDC	Amp	Watt	RPM	CFM	MM-H ₂ O	dBA
BF8018L05S	Sleeve	5V	4.5~5.5	0.15	0.75	2,000±10%	7.40	3.80	21.0
BF8018L05D	2-Ball								
BF8018M05S	Sleeve	5V	4.5~5.5	0.25	1.25	2,500±10%	9.40	6.30	26.5
BF8018M05D	2-Ball								
BF8018H05S	Sleeve	5V	4.5~5.5	0.40	2.00	3,000±10%	11.0	9.50	32.0
BF8018H05D	2-Ball								
BF8018L12S	Sleeve	12V	10.8~13.2	0.08	0.96	2,000±10%	7.40	3.80	21.0
BF8018L12D	2-Ball								
BF8018M12S	Sleeve	12V	10.8~13.2	0.12	1.44	2,500±10%	9.40	6.30	26.5
BF8018M12D	2-Ball								
BF8018H12S	Sleeve	12V	10.8~13.2	0.25	3.00	3,000±10%	11.0	9.50	32.0
BF8018H12D	2-Ball								

- * 以上为额定电压下的常规参数(All readings are typical values at rated voltage)
- * 规格如有变动不另行通知(Specifications are subjected to change without prior notice)

DC Blower Fan 81x80x21.5mm

■ 尺寸图 (DIMENSION DRAWING)

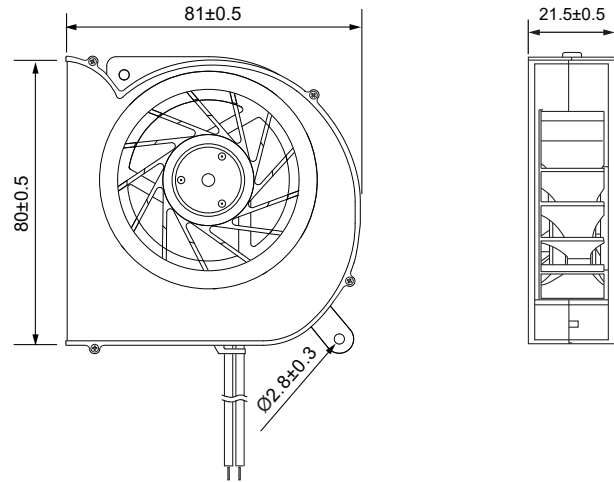

Unit:mm

- * 轴承类型: 含油轴承, 双滚珠轴承 (Bearing type:Sleeve,2-Ball)
- * 材料(Material):
扇叶(Impeller):PBT
框(Frame):PBT & Aluminium
- * 引线(Lead wire):
UL2468 AWG #26 or equivalent
红色线正级 Red Wire Positive (+)
黑色线负级 Black Wire Negative (-)
- * 可选择增加风扇功能(Functions are optional)
- * 重量(Weight):43g

■ 风压&风量曲线图 P and Q CURVE

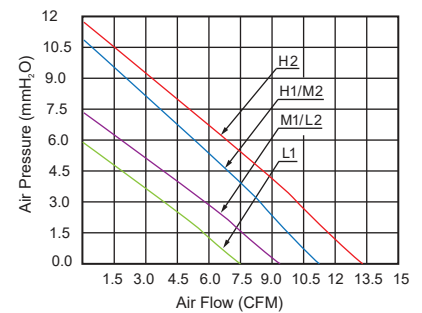

型号 Model	轴承类型 Bearing Type	版本 Version	电压 Rated Voltage	电流 Current	功率 Input Power	转速 Speed	风量 Air Flow	风压 Static Pressure	噪音 Noise Level
			VDC	Amp	Watt	RPM	CFM	MM-H ₂ O	dBA
BF8020L05S	Sleeve	A	5V	0.14	0.70	2,000±10%	7.50	5.80	21.0
BF8020L05D	2-Ball								
BF8020M05S	Sleeve	A	5V	0.21	1.05	2,500±10%	10.9	10.7	26.0
BF8020M05D	2-Ball								
BF8020H05S	Sleeve	A	5V	0.33	1.65	3,000±10%	13.0	11.5	32.0
BF8020H05D	2-Ball								
BF8020L12S	Sleeve	A	12V	0.18	2.16	2,500±10%	9.30	7.30	26.0
BF8020L12D	2-Ball								
BF8020M12S	Sleeve	A	12V	0.22	2.64	3,000±10%	10.9	10.7	32.0
BF8020M12D	2-Ball								
BF8020H12S	Sleeve	A	12V	0.26	3.12	3,500±10%	13.0	11.5	38.0
BF8020H12D	2-Ball								

- * 以上为额定电压下的常规参数(All readings are typical values at rated voltage)
- * 规格如有变动不另行通知(Specifications are subjected to change without prior notice)

DC Blower Fan 88x83x21.5mm

■ 尺寸图 (DIMENSION DRAWING)

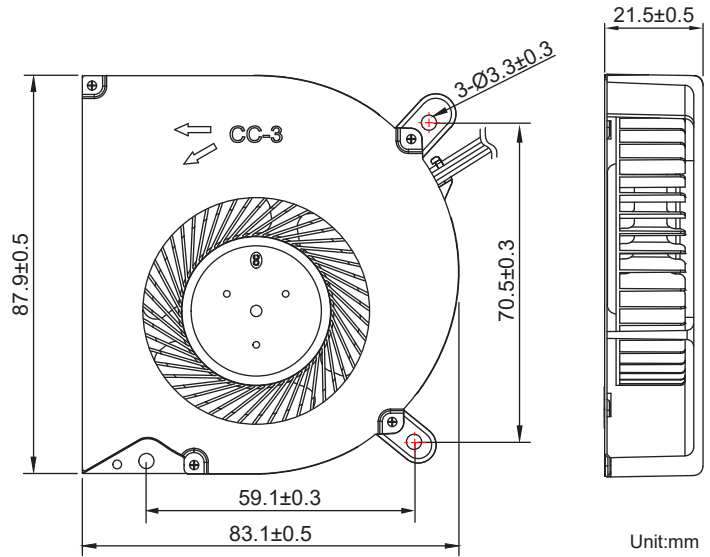

- * 轴承类型: 双滚珠, 流体动压轴承 (Bearing type: 2-Ball, FDB)
- * 材料(Material):
扇叶(Impeller): LCP
框(Frame): PBT+SPCC
- * 引线(Lead wire):
UL1061 AWG #26 or equivalent
红色线正级 Red Wire Positive (+)
黑色线负级 Black Wire Negative (-)
- * 可选择增加风扇功能(Functions are optional)
- * 重量(Weight): 85g

■ 风压&风量曲线图 P and Q CURVE

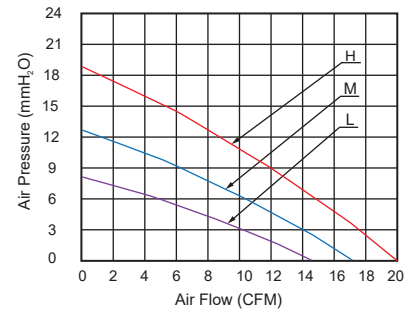

型号 Model	轴承类型 Bearing Type	版本 Version	电压 Rated Voltage	电流 Current	功率 Input Power	转速 Speed	风量 Air Flow	风压 Static Pressure	噪音 Noise Level
			VDC	Amp	Watt	RPM	CFM	MM-H ₂ O	dBA
BF8020L05D	2-Ball	-B	5V	0.27	1.35	2,500±10%	14.2	7.90	31.0
BF8020L05S3	FDB								
BF8020M05D	2-Ball	-B	5V	0.45	2.25	3,000±10%	16.9	12.4	36.4
BF8020M05S3	FDB								
BF8020H05D	2-Ball	-B	5V	0.90	4.50	3,500±10%	20.0	19.0	41.0
BF8020H05S3	FDB								
BF8020L12D	2-Ball	-B	12V	0.15	1.80	2,500±10%	14.2	7.90	31.0
BF8020L12S3	FDB								
BF8020M12D	2-Ball	-B	12V	0.25	3.00	3,000±10%	16.9	12.4	36.4
BF8020M12S3	FDB								
BF8020H12D	2-Ball	-B	12V	0.45	5.40	3,500±10%	20.0	19.0	41.0
BF8020H12S3	FDB								

- * 以上为额定电压下的常规参数(All readings are typical values at rated voltage)
- * 规格如有变动不另行通知(Specifications are subjected to change without prior notice)

DC Blower Fan 76.5x76.5x25mm

■ 尺寸图 (DIMENSION DRAWING)

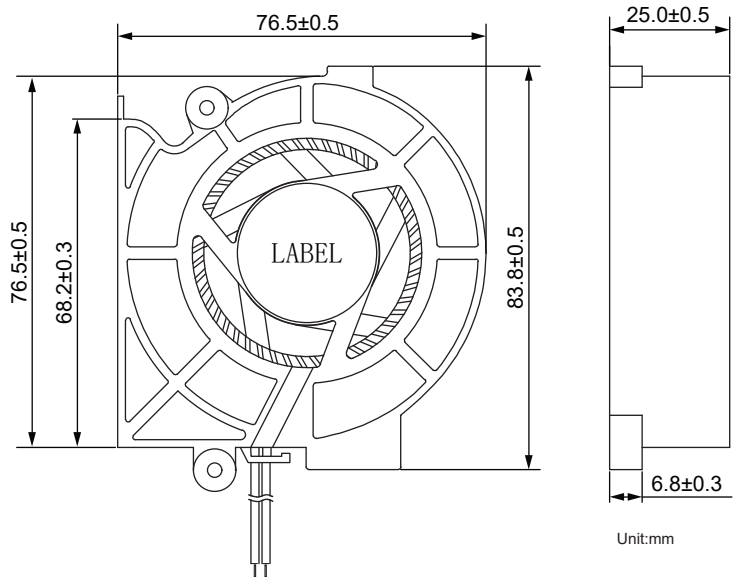
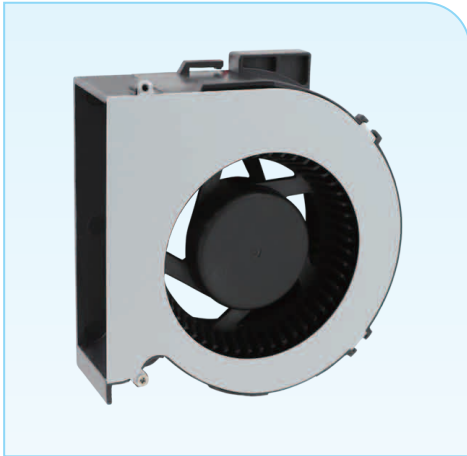

- * 轴承类型: 双滚珠, 液压轴承
(Bearing type: 2-Ball, Hydraulic)
- * 材料(Material):
扇叶(Impeller): PBT
框(Frame): PBT+SECC
- * 引线(Lead wire):
UL1571 AWG #26 or equivalent
红色线正级 Red Wire Positive (+)
黑色线负级 Black Wire Negative (-)
- * 可选择增加风扇功能(Functions are optional)
- * 重量(Weight): 66g

■ 风压&风量曲线图 P and Q CURVE

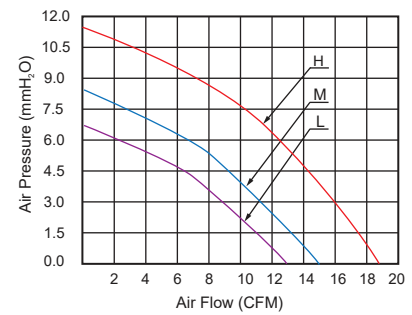

型号 Model	轴承类型 Bearing Type	电压 Rated Voltage	电压范围 Operation Voltage	电流 Current	功率 Input Power	转速 Speed	风量 Air Flow	风压 Static Pressure	噪音 Noise Level
		VDC	VDC	Amp	Watt	RPM	CFM	MM-H ₂ O	dBA
BF8025L12D	2-Ball	12V	10.8~13.2	0.13	1.56	2,500±10%	12.5	6.40	29.0
BF8025L12SH	Hydraulic								
BF8025M12D	2-Ball	12V	10.8~13.2	0.24	2.88	3,000±10%	14.7	8.30	35.0
BF8025M12SH	Hydraulic								
BF8025H12D	2-Ball	12V	10.8~13.2	0.42	5.04	3,500±10%	18.7	11.4	40.0
BF8025H12SH	Hydraulic								

- * 以上为额定电压下的常规参数(All readings are typical values at rated voltage)
- * 规格如有变动不另行通知(Specifications are subjected to change without prior notice)

DC Blower Fan 80x80x30mm

■ 尺寸图 (DIMENSION DRAWING)

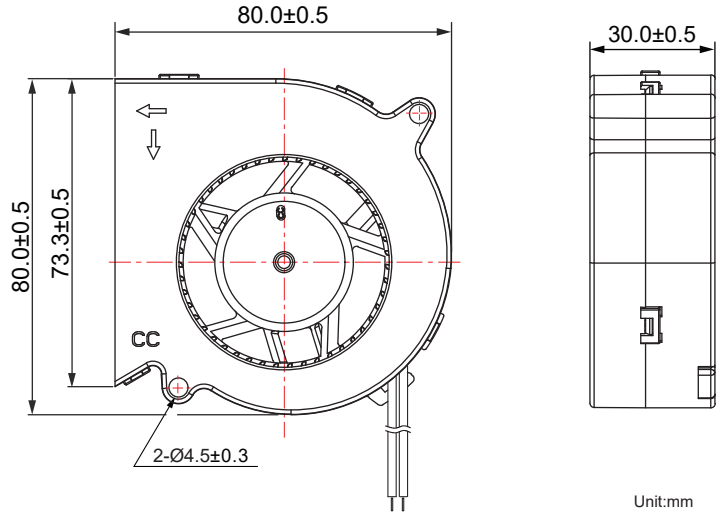

- * 轴承类型: 含油轴承, 双滚珠轴承 (Bearing type:Sleeve,2-Ball)
- * 材料(Material):
框叶(Frame & Impeler):PBT
- * 引线(Lead wire):
UL2468 AWG #26 or equivalent
红色线正级 Red Wire Positive (+)
黑色线负级 Black Wire Negative (-)
- * 可选择增加风扇功能(Functions are optional)
- * 重量(Weight):78g

■ 风压&风量曲线图 P and Q CURVE

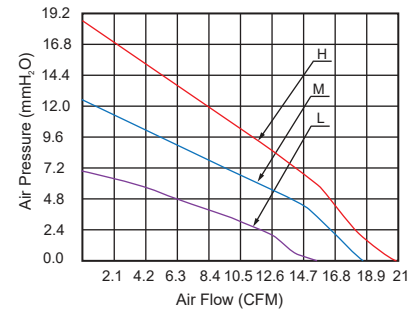

型号 Model	轴承类型 Bearing Type	电压 Rated Voltage	电压范围 Operation Voltage	电流 Current	功率 Input Power	转速 Speed	风量 Air Flow	风压 Static Pressure	噪音 Noise Level
		VDC	VDC	Amp	Watt	RPM	CFM	MM-H ₂ O	dBA
BF8030L12S	Sleeve	12V	10.8~13.2	0.23	2.76	2,000±10%	15.2	6.90	29.5
BF8030L12D	2-Ball								
BF8030M12S	Sleeve	12V	10.8~13.2	0.32	3.84	2,500±10%	18.1	12.9	35.3
BF8030M12D	2-Ball								
BF8030H12S	Sleeve	12V	10.8~13.2	0.42	5.04	3,000±10%	20.8	18.9	42.3
BF8030H12D	2-Ball								

- * 以上为额定电压下的常规参数(All readings are typical values at rated voltage)
- * 规格如有变动不另行通知(Specifications are subjected to change without prior notice)

DC Blower Fan 80x80x40mm

■ 尺寸图 (DIMENSION DRAWING)

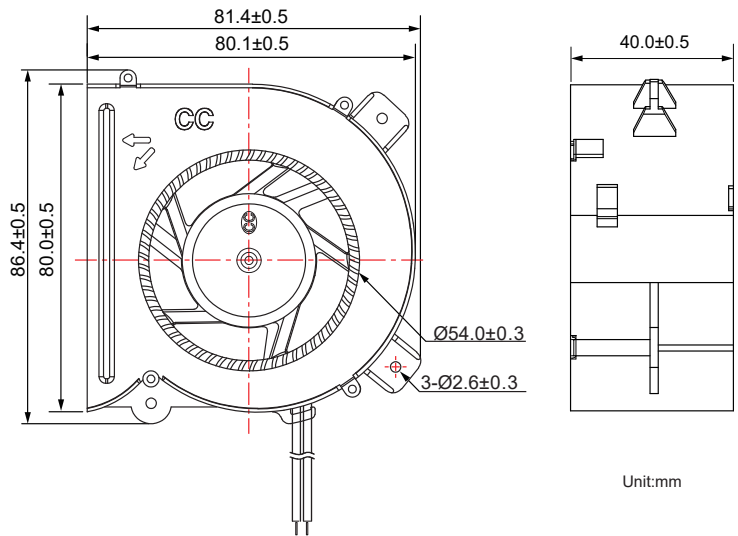
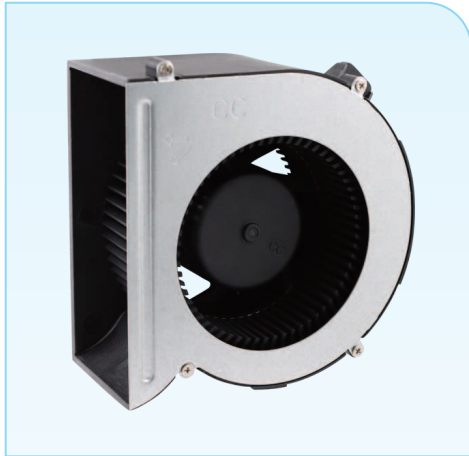

- * 轴承类型: 含油轴承, 双滚珠轴承 (Bearing type: Sleeve, 2-Ball)
- * 材料(Material):
扇叶(Impeller): PBT
框(Frame): PBT & Stainless Steel
- * 引线(Lead wire):
UL2468 AWG #26 or equivalent
红色线正级 Red Wire Positive (+)
黑色线负级 Black Wire Negative (-)
- * 可选择增加风扇功能(Functions are optional)
- * 重量(Weight): 112g

■ 风压&风量曲线图 P and Q CURVE

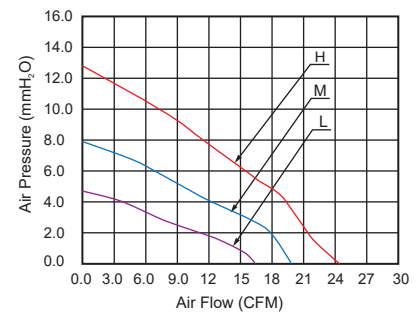

型号 Model	轴承类型 Bearing Type	电压 Rated Voltage	电压范围 Operation Voltage	电流 Current	功率 Input Power	转速 Speed	风量 Air Flow	风压 Static Pressure	噪音 Noise Level
		VDC	VDC	Amp	Watt	RPM	CFM	MM-H ₂ O	dBA
BF8040L12S	Sleeve	12V	10.8~13.2	0.14	1.68	2,000±10%	16.1	4.6	24.4
BF8040L12D	2-Ball								
BF8040M12S	Sleeve	12V	10.8~13.2	0.30	3.60	2,500±10%	19.2	7.9	32.0
BF8040M12D	2-Ball								
BF8040H12S	Sleeve	12V	10.8~13.2	0.40	4.80	3,000±10%	24.1	12.7	37.3
BF8040H12D	2-Ball								
BF8040L24S	Sleeve	24V	21.6~26.4	0.08	1.92	2,000±10%	16.1	4.6	24.4
BF8040L24D	2-Ball								
BF8040M24S	Sleeve	24V	21.6~26.4	0.15	3.60	2,500±10%	19.2	7.9	32.0
BF8040M24D	2-Ball								
BF8040H24S	Sleeve	24V	21.6~26.4	0.20	4.80	3,000±10%	24.1	12.7	37.3
BF8040H24D	2-Ball								

- * 以上为额定电压下的常规参数(All readings are typical values at rated voltage)
- * 规格如有变动不另行通知(Specifications are subjected to change without prior notice)

DC Blower Fan 85x77.6x12mm

■ 尺寸图 (DIMENSION DRAWING)

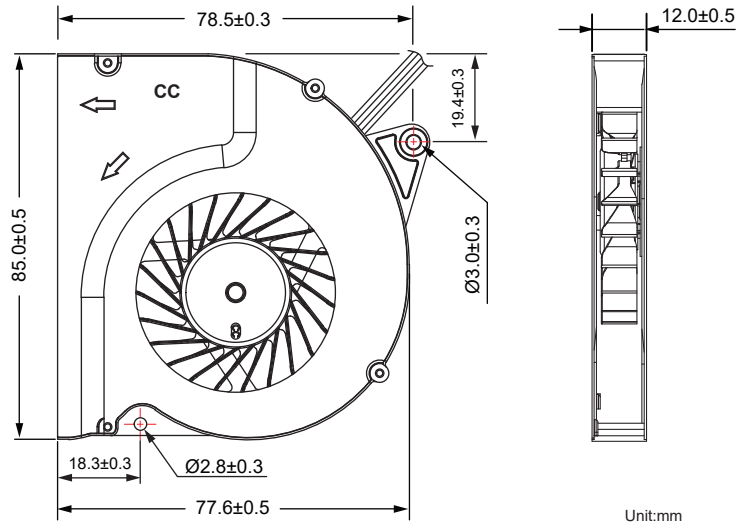
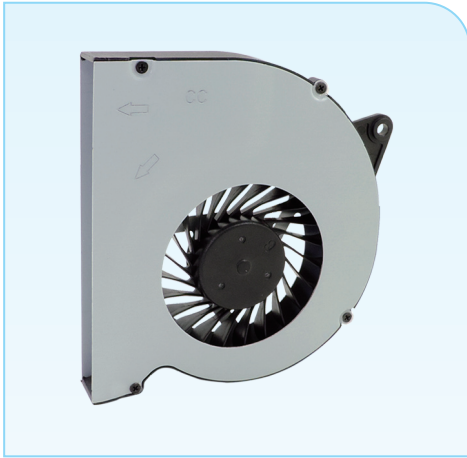

- * 轴承类型: 双滚珠, 液压轴承 (Bearing type: 2-Ball, Hydraulic)
- * 材料 (Material):
扇叶 (Impeller): PBT
框 (Frame): SECC
- * 引线 (Lead wire):
UL1571 AWG #26 or equivalent
红色线正级 Red Wire Positive (+)
黑色线负级 Black Wire Negative (-)
- * 可选择增加风扇功能 (Functions are optional)
- * 重量 (Weight): 53g

■ 风压&风量曲线图 P and Q CURVE

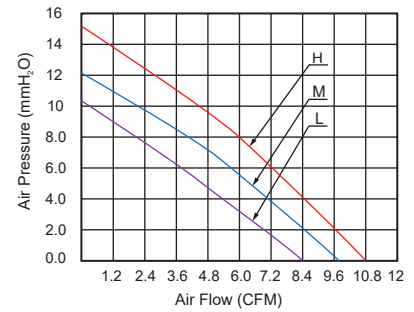

型号 Model	轴承类型 Bearing Type	电压 Rated Voltage	电压范围 Operation Voltage	电流 Current	功率 Input Power	转速 Speed	风量 Air Flow	风压 Static Pressure	噪音 Noise Level
		VDC	VDC	Amp	Watt	RPM	CFM	MM-H ₂ O	dBA
BF8512L05D	2-Ball	5V	4.5~5.5	0.14	0.70	2,500±10%	8.40	10.5	29.2
BF8512L05SH	Hydraulic								
BF8512M05D	2-Ball	5V	4.5~5.5	0.26	1.30	3,000±10%	9.80	12.1	30.6
BF8512M05SH	Hydraulic								
BF8512H05D	2-Ball	5V	4.5~5.5	0.38	1.90	3,500±10%	10.8	15.3	33.5
BF8512H05SH	Hydraulic								

- * 以上为额定电压下的常规参数 (All readings are typical values at rated voltage)
- * 规格如有变动不另行通知 (Specifications are subjected to change without prior notice)

DC Blower Fan 88x81.6x18.5mm

■ 尺寸图 (DIMENSION DRAWING)

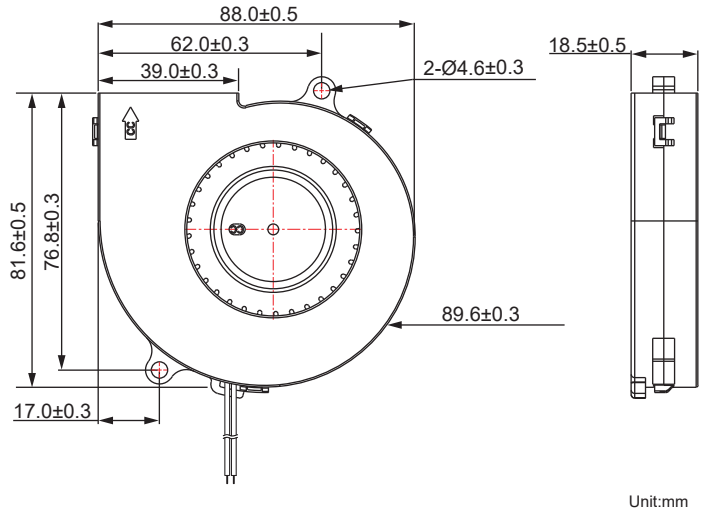
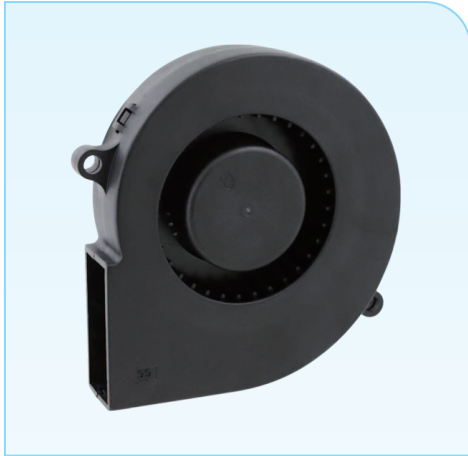

- * 轴承类型: 双滚珠轴承, 液压轴承
(Bearing type:2-Ball,Hydraulic)
- * 材料(Material):
框叶(Frame & Impeler):PBT
- * 引线(Lead wire):
UL2468 AWG #26 or equivalent
红色线正级 Red Wire Positive (+)
黑色线负级 Black Wire Negative (-)
- * 可选择增加风扇功能(Functions are optional)
- * 重量(Weight):67g

■ 风压&风量曲线图 P and Q CURVE

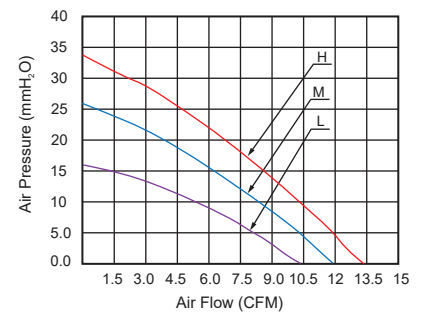

型号 Model	轴承类型 Bearing Type	电压 Rated Voltage	电压范围 Operation Voltage	电流 Current	功率 Input Power	转速 Speed	风量 Air Flow	风压 Static Pressure	噪音 Noise Level
		VDC	VDC	Amp	Watt	RPM	CFM	MM-H ₂ O	dBA
BF8818L12D	2-Ball	12V	10.8~13.2	0.27	3.24	3,000±10%	10.3	16.6	44.2
BF8818L12SH	Hydraulic								
BF8818M12D	2-Ball	12V	10.8~13.2	0.36	4.32	3,500±10%	12.0	26.0	47.3
BF8818M12SH	Hydraulic								
BF8818H12D	2-Ball	12V	10.8~13.2	0.40	4.80	3,800±10%	13.2	33.1	49.3
BF8818H12SH	Hydraulic								

- * 以上为额定电压下的常规参数(All readings are typical values at rated voltage)
- * 规格如有变动不另行通知(Specifications are subjected to change without prior notice)

DC Blower Fan 80x90x12mm

■ 尺寸图 (DIMENSION DRAWING)

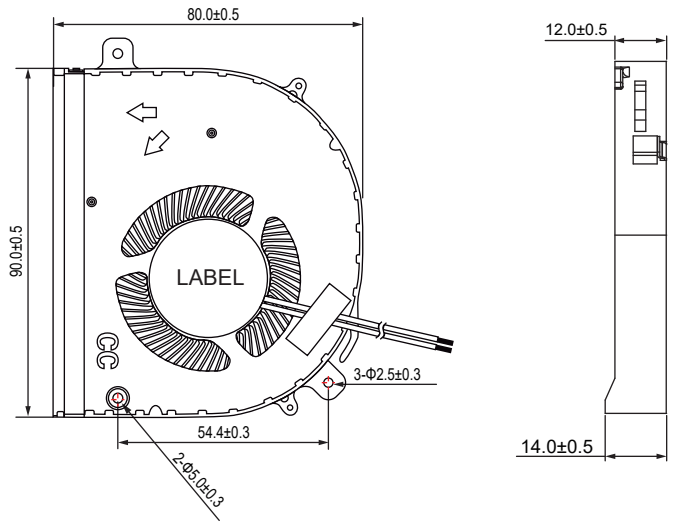

Unit:mm

- * 轴承类型: 流体动压 (Bearing type:FDB)
- * 材料(Material):
框叶(Frame & Impeller):PBT
- * 引线(Lead wire):
UL2468 AWG #28 or equivalent
红色线正级 Red Wire Positive (+)
黑色线负级 Black Wire Negative (-)
- * 可选择增加风扇功能(Functions are optional)
- * 重量(Weight):73g

■ 风压&风量曲线图 P and Q CURVE

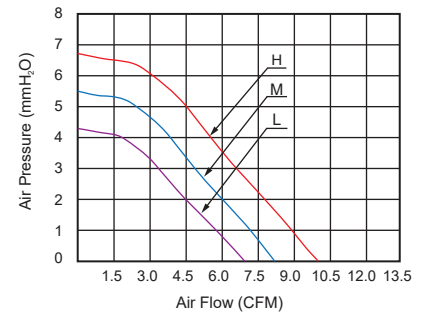

型号 Model	轴承类型 Bearing Type	电压 Rated Voltage	电压范围 Operation Voltage	电流 Current	功率 Input Power	转速 Speed	风量 Air Flow	风压 Static Pressure	噪音 Noise Level
		VDC	VDC	Amp	Watt	RPM	CFM	MM-H ₂ O	dBA
BF9012L05S3	FDB	5V	4.5~5.5	0.35	1.75	1,500±10%	6.80	4.20	18.0
BF9012M05S3	FDB	5V	4.5~5.5	0.48	2.40	2,000±10%	8.00	5.50	25.0
BF9012H05S3	FDB	5V	4.5~5.5	0.60	3.00	2,500±10%	10.0	6.80	30.0
BF9012L12S3	FDB	12V	7~13.2	0.16	1.92	1,500±10%	6.80	4.20	18.0
BF9012M12S3	FDB	12V	7~13.2	0.23	2.76	2,000±10%	8.00	5.50	25.0
BF9012H12S3	FDB	12V	7~13.2	0.32	3.84	2,500±10%	10.0	6.80	30.0
BF9012L24S3	FDB	24V	14~26.4	0.08	1.92	1,500±10%	6.80	4.20	18.0
BF9012M24S3	FDB	24V	14~26.4	0.12	2.88	2,000±10%	8.00	5.50	25.0
BF9012H24S3	FDB	24V	14~26.4	0.15	3.60	2,500±10%	10.0	6.80	30.0

- * 以上为额定电压下的常规参数(All readings are typical values at rated voltage)
- * 规格如有变动不另行通知(Specifications are subjected to change without prior notice)

DC Blower Fan 89x89x21.5mm

■ 尺寸图 (DIMENSION DRAWING)

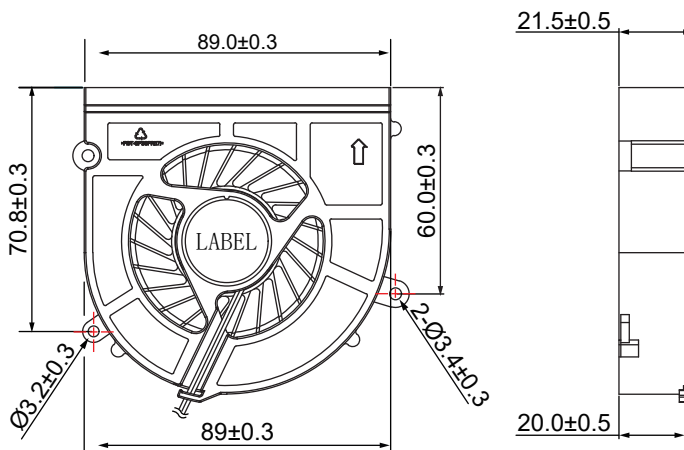

Unit:mm

■ 风压&风量曲线图 P and Q CURVE

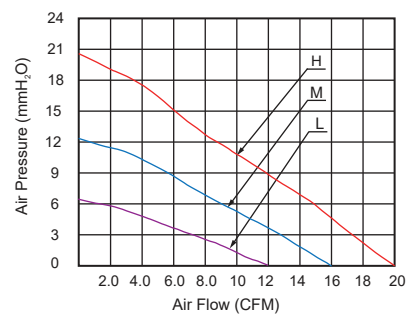

- * 轴承类型: 液压轴承, 双滚珠轴承 (Bearing type: Hydraulic, 2-Ball)
- * 材料 (Material):
扇叶 (Impeller): PBT
框 (Frame): PBT & Aluminium
- * 引线 (Lead wire):
UL2468 AWG #28 or equivalent
红色线正级 Red Wire Positive (+)
黑色线负级 Black Wire Negative (-)
- * 可选择增加风扇功能 (Functions are optional)
- * 重量 (Weight): 78g

型号 Model	轴承类型 Bearing Type	版本 Version	电压 Rated Voltage	电流 Current	功率 Input Power	转速 Speed	风量 Air Flow	风压 Static Pressure	噪音 Noise Level
			VDC	Amp	Watt	RPM	CFM	MM-H ₂ O	dBA
BF9020L12SH	Hydraulic	-A	12V	0.23	2.76	2,200±10%	12.00	6.50	28.0
BF9020L12D	2-Ball								
BF9020M12SH	Hydraulic	-A	12V	0.30	3.60	2,800±10%	16.00	12.30	35.0
BF9020M12D	2-Ball								
BF9020H12SH	Hydraulic	-A	12V	0.70	8.40	3,500±10%	20.00	20.30	42.0
BF9020H12D	2-Ball								
BF9020L24SH	Hydraulic	-A	24V	0.10	2.40	2,200±10%	12.00	6.50	28.0
BF9020L24D	2-Ball								
BF9020M24SH	Hydraulic	-A	24V	0.16	3.84	2,800±10%	16.00	12.30	35.0
BF9020M24D	2-Ball								
BF9020H24SH	Hydraulic	-A	24V	0.25	6.00	3,500±10%	20.00	20.30	42.0
BF9020H24D	2-Ball								

- * 以上为额定电压下的常规参数 (All readings are typical values at rated voltage)
- * 规格如有变动不另行通知 (Specifications are subjected to change without prior notice)

DC Blower Fan 90x90x20mm

■ 尺寸图 (DIMENSION DRAWING)

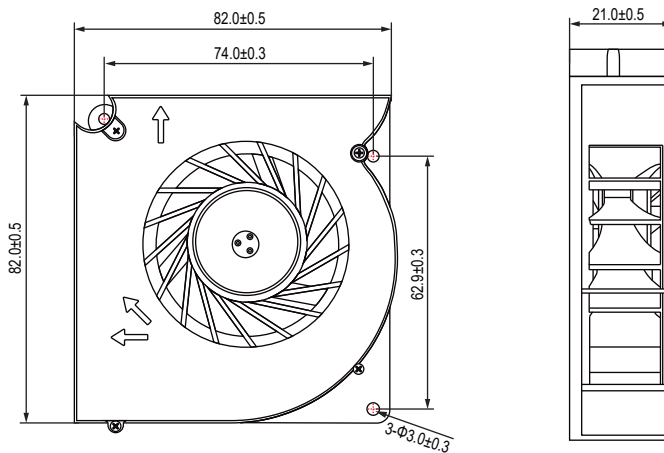

Unit:mm

- * 轴承类型: 含油轴承, 双滚珠轴承 (Bearing type:Sleeve,2-Ball)
- * 材料(Material):
扇叶(Impeller):PBT
框(Frame):PBT & Aluminium
- * 引线(Lead wire):
UL2468 AWG #28 or equivalent
红色线正级 Red Wire Positive (+)
黑色线负级 Black Wire Negative (-)
- * 可选择增加风扇功能(Functions are optional)
- * 重量(Weight):84g

■ 风压&风量曲线图 P and Q CURVE

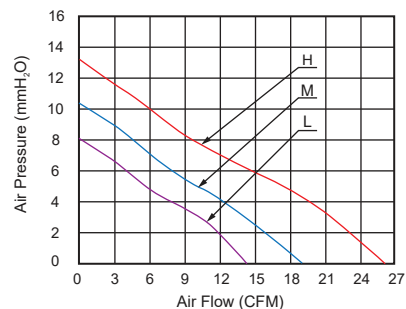

型号 Model	轴承类型 Bearing Type	版本 Version	电压 Rated Voltage	电流 Current	功率 Input Power	转速 Speed	风量 Air Flow	风压 Static Pressure	噪音 Noise Level
			VDC	Amp	Watt	RPM	CFM	MM-H ₂ O	dBA
BF9020L05S	Sleeve	-B	5V	0.36	1.80	2,000±10%	14.00	8.00	29.0
BF9020L05D	2-Ball								
BF9020M05S	Sleeve	-B	5V	0.43	2.15	2,600±10%	19.00	10.50	33.0
BF9020M05D	2-Ball								
BF9020H05S	Sleeve	-B	5V	0.50	2.50	3,300±10%	26.00	13.00	37.0
BF9020H05D	2-Ball								
BF9020L12S	Sleeve	-B	12V	0.12	1.44	2,000±10%	14.00	8.00	29.0
BF9020L12D	2-Ball								
BF9020M12S	Sleeve	-B	12V	0.17	2.04	2,600±10%	19.00	10.50	33.0
BF9020M12D	2-Ball								
BF9020H12S	Sleeve	-B	12V	0.22	2.64	3,300±10%	26.00	13.00	37.0
BF9020H12D	2-Ball								

- * 以上为额定电压下的常规参数(All readings are typical values at rated voltage)
- * 规格如有变动不另行通知(Specifications are subjected to change without prior notice)

DC Blower Fan 93x93x30mm

■ 尺寸图 (DIMENSION DRAWING)

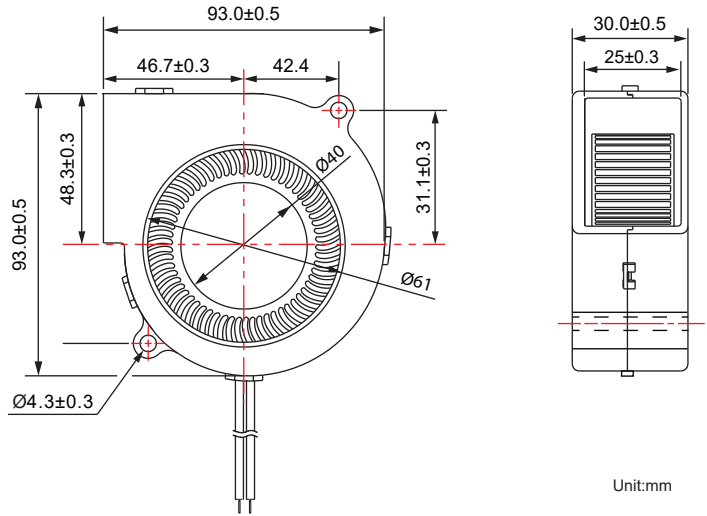

- * 轴承类型: 含油轴承, 双滚珠轴承 (Bearing type:Sleeve,2-Ball)
- * 材料(Material):
框叶(Frame & Impeller):PBT
- * 引线(Lead wire):
UL2468 AWG #26 or equivalent
红色线正级 Red Wire Positive (+)
黑色线负级 Black Wire Negative (-)
- * 可选择增加风扇功能(Functions are optional)
- * 重量(Weight):130g

■ 风压&风量曲线图 P and Q CURVE

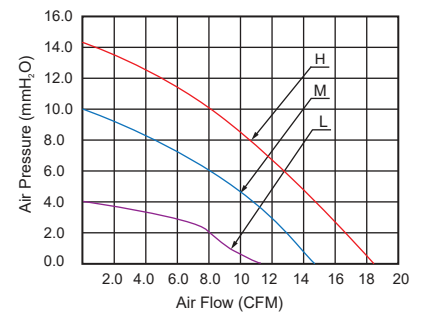

型号 Model	轴承类型 Bearing Type	版本 Version	电压 Rated Voltage	电流 Current	功率 Input Power	转速 Speed	风量 Air Flow	风压 Static Pressure	噪音 Noise Level
			VDC	Amp	Watt	RPM	CFM	MM-H ₂ O	dBA
BF9330L12S	Sleeve	-A	12V	0.10	1.20	2,000±10%	10.9	4.00	34.0
BF9330L12D	2-Ball								
BF9330M12S	Sleeve	-A	12V	0.17	2.04	2,500±10%	14.5	10.0	38.0
BF9330M12D	2-Ball								
BF9330H12S	Sleeve	-A	12V	0.25	3.00	3,000±10%	18.1	14.1	42.0
BF9330H12D	2-Ball								
BF9330L24S	Sleeve	-A	24V	0.08	1.92	2,000±10%	10.9	4.00	34.0
BF9330L24D	2-Ball								
BF9330M24S	Sleeve	-A	24V	0.13	3.12	2,500±10%	14.5	10.0	38.0
BF9330M24D	2-Ball								
BF9330H24S	Sleeve	-A	24V	0.18	4.32	3,000±10%	18.1	14.1	42.0
BF9330H24D	2-Ball								

- * 以上为额定电压下的常规参数(All readings are typical values at rated voltage)
- * 规格如有变动不另行通知(Specifications are subjected to change without prior notice)

DC Blower Fan 92.8x92.4x30mm

■ 尺寸图 (DIMENSION DRAWING)

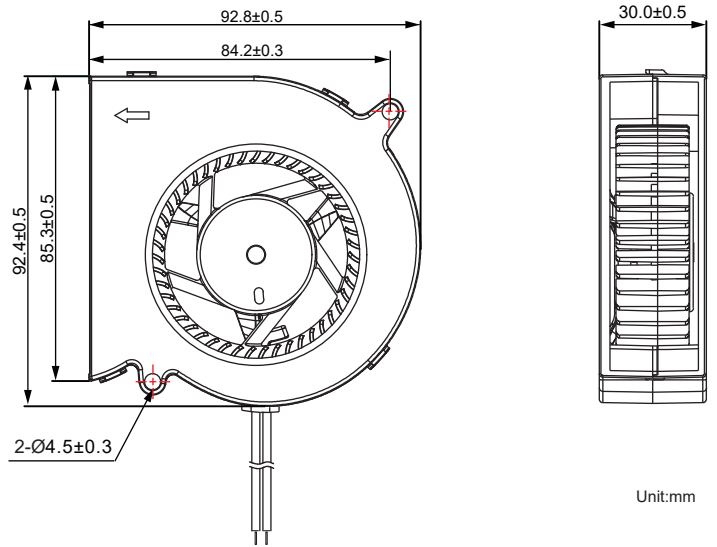

- * 轴承类型: 含油轴承, 双滚珠轴承 (Bearing type:Sleeve,2-Ball)
- * 材料(Material):
框叶(Frame & Impeler):PBT
- * 引线(Lead wire):
UL2468 AWG #26 or equivalent
红色线正级 Red Wire Positive (+)
黑色线负级 Black Wire Negative (-)
- * 可选择增加风扇功能(Functions are optional)
- * 重量(Weight):110g

■ 风压&风量曲线图 P and Q CURVE

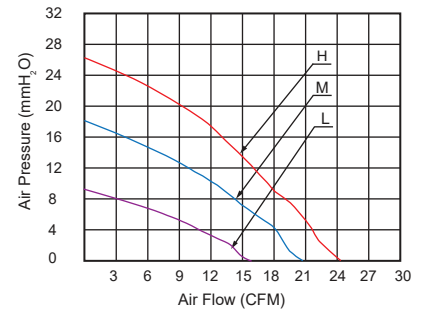

型号 Model	轴承类型 Bearing Type	版本 Version	电压 Rated Voltage	电流 Current	功率 Input Power	转速 Speed	风量 Air Flow	风压 Static Pressure	噪音 Noise Level
			VDC	Amp	Watt	RPM	CFM	MM-H ₂ O	dBA
BF9330L12S	Sleeve	-B	12V	0.17	2.04	2,000±10%	15.8	9.50	32.0
BF9330L12D	2-Ball								
BF9330M12S	Sleeve	-B	12V	0.23	2.76	2,500±10%	20.4	18.4	38.8
BF9330M12D	2-Ball								
BF9330H12S	Sleeve	-B	12V	0.69	8.28	3,000±10%	24.3	26.6	43.5
BF9330H12D	2-Ball								
BF9330L24S	Sleeve	-B	24V	0.10	2.40	2,000±10%	15.8	9.50	32.0
BF9330L24D	2-Ball								
BF9330M24S	Sleeve	-B	24V	0.15	3.60	2,500±10%	20.4	18.4	38.8
BF9330M24D	2-Ball								
BF9330H24S	Sleeve	-B	24V	0.35	8.40	3,000±10%	24.3	26.6	43.5
BF9330H24D	2-Ball								

- * 以上为额定电压下的常规参数(All readings are typical values at rated voltage)
- * 规格如有变动不另行通知(Specifications are subjected to change without prior notice)

DC Blower Fan 97x95x33mm

■ 尺寸图 (DIMENSION DRAWING)

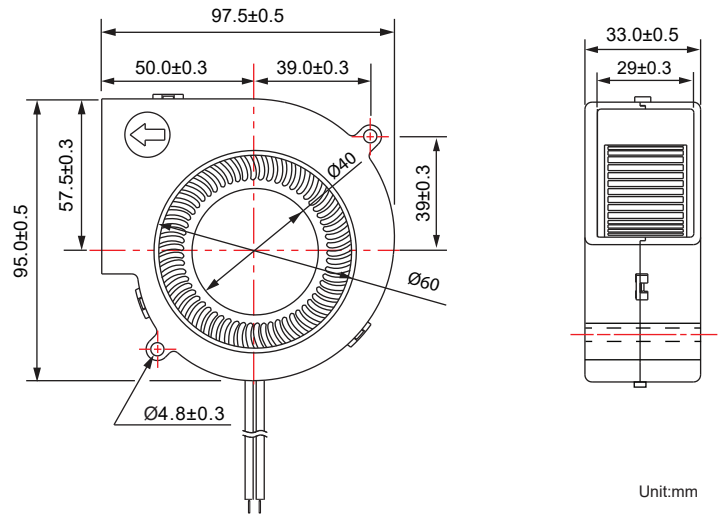

- * 轴承类型: 含油轴承, 双滚珠轴承 (Bearing type: Sleeve, 2-Ball)
- * 材料(Material):
框叶(Frame & Impeller): PBT
- * 引线(Lead wire):
UL2468 AWG #26 or equivalent
红色线正级 Red Wire Positive (+)
黑色线负级 Black Wire Negative (-)
- * 可选择增加风扇功能(Functions are optional)
- * 重量(Weight): 150g

■ 风压&风量曲线图 P and Q CURVE

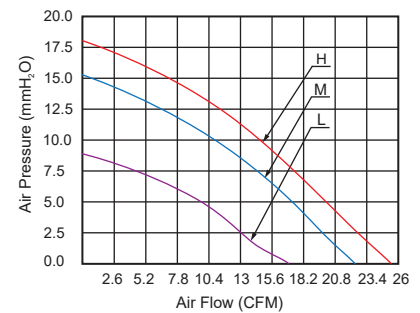

型号 Model	轴承类型 Bearing Type	电压 Rated Voltage	电压范围 Operation Voltage	电流 Current	功率 Input Power	转速 Speed	风量 Air Flow	风压 Static Pressure	噪音 Noise Level
		VDC	VDC	Amp	Watt	RPM	CFM	MM-H ₂ O	dBA
BF9733L12S	Sleeve	12V	10.8~13.2	0.21	2.52	2,500±10%	16.3	8.70	45.0
BF9733L12D	2-Ball								
BF9733M12S	Sleeve	12V	10.8~13.2	0.29	3.48	3,000±10%	22.3	15.1	49.0
BF9733M12D	2-Ball								
BF9733H12S	Sleeve	12V	10.8~13.2	0.42	5.04	3,500±10%	25.3	18.0	53.0
BF9733H12D	2-Ball								
BF9733L24S	Sleeve	24V	21.6~26.4	0.10	2.40	2,500±10%	16.3	8.70	45.0
BF9733L24D	2-Ball								
BF9733M24S	Sleeve	24V	21.6~26.4	0.14	3.36	3,000±10%	22.3	15.1	49.0
BF9733M24D	2-Ball								
BF9733H24S	Sleeve	24V	21.6~26.4	0.28	6.72	3,500±10%	25.3	18.0	53.0
BF9733H24D	2-Ball								

- * 以上为额定电压下的常规参数(All readings are typical values at rated voltage)
- * 规格如有变动不另行通知(Specifications are subjected to change without prior notice)

DC Blower Fan 100x100x33mm

■ 尺寸图 (DIMENSION DRAWING)

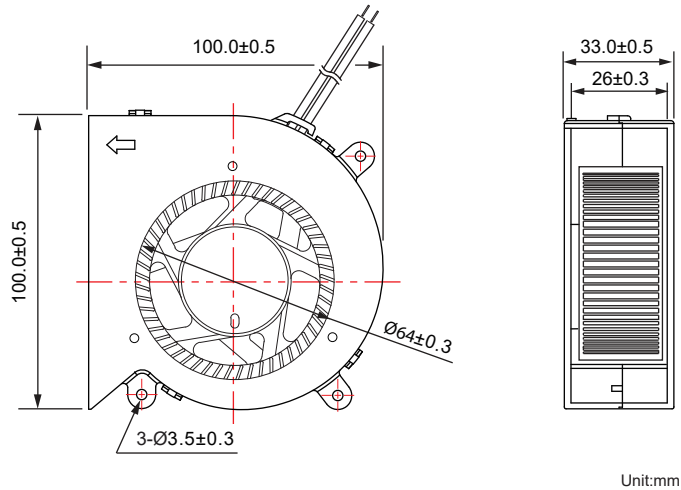

Unit:mm

- * 轴承类型: 含油轴承, 双滚珠轴承 (Bearing type:Sleeve,2-Ball)
- * 材料(Material):
框叶(Frame & Impeler):PBT
- * 引线(Lead wire):
UL2468 AWG #26 or equivalent
红色线正级 Red Wire Positive (+)
黑色线负级 Black Wire Negative (-)
- * 可选择增加风扇功能(Functions are optional)
- * 重量(Weight):139g

■ 风压&风量曲线图 P and Q CURVE

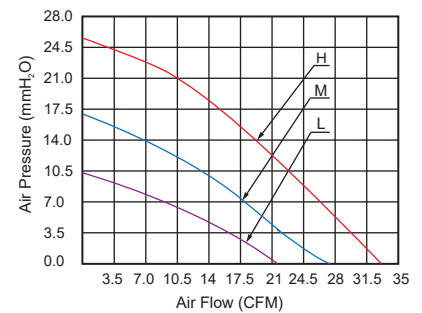

型号 Model	轴承类型 Bearing Type	电压 Rated Voltage	电压范围 Operation Voltage	电流 Current	功率 Input Power	转速 Speed	风量 Air Flow	风压 Static Pressure	噪音 Noise Level
		VDC	VDC	Amp	Watt	RPM	CFM	MM-H ₂ O	dBA
BF10033L12S	Sleeve	12V	10.8~13.2	0.17	2.04	2,000±10%	21.8	10.0	35.0
BF10033L12D	2-Ball								
BF10033M12S	Sleeve	12V	10.8~13.2	0.40	4.80	2,500±10%	27.4	16.5	40.0
BF10033M12D	2-Ball								
BF10033H12S	Sleeve	12V	10.8~13.2	0.50	6.00	3,000±10%	33.2	25.6	45.0
BF10033H12D	2-Ball								

- * 以上为额定电压下的常规参数(All readings are typical values at rated voltage)
- * 规格如有变动不另行通知(Specifications are subjected to change without prior notice)

DC Blower Fan 93x93x30mm

■ 尺寸图 (DIMENSION DRAWING)

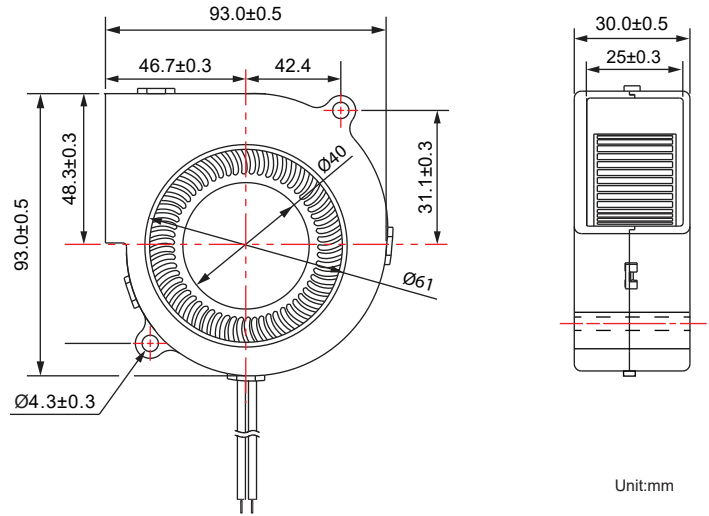
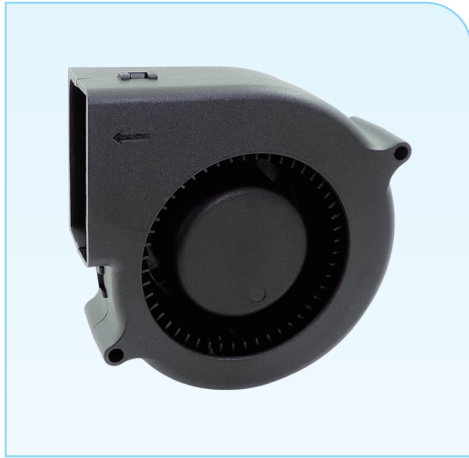

- * 轴承类型: 含油轴承, 双滚珠轴承 (Bearing type:Sleeve,2-Ball)
- * 材料(Material):
框叶(Frame & Impeller):PBT
- * 引线(Lead wire):
UL2468 AWG #26 or equivalent
红色线正级 Red Wire Positive (+)
黑色线负级 Black Wire Negative (-)
- * 可选择增加风扇功能(Functions are optional)
- * 重量(Weight):130g

■ 风压&风量曲线图 P and Q CURVE

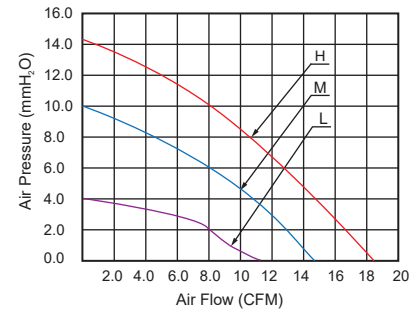

型号 Model	轴承类型 Bearing Type	电压 Rated Voltage	电压范围 Operation Voltage	电流 Current	功率 Input Power	转速 Speed	风量 Air Flow	风压 Static Pressure	噪音 Noise Level
		VDC	VDC	Amp	Watt	RPM	CFM	MM-H ₂ O	dBA
BF9330L12S	Sleeve	12V	10.8~13.2	0.10	1.20	2,000±10%	10.9	4.00	34.0
BF9330L12D	2-Ball								
BF9330M12S	Sleeve	12V	10.8~13.2	0.17	2.04	2,500±10%	14.5	10.0	38.0
BF9330M12D	2-Ball								
BF9330H12S	Sleeve	12V	10.8~13.2	0.25	3.00	3,000±10%	18.1	14.1	42.0
BF9330H12D	2-Ball								
BF9330L24S	Sleeve	24V	21.6~26.4	0.08	1.92	2,000±10%	10.9	4.00	34.0
BF9330L24D	2-Ball								
BF9330M24S	Sleeve	24V	21.6~26.4	0.13	3.12	2,500±10%	14.5	10.0	38.0
BF9330M24D	2-Ball								
BF9330H24S	Sleeve	24V	21.6~26.4	0.18	4.32	3,000±10%	18.1	14.1	42.0
BF9330H24D	2-Ball								

- * 以上为额定电压下的常规参数(All readings are typical values at rated voltage)
- * 规格如有变动不另行通知(Specifications are subjected to change without prior notice)